

BENCH MARK #9
 TOP HYD. FRONT HOUSE No.8337
 STA. 69+56.30, 27.0' LT.
 ELEV. 623.47

BM9

FOR TYPICAL SECTIONS SEE SHEETS 5 THRU 6
 FOR CROSS-SECTIONS SEE SHEETS 48 THRU 79
 FOR DRIVEWAY SCHEDULE & DETAILS SEE SHEETS 21 THRU 22
 FOR PAVEMENT DETAILS SEE SHEET 171
 FOR TRAFFIC CONTROL DETAILS SEE SHEETS 172 THRU 198

RESURFACING PROGRAM	CU.YD.	SQ.YD.	CU.YD.	SQ.YD.	CU.YD.	SQ.YD.	CU.YD.	SQ.YD.
1-1/4" ASPH. CONC. SURFACE COURSE, TYPE 1, PG84-22								
1/2" A.C. ASPH. CONC. INTERMEDIATE COURSE, TYPE 2, PG84-22								
TACK COAT (0.10 GAL./SQ.YD.)								
PAVEMENT PLANING, BITUMINOUS								
1-1/4" ASPH. CONC. SURFACE COURSE, TYPE 1, PG84-22								
BITUMINOUS PRIME COAT (0.40 GAL./SQ.YD.)								
TACK COAT (0.10 GAL./SQ.YD.)								
6" AGGREGATE BASE, AS PER PLAN								
6" BITUMINOUS AGGREGATE BASE, PG84-22								
8 3/4" BITUMINOUS AGGREGATE BASE, PG84-22								
SUBGRADE COMPACTION								
EXCAVATION NOT INCLUDING EMBANKMENT CONSTRUCTION								
TOTALS								

PAVEMENT LOCATION	REF	LOCATION	LINEAL FT.	TOTALS
P-1	STA. 68+00 TO 72+00, LT. = 2400 S.F.			
P-2	STA. 68+00 TO 72+00, RT. = 2400 S.F.			
P-3	STA. 68+00 TO 72+00, RT. = 8800 S.F.			
TOTALS				

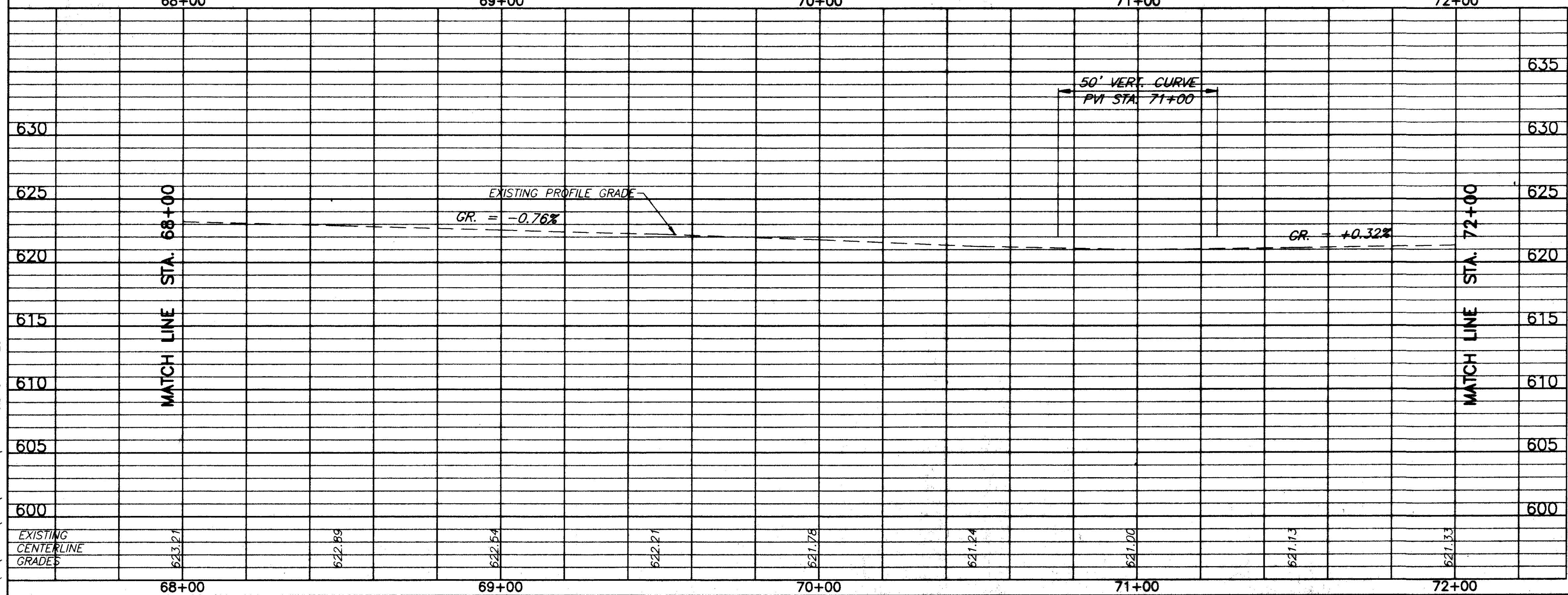

ROADWAY		
REF	LOCATION	LINEAL FT.
R-1	STA. 69+29 LT. TO STA. 69+49 LT.	20
TOTALS		20

DRAINAGE & SANITARY		
REF	LOCATION	EACH
S-1	STA. 70+50, 15' RT.	1
TOTALS		1

H:\CT\192535\CAD\MUNSON\MUNPP16.DWG 1"=20'

MUNSON ROAD PLAN & PROFILE STA. 68+00 TO STA. 72+00