

MUNSON ROAD (S. R. 615)

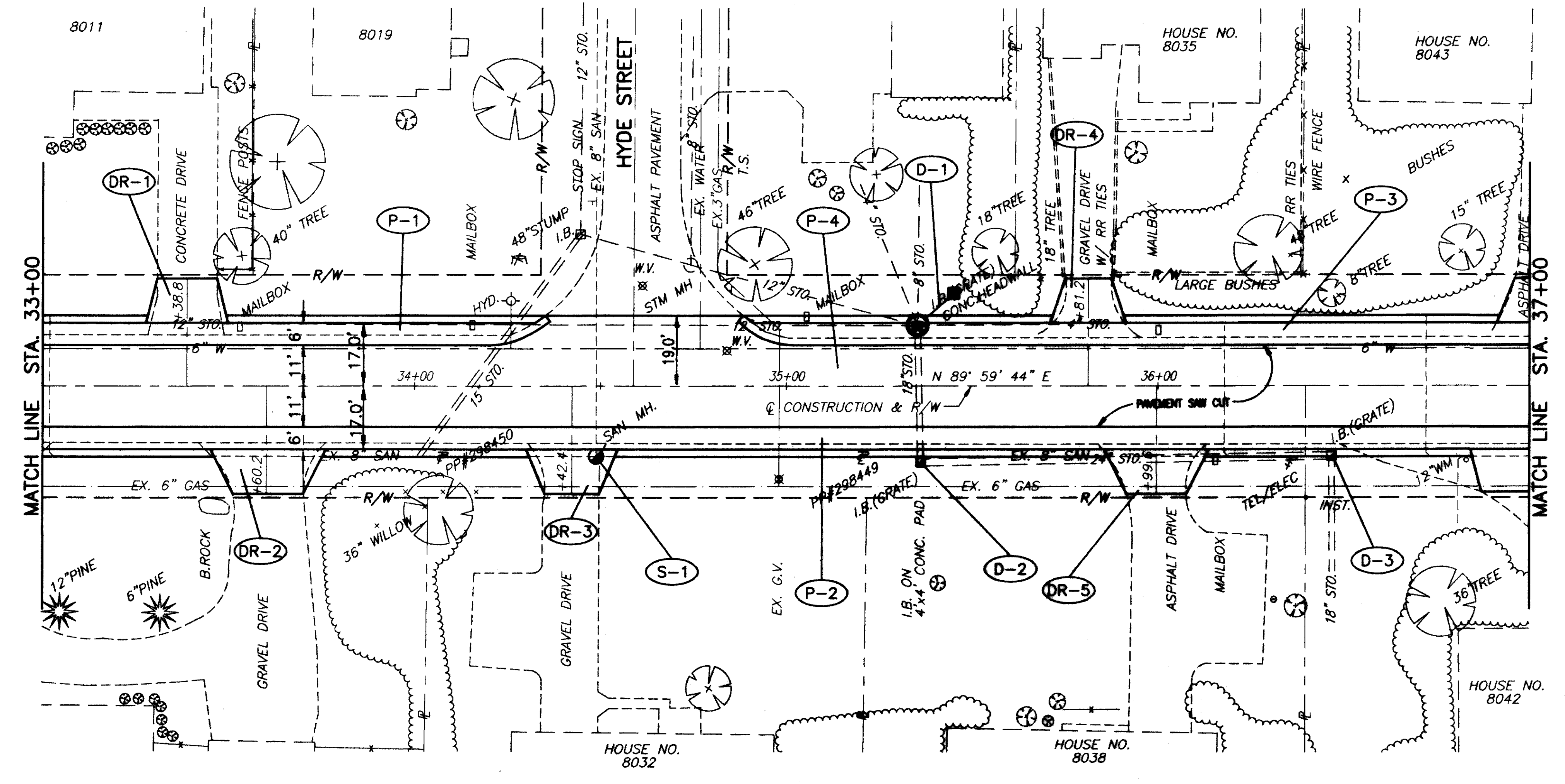

FOR TYPICAL SECTIONS SEE SHEETS 5 THRU 6
 FOR CROSS-SECTIONS SEE SHEETS 48 THRU 79
 FOR DRIVEWAY SCHEDULE & DETAILS SEE SHEETS 21 THRU 22
 FOR PAVEMENT DETAILS SEE SHEET 171
 FOR TRAFFIC CONTROL DETAILS SEE SHEETS 172 THRU 198

RESURFACING PROGRAM	STA.	DESCRIPTION	UNIT	QTY.	UNIT PRICE	TOTAL
448	448	1-1/4" ASPH. CONC. SURFACE COURSE, TYPE 1, PG84-22	CU.YD.			35.8
448	448	1/2" AVG. ASPH. CONC. INTERMEDIATE COURSE, TYPE 2, PG84-22	CU.YD.			14.3
254	407	TACK COAT (0.10 GAL./SQ.YD.)	GAL.	1030	103.0	103.0
		PAVEMENT PLANNING, BITUMINOUS	SQ.YD.	1030	103.0	103.0
448	448	1-1/4" ASPH. CONC. SURFACE COURSE, TYPE 1, PG84-22	CU.YD.			17.1
448	448	BITUMINOUS PRIME COAT (0.40 GAL./SQ.YD.)	GAL.	34.8	34.8	34.8
407	407	TACK COAT (0.10 GAL./SQ.YD.)	GAL.	8.7	8.7	8.7
304	304	6" AGGREGATE BASE, AS PER PLAN	CU.YD.	14.4	14.4	14.4
301	301	6" BITUMINOUS AGGREGATE BASE, PG84-22	CU.YD.	4.2	4.2	4.2
301	301	8 3/4" BITUMINOUS AGGREGATE BASE, PG84-22	CU.YD.	21.1	21.1	21.1
203	203	SUBGRADE COMPACTION	SQ.YD.	66.7	66.7	66.7
203	203	EXCAVATION NOT INCLUDING EMBANKMENT CONSTRUCTION	CU.YD.	42.7	42.7	42.7
			TOTALS	240.8	473.4	118.4

REF	LOCATION	PAVEMENT
P-1	STA. 33+00 TO 34+50, LT. = 760 S.F.	
P-2	STA. 33+00 TO 37+00, RT. = 2400 S.F.	
P-3	STA. 34+87 TO 37+00, LT. = 1242 S.F.	
P-4	STA. 33+00 TO 37+00, LT. & RT. = 9272 S.F.	
TOTALS		

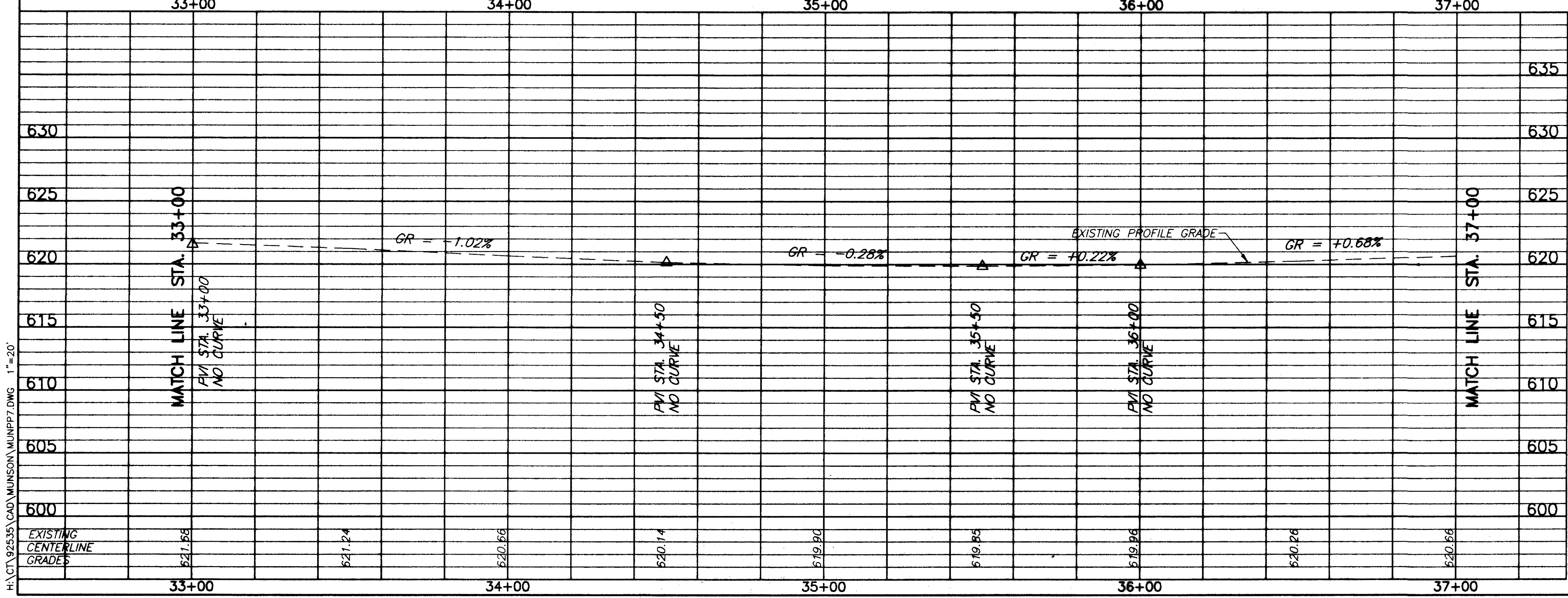

DRAINAGE & SANITARY					
REF	LOCATION	LN.FT.	EACH	EACH	EACH
D-1	STA. 35+35.3, 16.2' LT. TO STA. 35+45, 25' LT.	12	1	1	
D-2	STA. 35+36, 20' RT.				1
D-3	STA. 36+47, 19' RT.				1
S-1	STA. 34+49, 19' RT.				1
TOTALS		12	1	1	2

MUNSON ROAD PLAN & PROFILE STA. 33+00 TO STA. 37+00

H:\CT\92535\CAD\MUNSON.MUNPP7.DWG 1"=20'