

FOR TYPICAL SECTIONS SEE SHEETS 5 THRU 6
 FOR CROSS-SECTIONS SEE SHEETS 48 THRU 79
 FOR DRIVEWAY SCHEDULE & DETAILS SEE SHEETS 21 THRU 22
 FOR PAVEMENT DETAILS SEE SHEET 171
 FOR TRAFFIC CONTROL DETAILS SEE SHEETS 172 THRU 198

RESURFACING PROGRAM	STA.	TYPE	QTY	UNIT	AMOUNT	UNIT PRICE	TOTAL
1-1/4" ASPH. CONC. SURFACE COURSE, TYPE 1, PG64-22	448			CU.YD.			36.0
1/2" AVG. ASPH. CONC. INTERMEDIATE COURSE, TYPE 2, PG64-22	448			CU.YD.			14.4
TACK COAT (0.10 GAL./SQ.YD.)	407			GAL.			103.8
PAVEMENT PLANING, BITUMINOUS	254			SQ.YD.			1038
1-1/4" ASPH. CONC. SURFACE COURSE, TYPE 1, PG64-22	448			CU.YD.			17.0
BITUMINOUS PRIME COAT (0.40 GAL./SQ.YD.)	408			GAL.			52.8
TACK COAT (0.10 GAL./SQ.YD.)	407			GAL.			13.2
6" AGGREGATE BASE, AS PER PLAN	304			CU.YD.			81.4
6" BITUMINOUS AGGREGATE BASE, PG64-22	301			CU.YD.			11.1
8 3/4" BITUMINOUS AGGREGATE BASE, PG64-22	301			CU.YD.			4.4
SUBGRADE COMPACTION	203			SQ.YD.			118.8
EXCAVATION NOT INCLUDING EMBANKMENT CONSTRUCTION	203			CU.YD.			231.2
TOTALS							1188.8

REF.	LOCATION	QTY	UNIT PRICE	TOTAL
P-1	STA. 29+00 TO 33+00, LT. = 2400 S.F.	128.6	286.7	36848.42
P-2	STA. 29+00 TO 30+41, RT. = 610 S.F.	42.9	960.0	41088.00
P-3	STA. 30+95 TO 33+00, RT. = 1188 S.F.	58.7	1320.0	77496.00
P-4	STA. 29+00 TO 33+00, LT. & RT. = 9342 S.F.	231.2	486.7	112488.00
TOTALS				231120.42

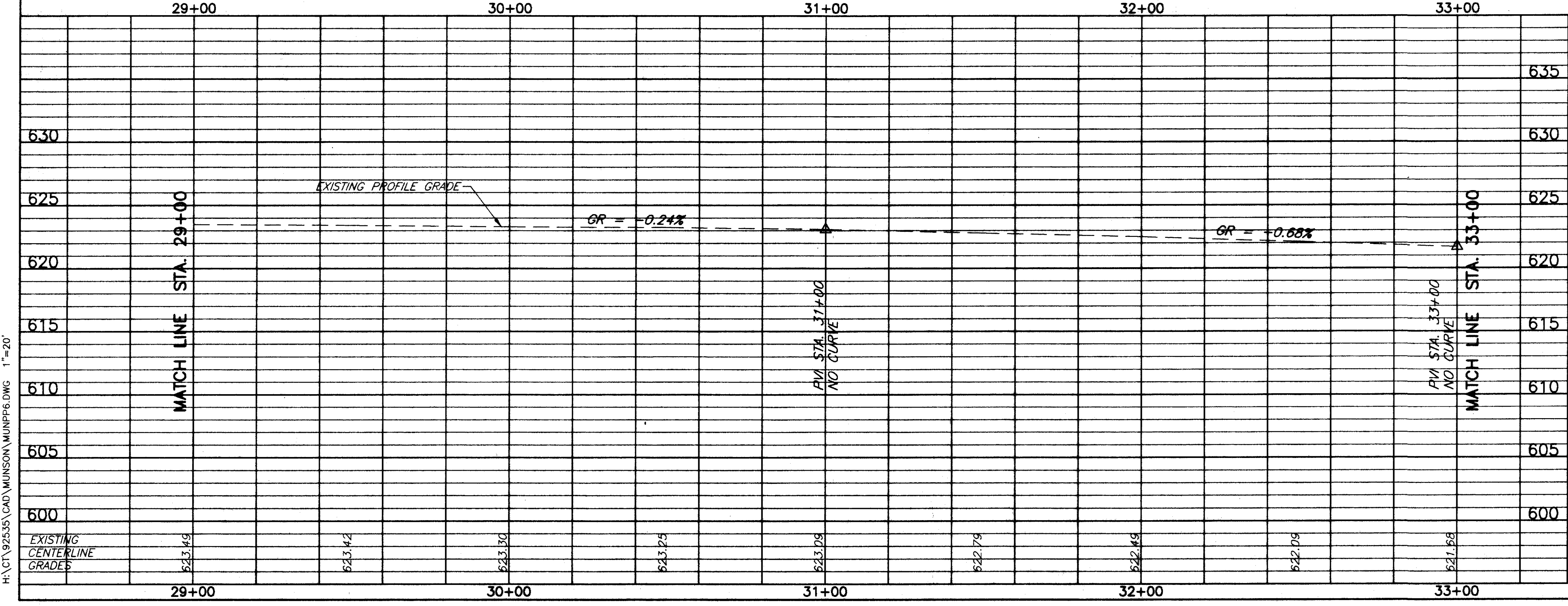

DRAINAGE & SANITARY		INLET ADJUSTED TO GRADE AS PER PLAN
REF.	LOCATION	EACH
D-1	STA. 32+70 LT.	1
TOTALS		1

MUNSON ROAD PLAN & PROFILE STA. 29+00 TO STA. 33+00