

# HENDRICKS ROAD MAINTENANCE OF TRAFFIC DETAIL

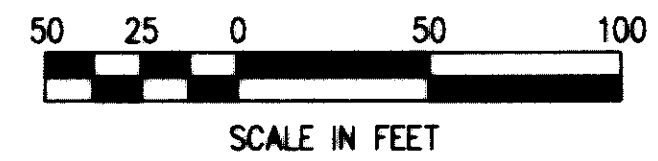

CONSTRUCTION AREA  
 TEMPORARY PAVEMENT

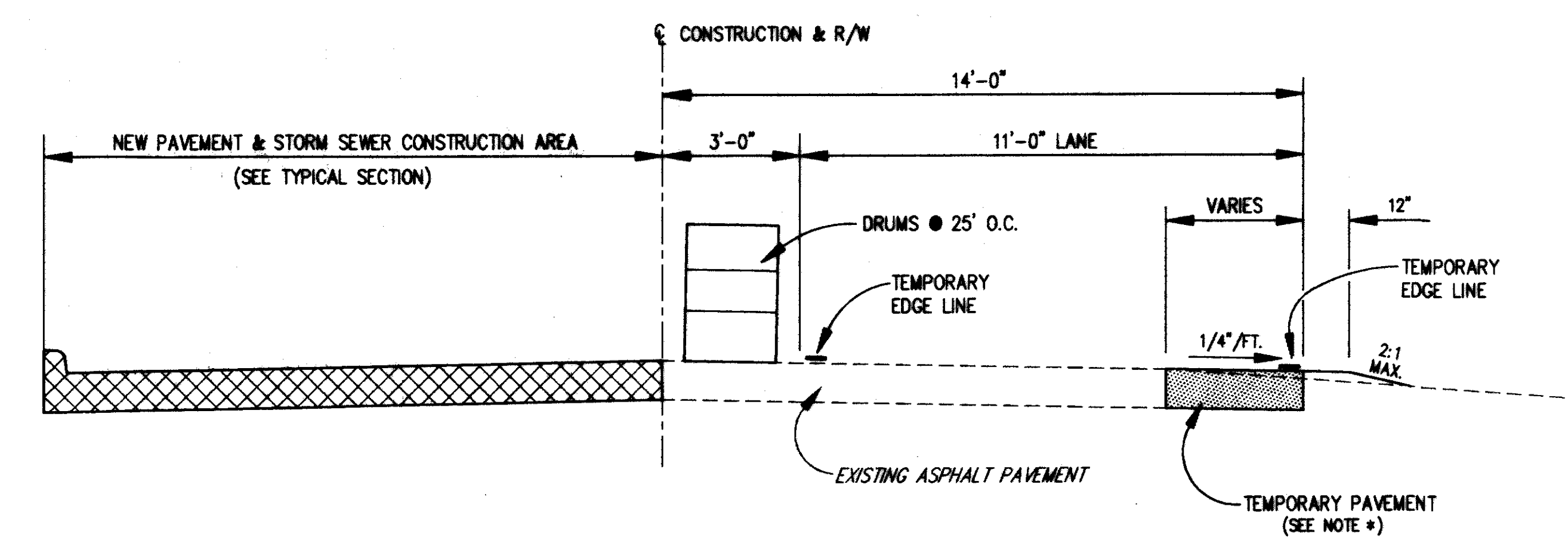
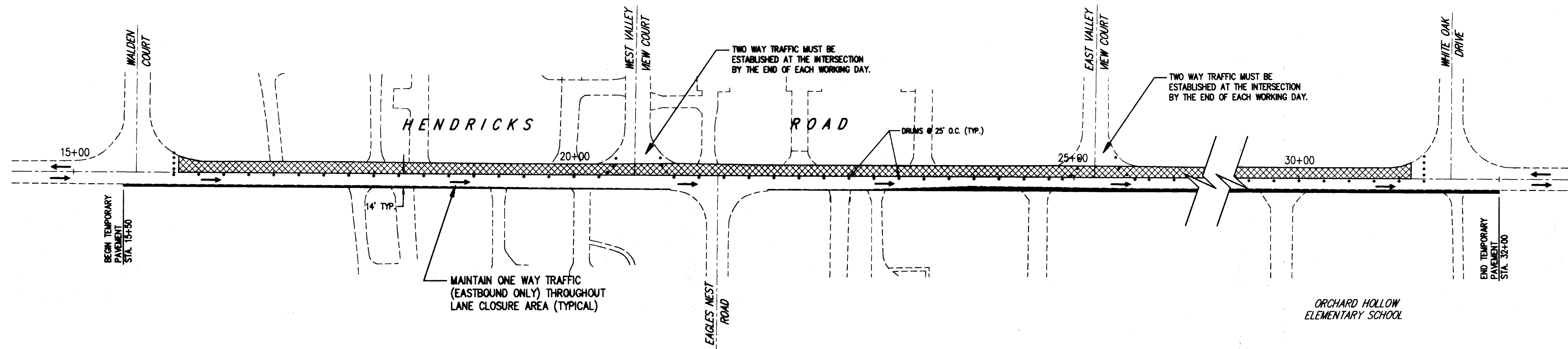

ESTIMATED QUANTITIES	
STATION TO STATION	LIN. FT.
STA. 15+50 TO STA. 32+00	3300
TOTALS	3300 = 0.63MI

QUANTITIES CARRIED TO GENERAL SUMMARY SHEET 29

NOTE: QUANTITIES FOR TEMPORARY PAVEMENT HAVE BEEN INCLUDED UNDER THE ITEM 614 - MAINTAINING TRAFFIC GENERAL NOTE SHOWN ON SHEET 16.

\* NOTE: TEMPORARY PAVEMENT SHALL REMAIN IN PLACE AFTER COMPLETION OF THE PROPOSED STORM SEWER CONSTRUCTION AND HENDRICKS ROAD IS REOPENED TO TWO-WAY TRAFFIC.

H:\ST\925357\CAD\HENDRICKS\HENDRICKS.DWG PLOT: 1"-50'