

-65 -60 -55 -50 -45 -40 -35 -30 -25 -20 -15 -10 -5 0 5 10 15 20 25 30 35 40 45 50 55 60

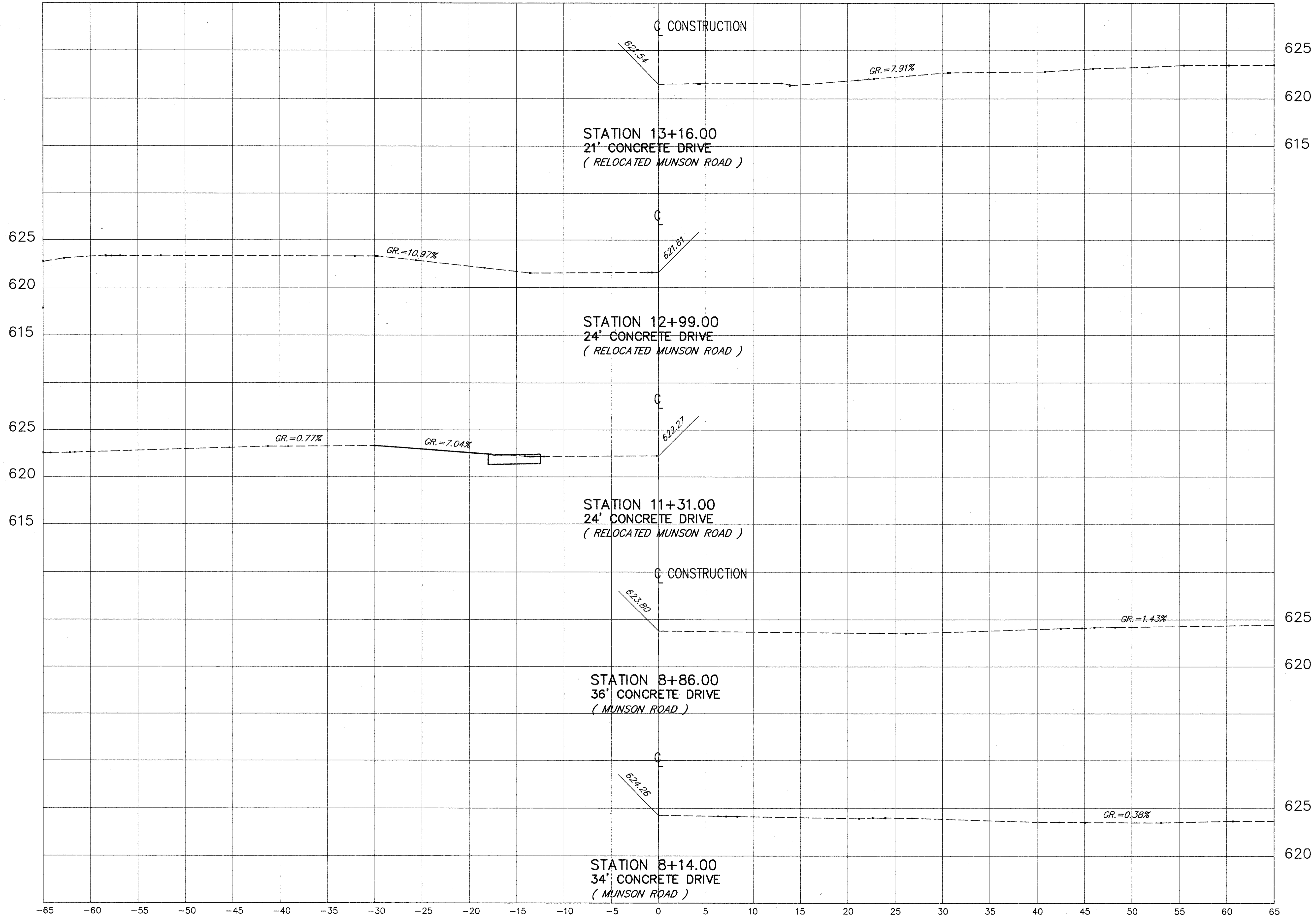

SUBMISSIONS / REVISIONS	

**CENTER STREET (STATE ROUTE 615)
ROADWAY IMPROVEMENTS**

**CENTER STREET
DRIVE PROFILES**

STA. 8+14 (MUNSON RD.) TO STA. 13+16 (REL. MUNSON RD.)

CT Consultants, Inc.
Engineers • Architects • Planners
Willoughby • Mentor • Columbus • North Canton • Youngstown

DATE:	APRIL 1999
DRAWN BY:	J.J.C.
CHECKED BY:	C.C.H.
APPROVED BY:	
SCALE:	
HOR:	1" = 5'
VERT:	1" = 5'
CONTRACT No.	
98387	
SHEET NO.	OF
74	103

COPYRIGHT - DATE: 04-05-99 10:48, CT CONSULTANTS INC. H: 1998/08/27/S00X/UNREPRODUCIBLE PLOT: 1-5