



SUBMISSIONS / REVISIONS

CENTER STREET (STATE ROUTE 615)  
ROADWAY IMPROVEMENTS  
CENTER STREET  
CROSS-SECTIONS  
STA. 213+50 TO STA. 215+00

**CT Consultants, Inc.**  
Engineers • Architects • Planners  
Willoughby • Mentor • Columbus • North Canton • Youngstown

DATE: DECEMBER, 1998

DRAWN BY: J.J.C.

CHECKED BY: C.C.H.

APPROVED BY:

SCALE:  
HOR. 1" = 5'  
VERT. 1" = 5'

CONTRACT NO.

**98387**

SHEET NO. OF

**50 103**

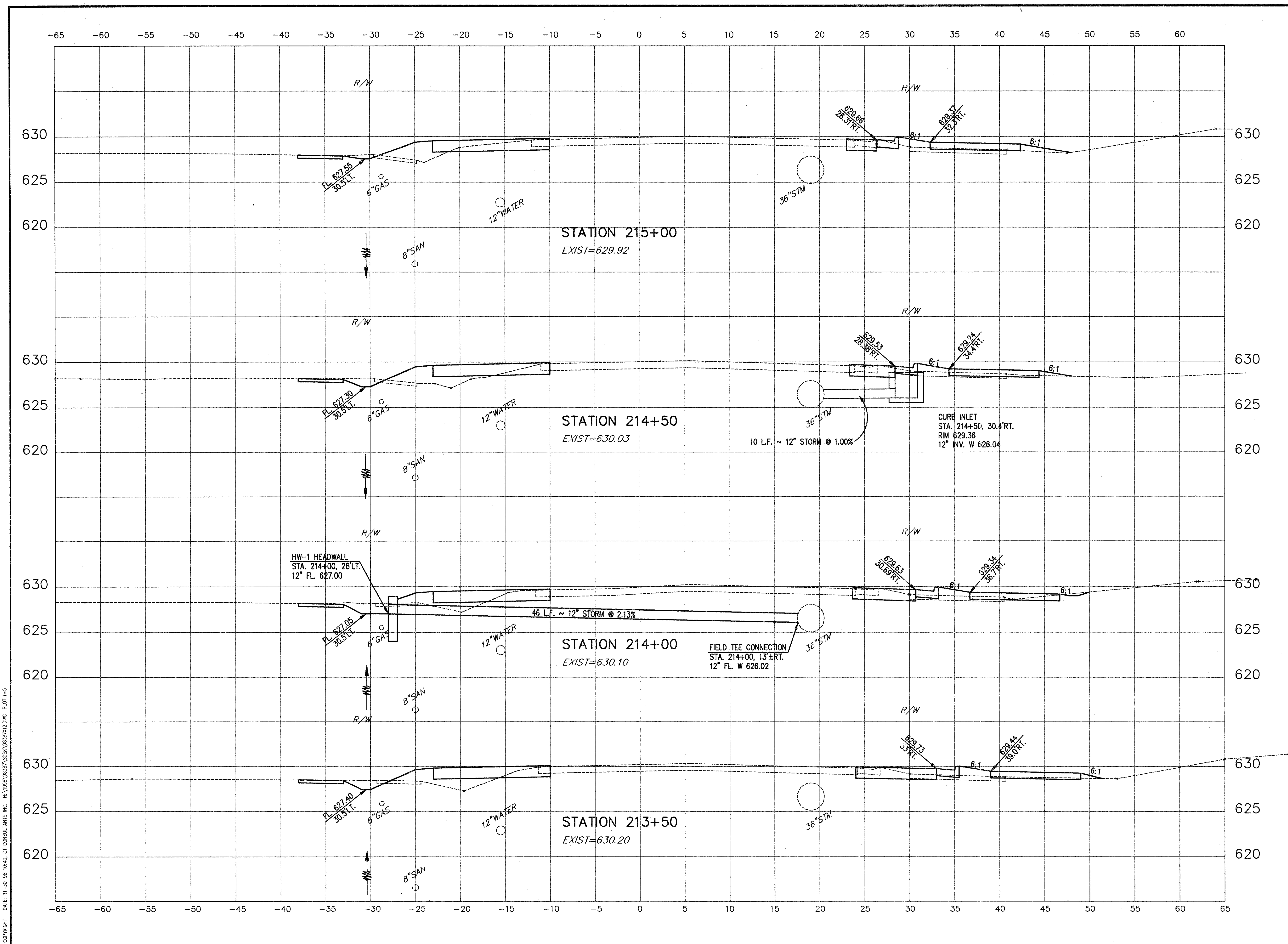

COPYRIGHT - DATE: 11-30-98 10:48, CT CONSULTANTS, INC. H:\9898\98387\SDSK\98387\12.DWG PLOT:1-5