



SUBMISSIONS / REVISIONS

CENTER STREET (STATE ROUTE 615)
ROADWAY IMPROVEMENTS
CENTER STREET
CROSS-SECTIONS
STA. 207+50 TO STA. 209+00

CT Consultants, Inc.
Engineers • Architects • Planners
Willoughby • Mentor • Columbus • North Canton • Youngstown

DATE: DECEMBER, 1998

DRAWN BY: J.J.C.

CHECKED BY: C.C.H.

APPROVED BY:

SCALE:

HOR: 1" = 5'

VERT: 1" = 5'

CONTRACT NO.

98387

SHEET NO. OF

47 103

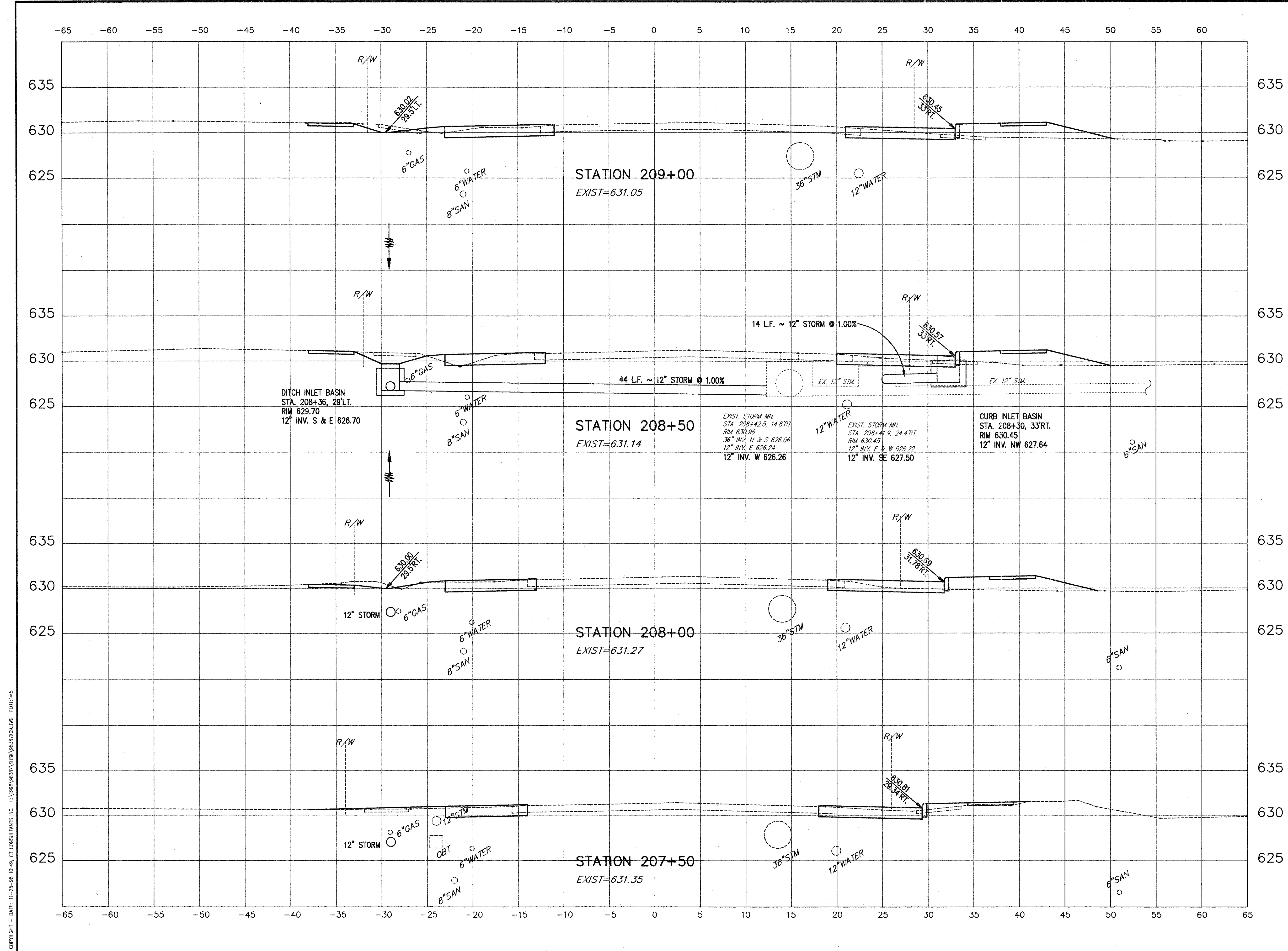

COPYRIGHT - DATE: 11-25-98 10:45 CT CONSULTANTS INC. H:\1998\98387\98387\98387.DWG PLOT:1=5