

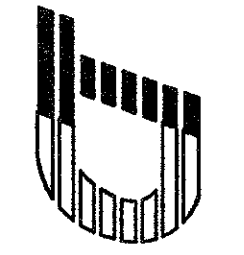

SUBMISSIONS / REVISIONS

**CENTER STREET (STATE ROUTE 615)
ROADWAY IMPROVEMENTS
CENTER STREET
CROSS-SECTIONS
STA. 196+50 TO STA. 198+00**

CT Consultants, Inc.
Engineers • Architects • Planners
Willoughby • Mentor • Columbus • North Canton • Youngstown



DATE:	DECEMBER, 1998
DRAWN BY:	J.J.C.
CHECKED BY:	C.C.H.
APPROVED BY:	
SCALE:	
HOR:	1" = 5'
VERT:	1" = 5'
CONTRACT NO.	
98387	
SHEET NO.	OF
41	103

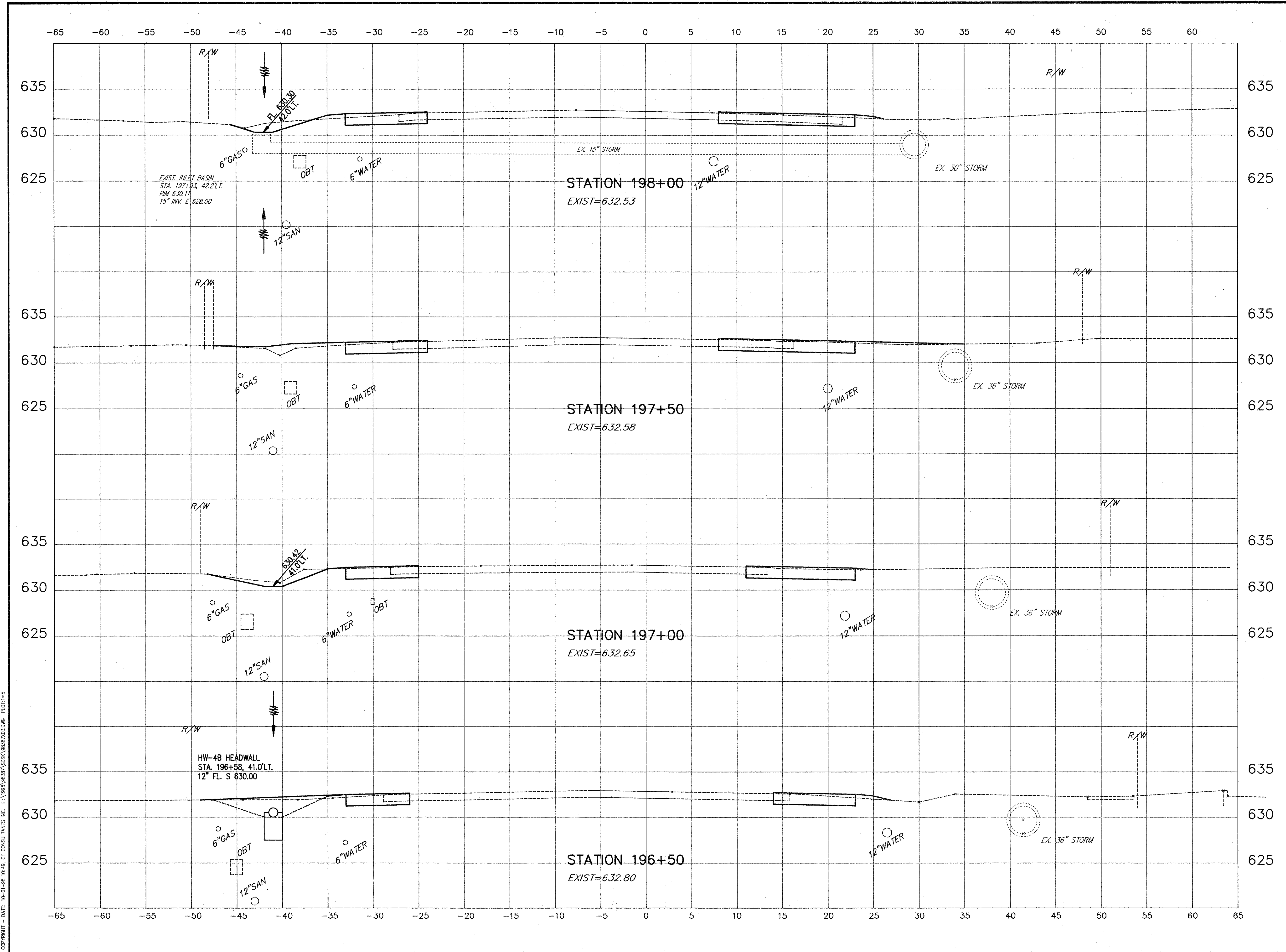

COPYRIGHT - DATE: 10-01-98 10:49, CT CONSULTANTS, INC. H: 119819837, SDSA, 1987203.DWG, PLOT: 1-5