

SUBMISSIONS / REVISIONS	

**CENTER STREET (STATE ROUTE 615)
 ROADWAY IMPROVEMENTS
 INTERSECTION DETAILS
 CENTER STREET / MUNSON ROAD
 / RELOCATED MUNSON ROAD INTERSECTION**

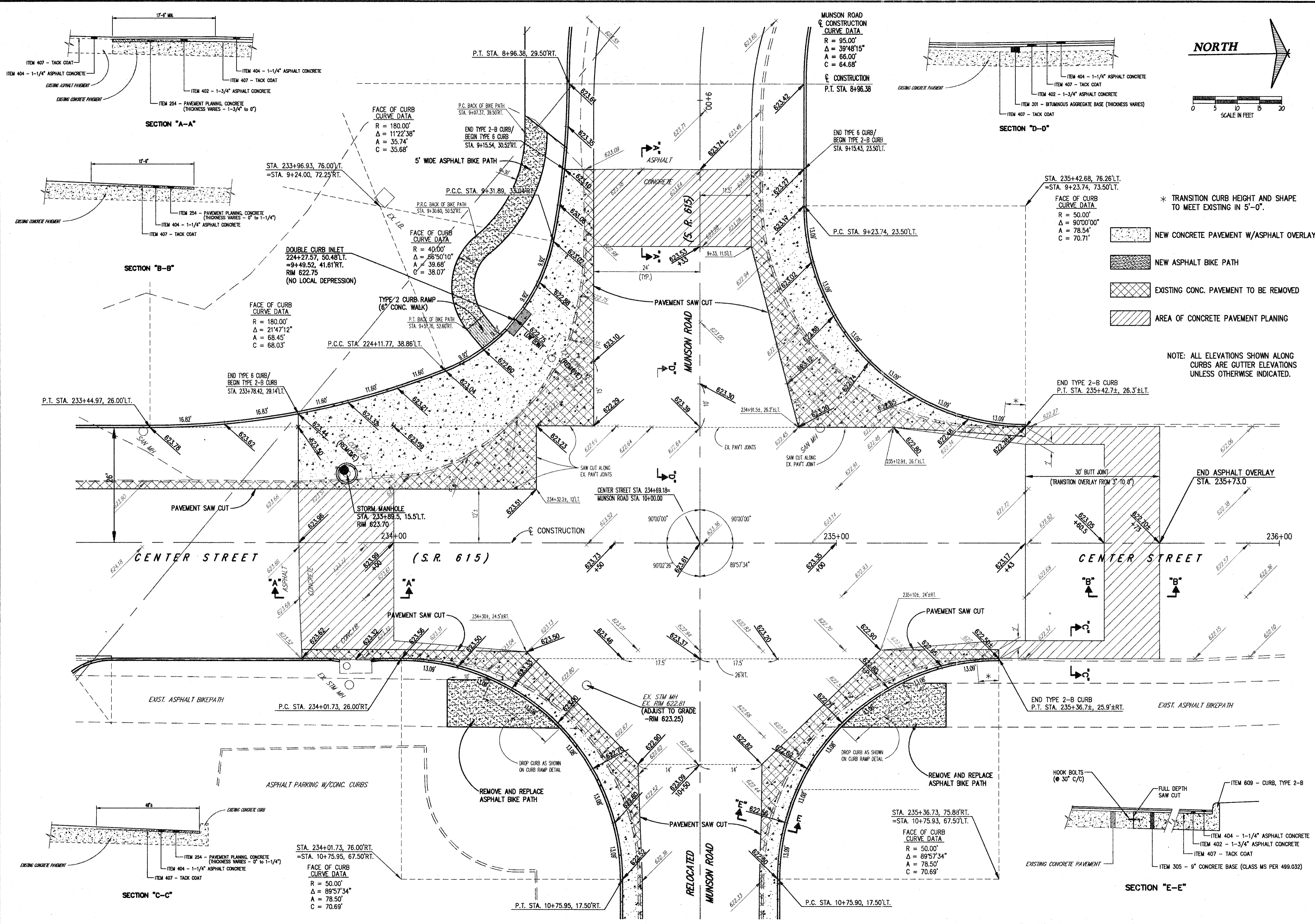

DATE:	APRIL 1999
DRAWN BY:	J.J.C.
CHECKED BY:	C.C.H.
APPROVED BY:	
SCALE:	"1" = 10'
HOR.:	"1" = 10'
VERT.:	
CONTRACT NO.:	
98387	
SHEET NO. OF	
35	103



COPYRIGHT - DATE: 05-15-99 12:45, CT CONSULTANTS, INC. BY: 19980505/0505/WJES/0505.DWG: PLOT: 1010