

NO.	DATE	DESCRIPTION

**CENTER STREET (STATE ROUTE 615)
ROADWAY IMPROVEMENTS
INTERSECTION DETAILS**
CENTER STREET / FAIRFAX DRIVE
/ MENTOR HIGH SCHOOL ENTRANCE INTERSECTION

CT Consultants, Inc.
Engineers • Architects • Planners
Willoughby • Mentor • Columbus • North Canton • Youngstown

DATE:	APRIL, 1999
DRAWN BY:	J.J.C.
CHECKED BY:	C.C.H.
APPROVED BY:	
HOR. SCALE:	1" = 10'
VERT. SCALE:	
CONTRACT NO.:	98387
SHEET NO.:	OF
33	103

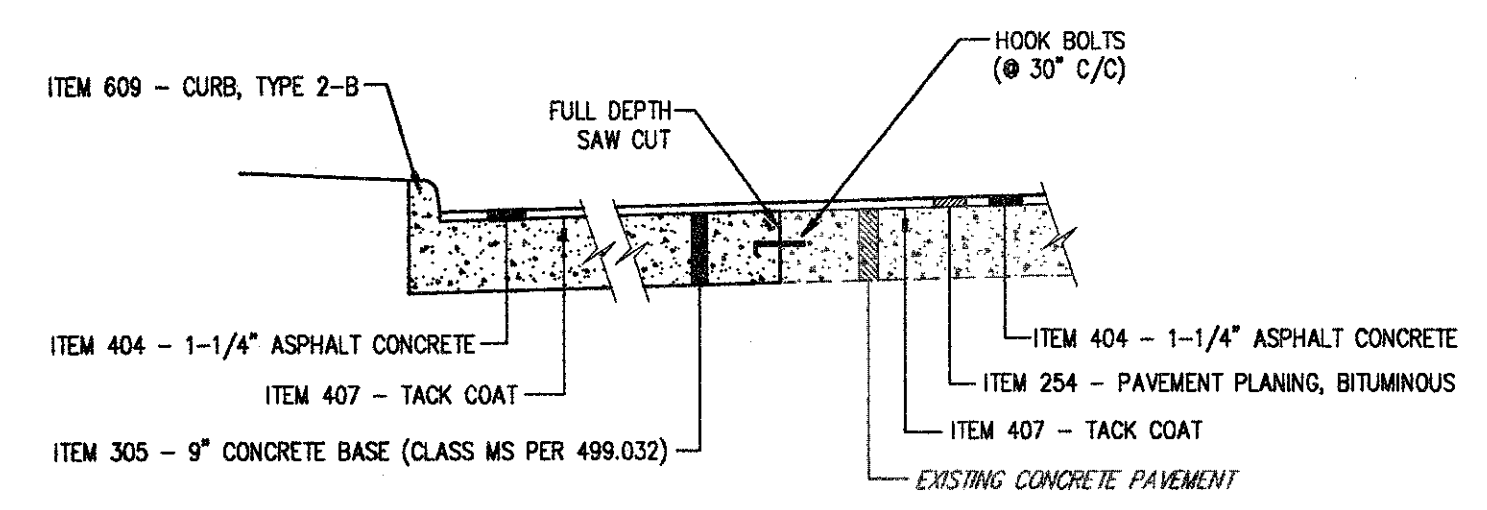
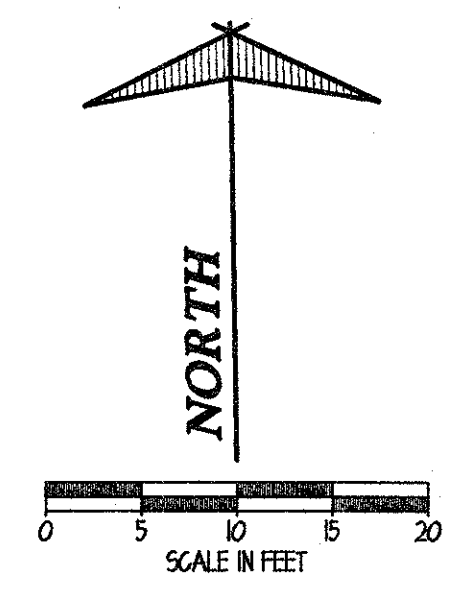

SECTION "A-A"

* TRANSITION CURB HEIGHT FROM 6" TO 0" IN 5'-0".
** TRANSITION CURB FROM TYPE 2-B VERTICAL CURB TO TYPE 3-B ROLL CURB IN 10'-0".

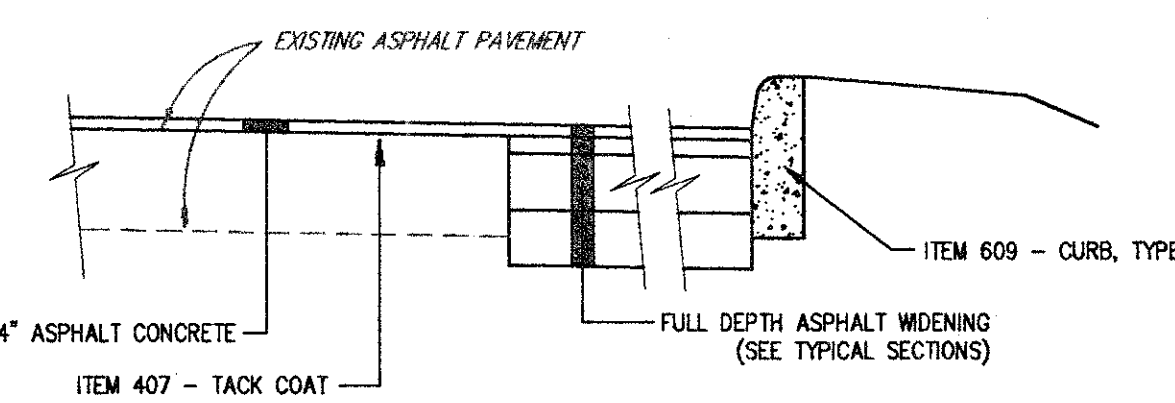
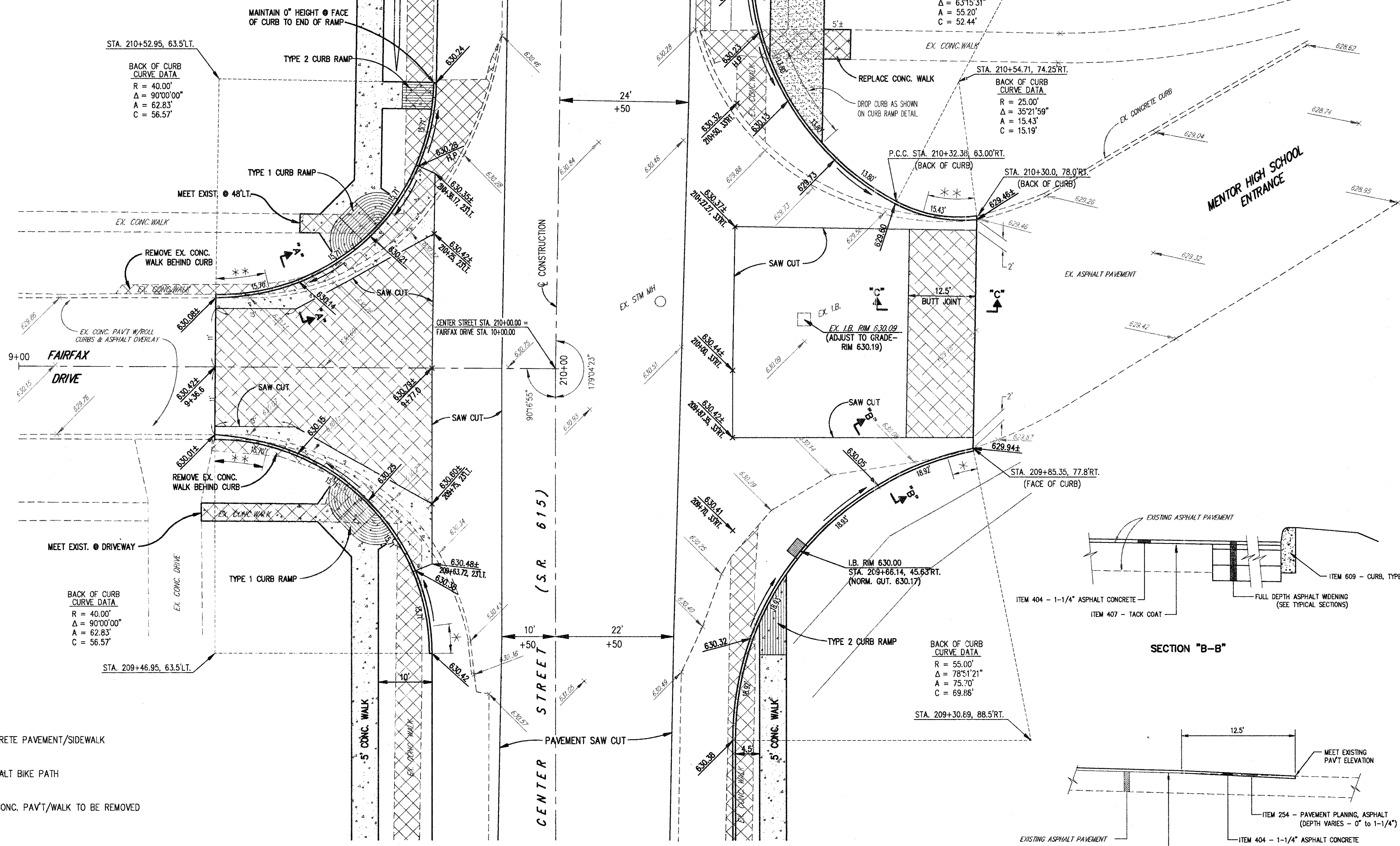

SECTION "B-B"

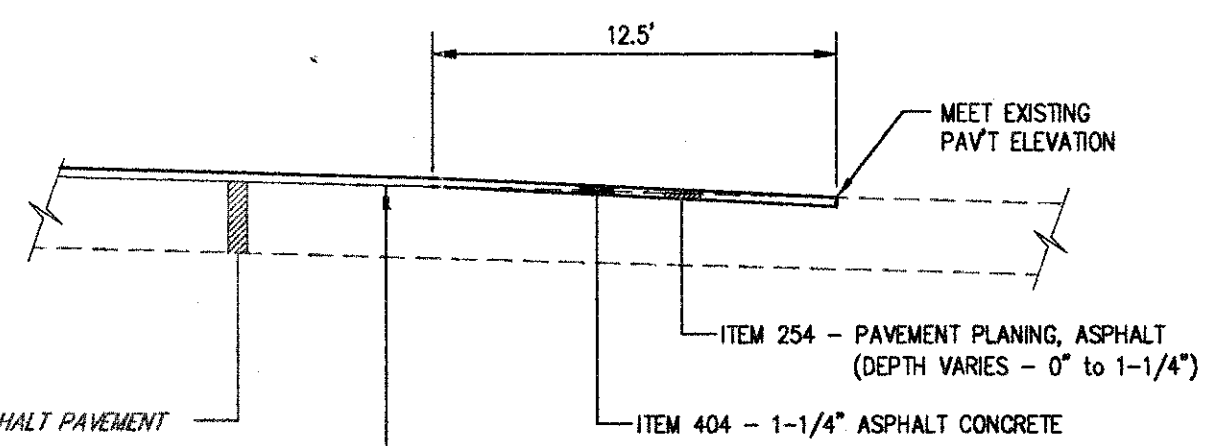

SECTION "C-C"

NOTE: ALL ELEVATIONS SHOWN ALONG CURBS ARE GUTTER ELEVATIONS UNLESS OTHERWISE INDICATED.

- NEW CONCRETE PAVEMENT/SIDEWALK
- NEW ASPHALT BIKE PATH
- EXISTING CONC. PAVT/WALK TO BE REMOVED

COPYRIGHT - DATE: 05-13-99 12:40, CT CONSULTANTS INC. H:\1999\0487\SSA\INTERSECTION.PLOT:1-0