

BENCH MARK:
TOP NW BOLT ON LIGHT POLE IN
FRONT OF MENTOR HIGH SCHOOL
STA. 219+27± RT.
ELEV. 628.69

NOTE: FOR INTERSECTION GRADING AND GEOMETRICS
SEE INTERSECTION DETAIL SHEET NO. 34

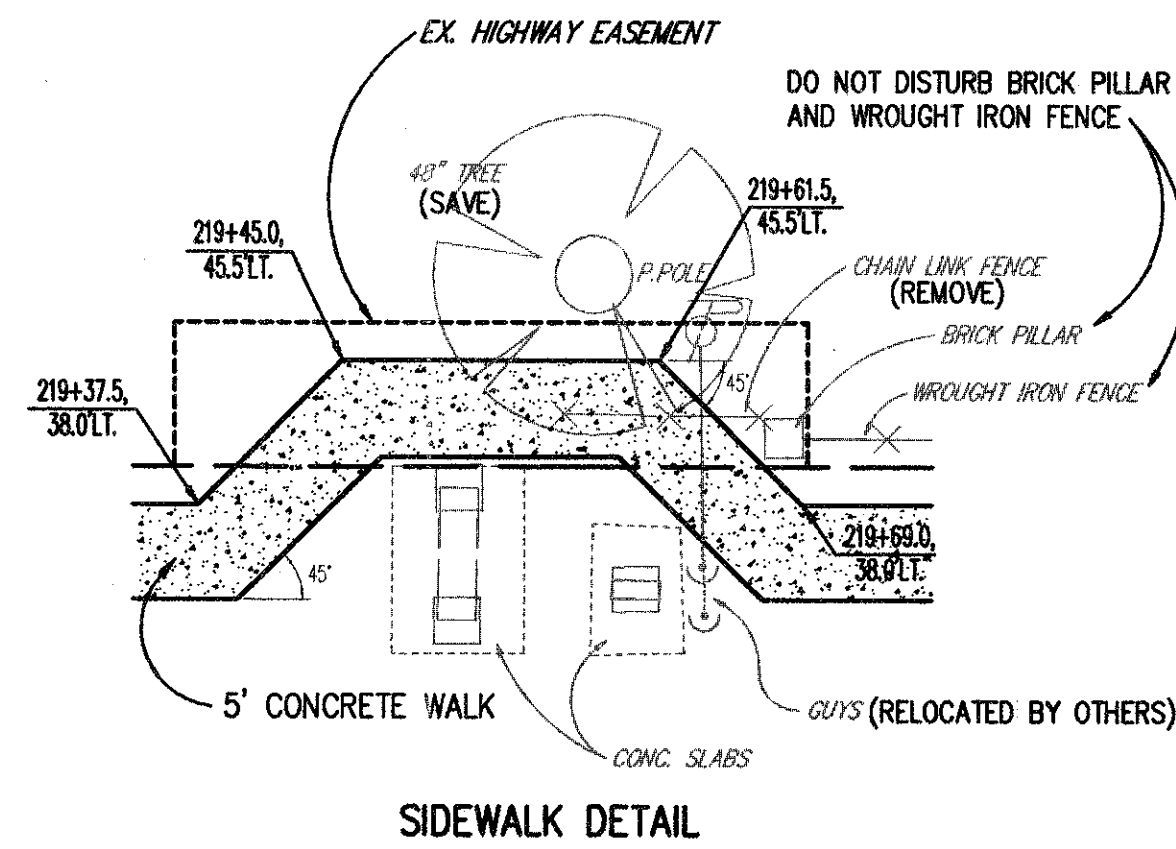
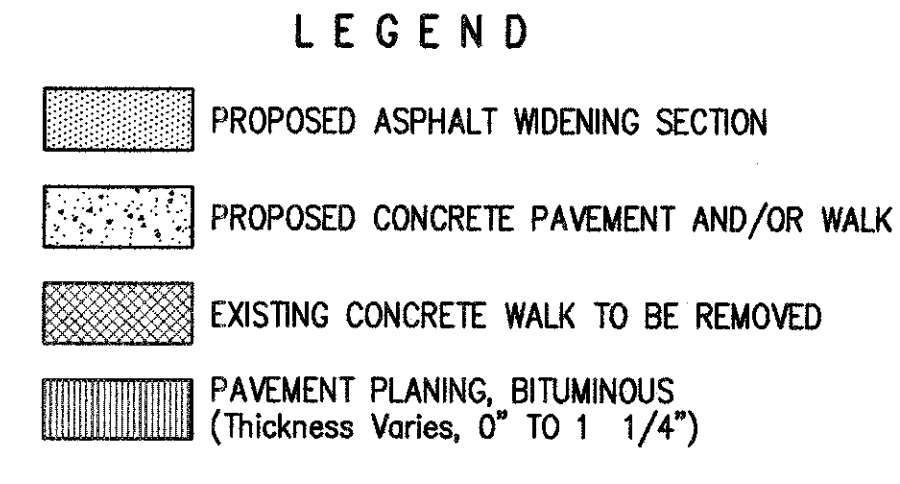
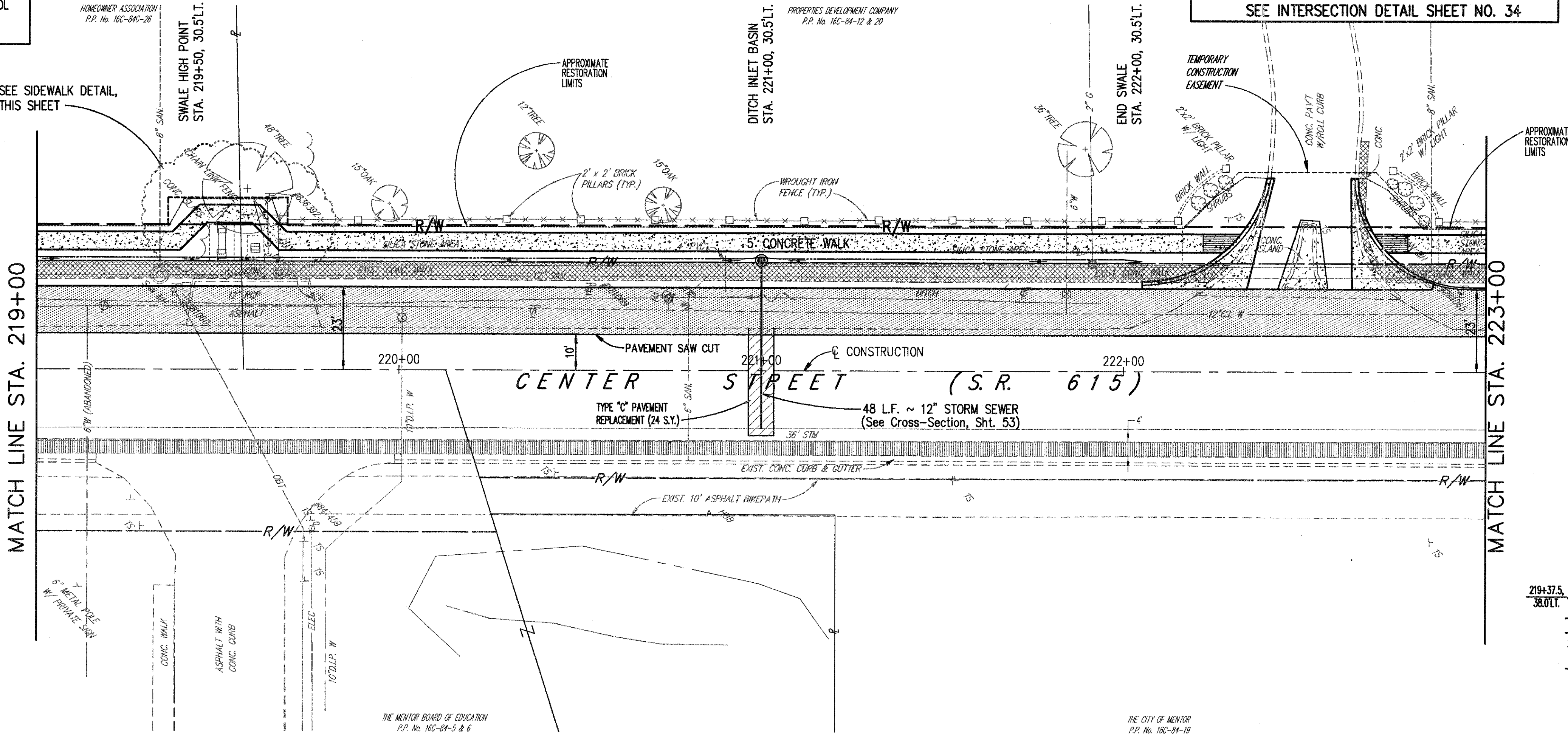
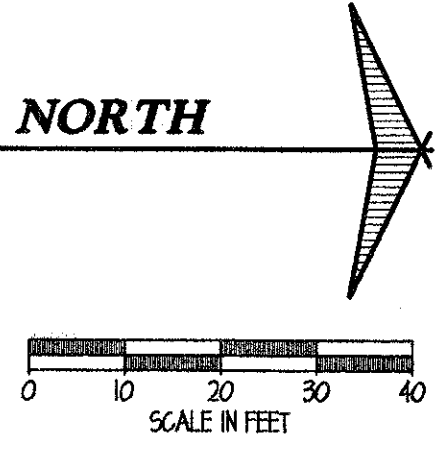

EXISTING PROFILE ELEVATIONS	219+00	220+00	221+00	222+00	223+00
640					640
635					635
630					630
625					625
620					620
615					615
610					610
605					605
	629.11	629.03	628.93	628.86	628.81
					628.74
					628.62
					628.50
					628.36

**CENTER STREET (STATE ROUTE 615)
ROADWAY IMPROVEMENTS
CENTER STREET
PLAN & PROFILE
STA. 219+00 TO STA. 223+00**

CT Consultants, Inc.
Engineers • Architects • Planners
Willoughby • Mentor • Columbus • North Canton • Youngstown

DATE:	DECEMBER, 1998
DRAWN BY:	J.L.C.
CHECKED BY:	C.C.H.
APPROVED BY:	
SCALE:	HOR. 1" = 20' VERT. 1" = 5'
CONTRACT NO.	98387
SHEET NO.	OF
23	103

COPYRIGHT - DATE: 05-12-99 08:36 CT CONSULTANTS INC. H:\1998\98387\SS\98387.DWG PLOT1=20