

BENCH MARK:  
TOP NW BOLT ON LIGHT POLE IN  
FRONT OF MENTOR HIGH SCHOOL  
STA. 214+32± RT.  
ELEV. 628.08

WILLIAM FIFE & RHONDA POE  
P.P. No. 16C-84C-18

HOMEOWNER ASSOCIATION  
P.P. No. 16C-84C-26

HOMEOWNER ASSOCIATION

APPROXIMATE  
RESTORATION  
LIMITS

HW-1 HEADWALL  
STA. 214+00, 28' LT.

EXISTING 40'  
PUBLIC ACCESS  
EASEMENT

NORTH



MATCH LINE STA. 211+00

MATCH LINE STA. 215+00

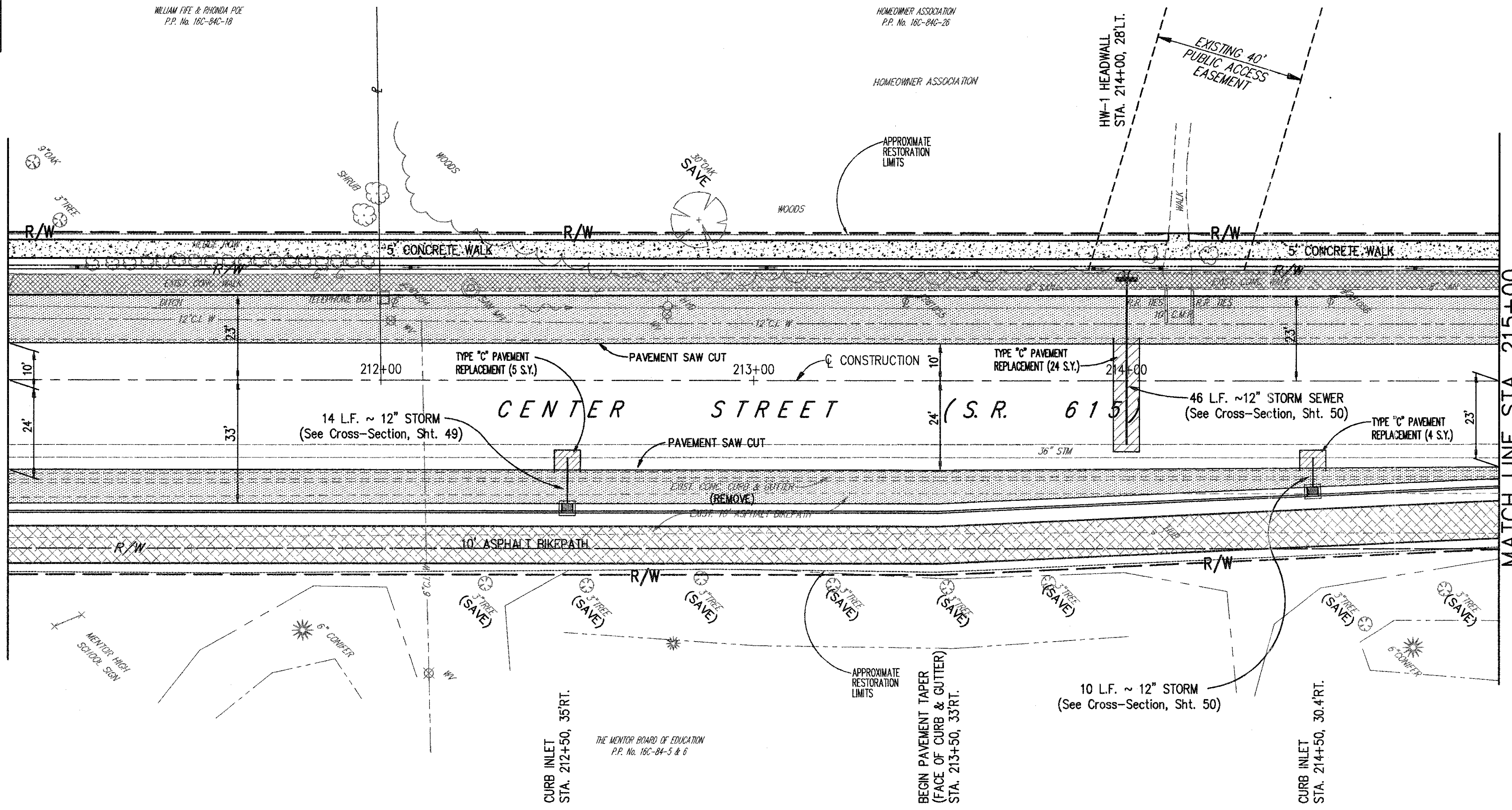

LEGEND

- PROPOSED ASPHALT WIDENING SECTION
- PROPOSED CONCRETE PAVEMENT AND/OR WALK
- PROPOSED ASPHALT BIKE PATH
- EXISTING CONCRETE WALK TO BE REMOVED

CENTER STREET (STATE ROUTE 615)  
ROADWAY IMPROVEMENTS  
CENTER STREET  
PLAN & PROFILE  
STA. 211+00 TO STA. 215+00

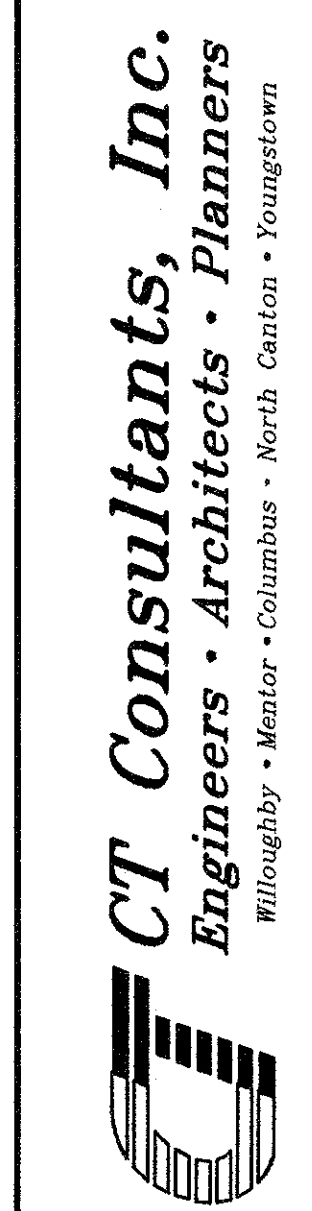

DATE:	DECEMBER, 1998
DRAWN BY:	J.J.C.
CHECKED BY:	C.C.H.
APPROVED BY:	
SCALE:	HOR. 1" = 20' VERT. 1" = 5'
CONTRACT NO.	98387
SHEET NO.	21
OF	103

	211+00	212+00	213+00	214+00	215+00					
635	630.23	630.13 +50	630.03	629.93 +50	629.83	629.73 +50	629.63	629.53 +50	629.66 CHANGE GRADE	635
630										630
625										625
620										620
615										615
610										610
605										605
EXISTING PROFILE ELEVATIONS	630.67	630.59	630.46	630.39	630.29	630.20	630.10	630.03	629.92	

MATCH LINE STA. 211+00

MATCH LINE STA. 215+00

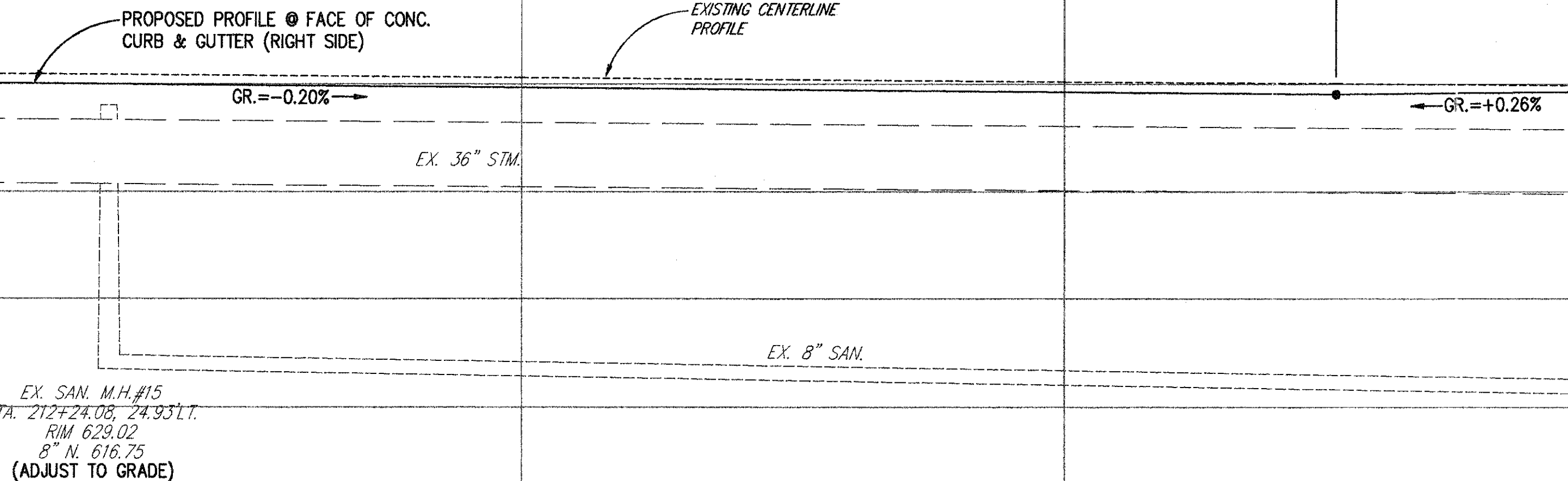

COPYRIGHT - DATE: 05-12-98 07:48, CT CONSULTANTS INC. H:\1998\98387\525\98387.DWG: PLOT1+00