

FED. RD. DIVISION	STATE	PROJECT	
2	OHIO		

LAKE COUNTY  
LAK-615-326

118  
181

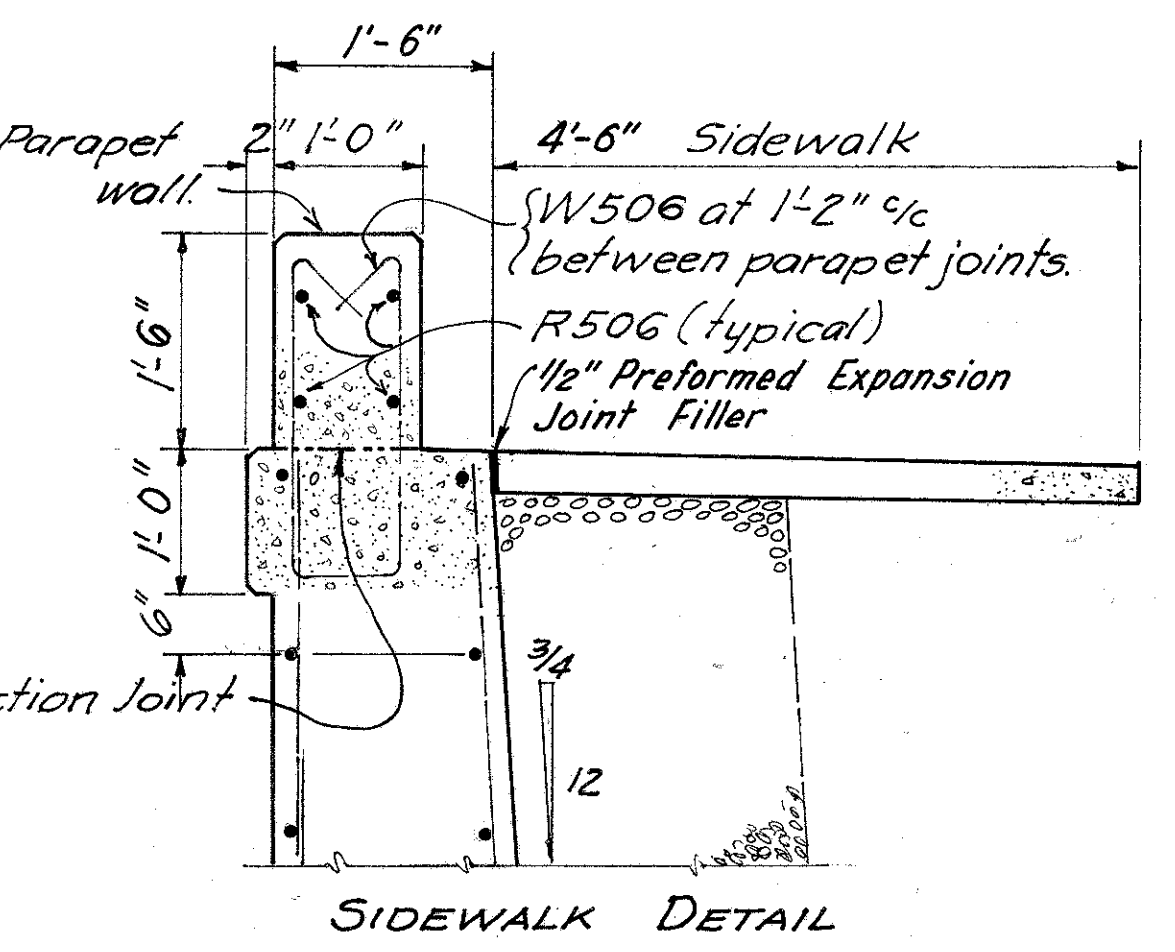
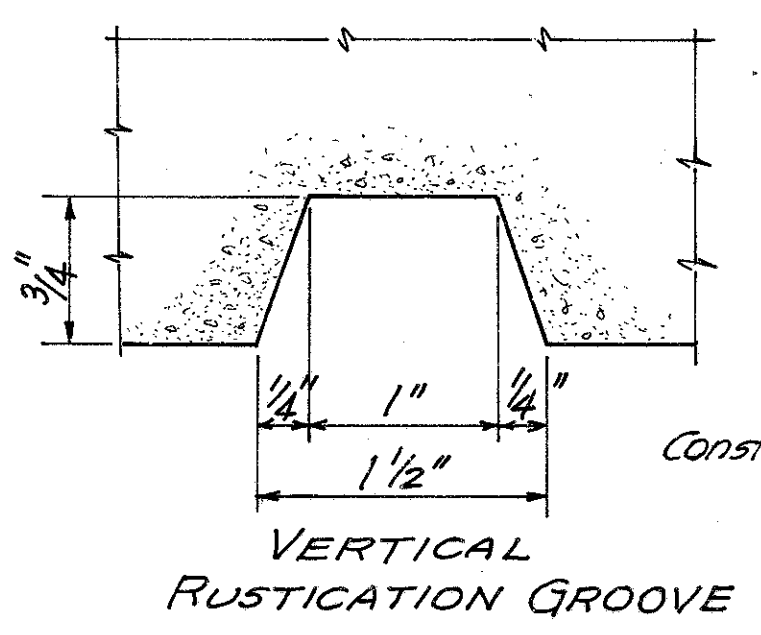
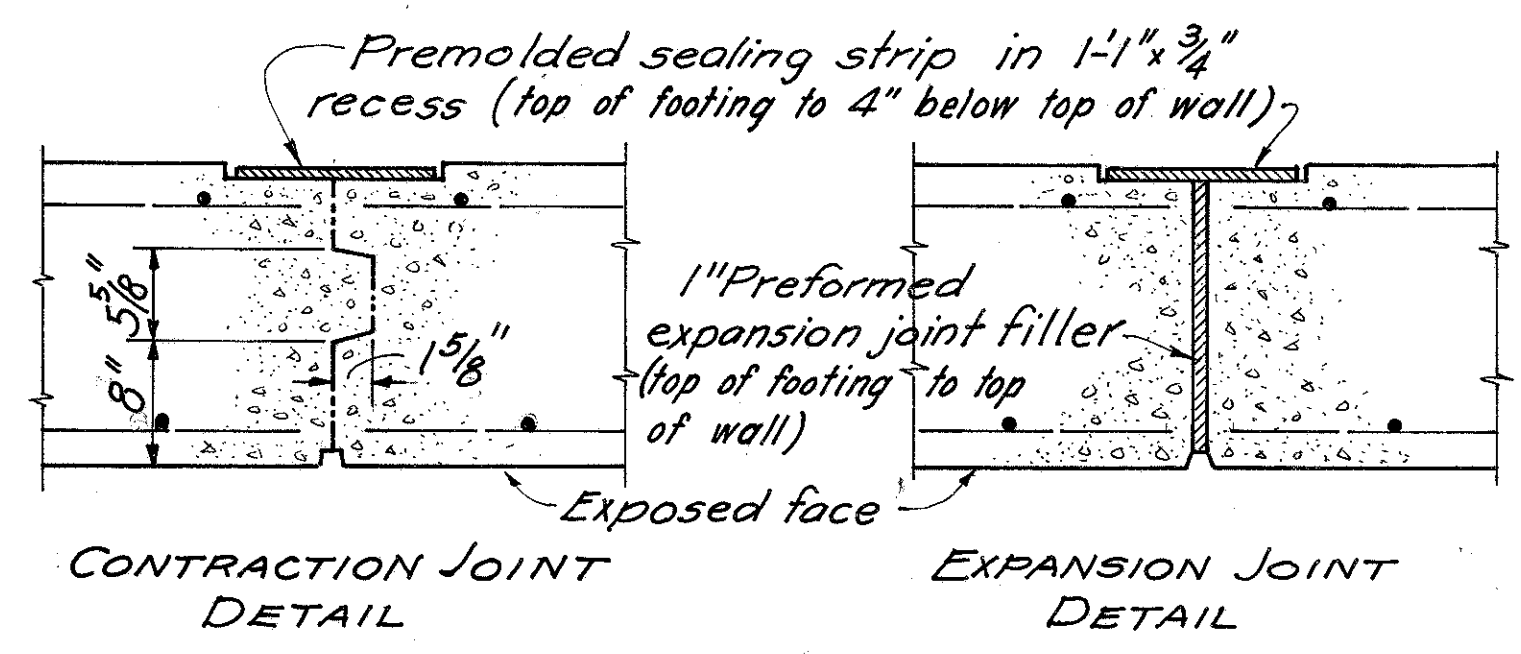
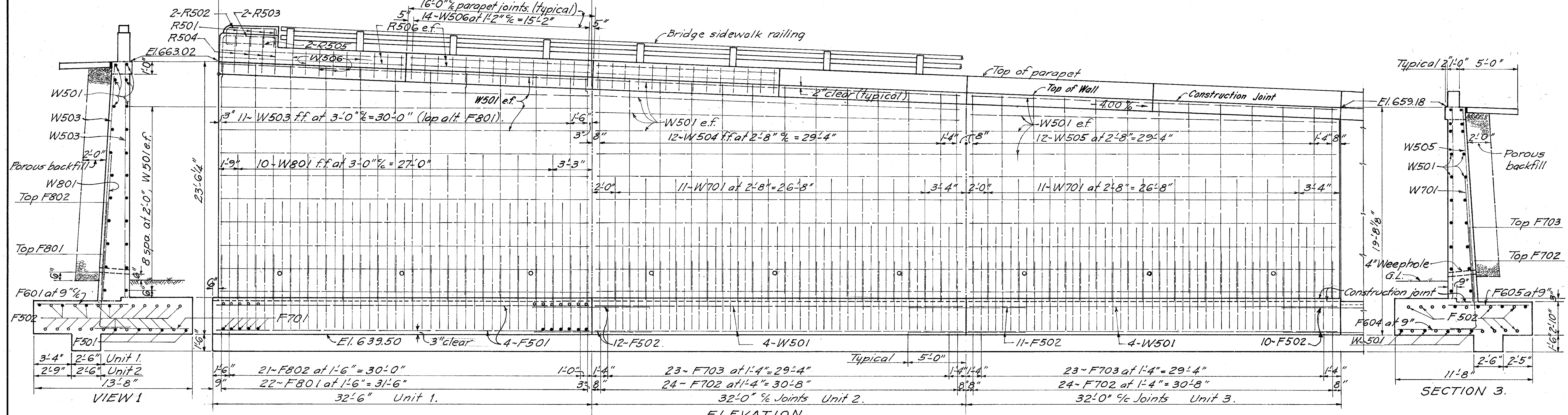
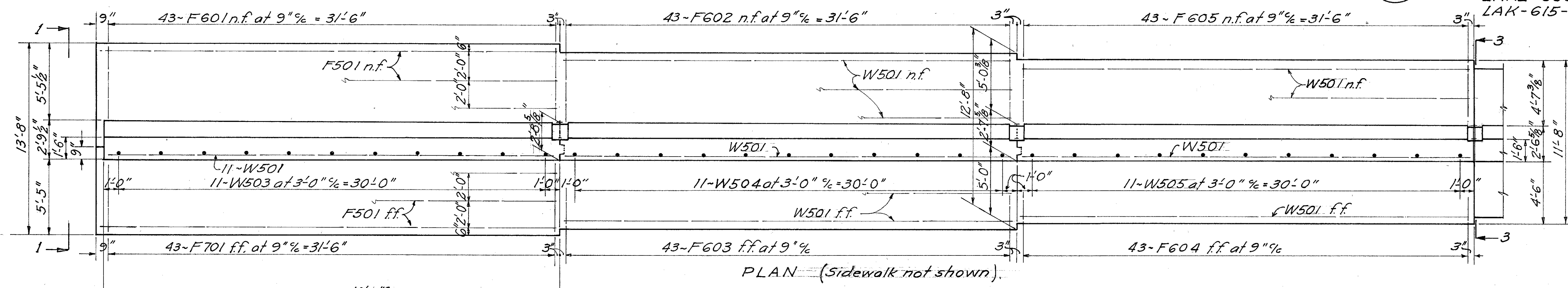

LEGEND:-  
n.f. .... near face.  
f.f. .... far face.  
e.f. .... each face.

BURGESS & NIPLE LIMITED — CONSULTING ENGINEERS				
COLUMBUS, OHIO				
2/5				
RETAINING WALL "A" UNITS 1, 2, AND 3. SIDEWALK AND JOINT DETAILS.				
LAKE COUNTY			STA. 58+25	
			STA. 61+81	
DESIGNED	DRAWN	TRACED	CHECKED	REVIEWED DATE
K.G.D.	K.G.D.	K.G.D.	AM	WR 12-26-68

DEC 11 1970 JUN 26 1970