

MICROFILMED  
FEB 12 1985

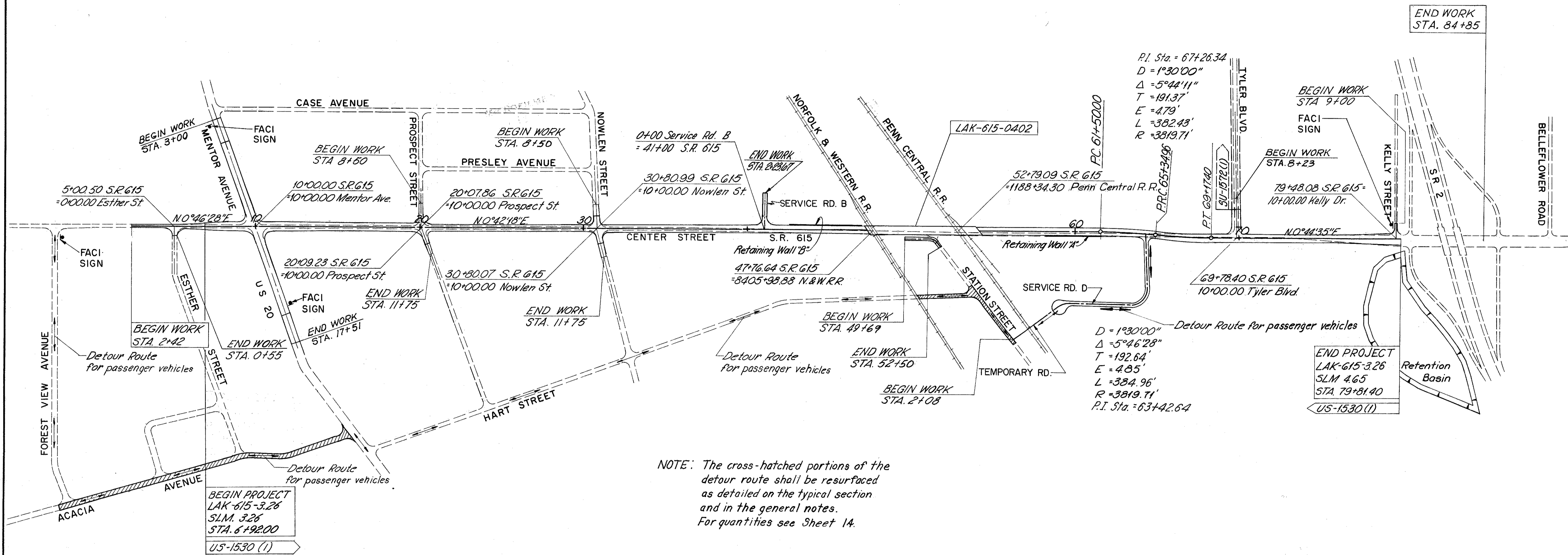

FED. ROAD DIV. NO.	STATE	FED. AID PROJ. NO.	2 181
2	OHIO		

LAKE COUNTY  
LAK-615 - 3.26

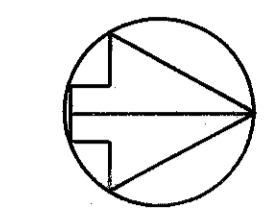

NOTE: The cross-hatched portions of the detour route shall be resurfaced as detailed on the typical section and in the general notes. For quantities see Sheet 14.

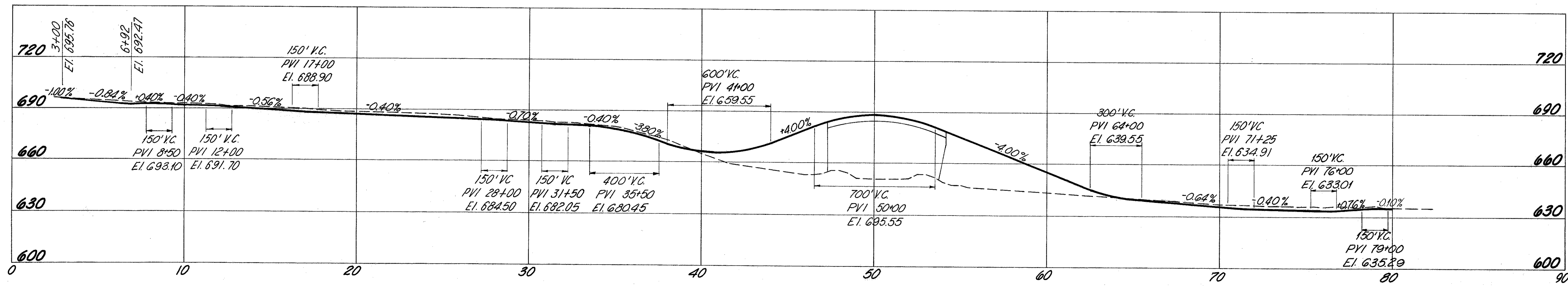

SCHEMATIC PLAN AND PROFILE

DEC 11 1970  
JUN 26 1970