

EXISTING PAV'T TO BE REMOVED

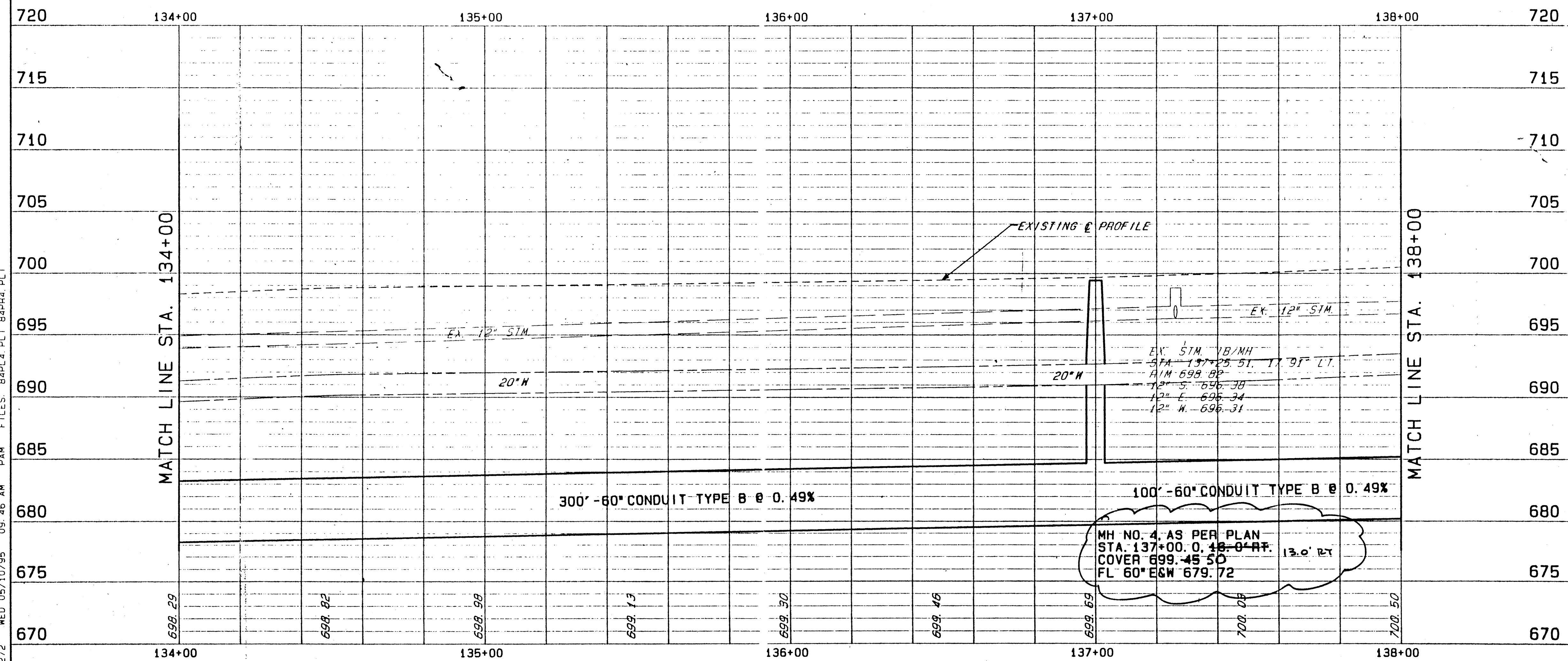

| ITEM NO. | DESCRIPTION | EA. | LF. | RT. | TOTALS |
|----------|---------------------------------------------------------|-----|-----|-----|--------|
| 604 | MANHOLE NO. 4, AS PER PLAN | 1 | | | 1 |
| 604 | CATCH BASIN NO. 2-2B, AS PER PLAN | 1 | | | 1 |
| 603 | 60" CONDUIT, TYPE B AS PER PLAN (A) 706.02, 1500 D-LOAD | | 300 | 100 | 400 |
| 603 | 12" CONDUIT, TYPE B AS PER PLAN, 706.02 | | | 6 | 6 |
| TOTALS | | | | | 6 |

FOR TYPICAL SECTION SEE SHEET 4
FOR CROSS SECTIONS SEE SHEET 83-85
FOR ROADWAY DETAILS SEE SHEET 149

QUANTITIES HAVE BEEN CARRIED TO SUB-SUMMARY SHEETS 42-45

CHANGE ORDER
 184-01 3/8
 9-5-01

90272 MED 05/10/95 09:46 AM PAM FILES: 84PL4.PLT 84PR4.PLT