

LAK - 615 - 2.82

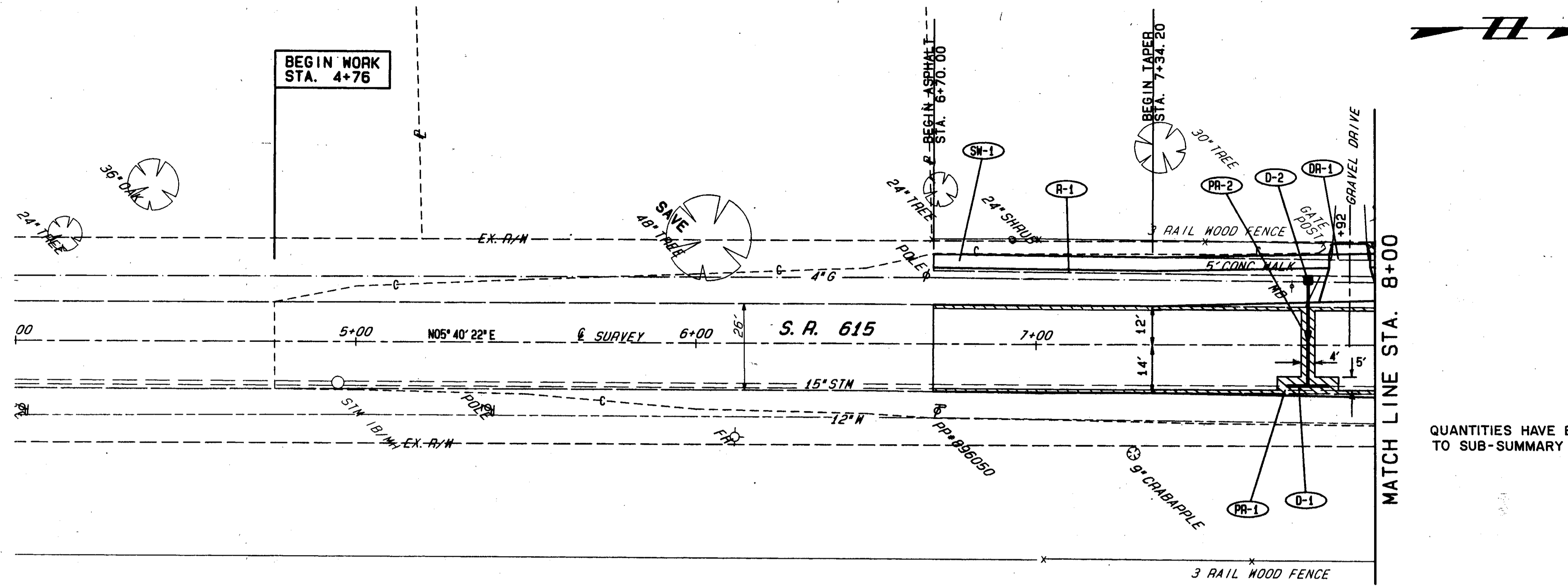

MATCH LINE STA. 8+00

QUANTITIES HAVE BEEN CARRIED TO SUB-SUMMARY SHEETS 42-45

EX. PAV'T. TO BE REMOVED

202	WALK REMOVED	S.F.	650	
			TOTALS	650

ROADWAY		LOCATION	REF	QTY
R-1	STA. 6+70.00 LT. TO STA. 8+00.00 LT.			

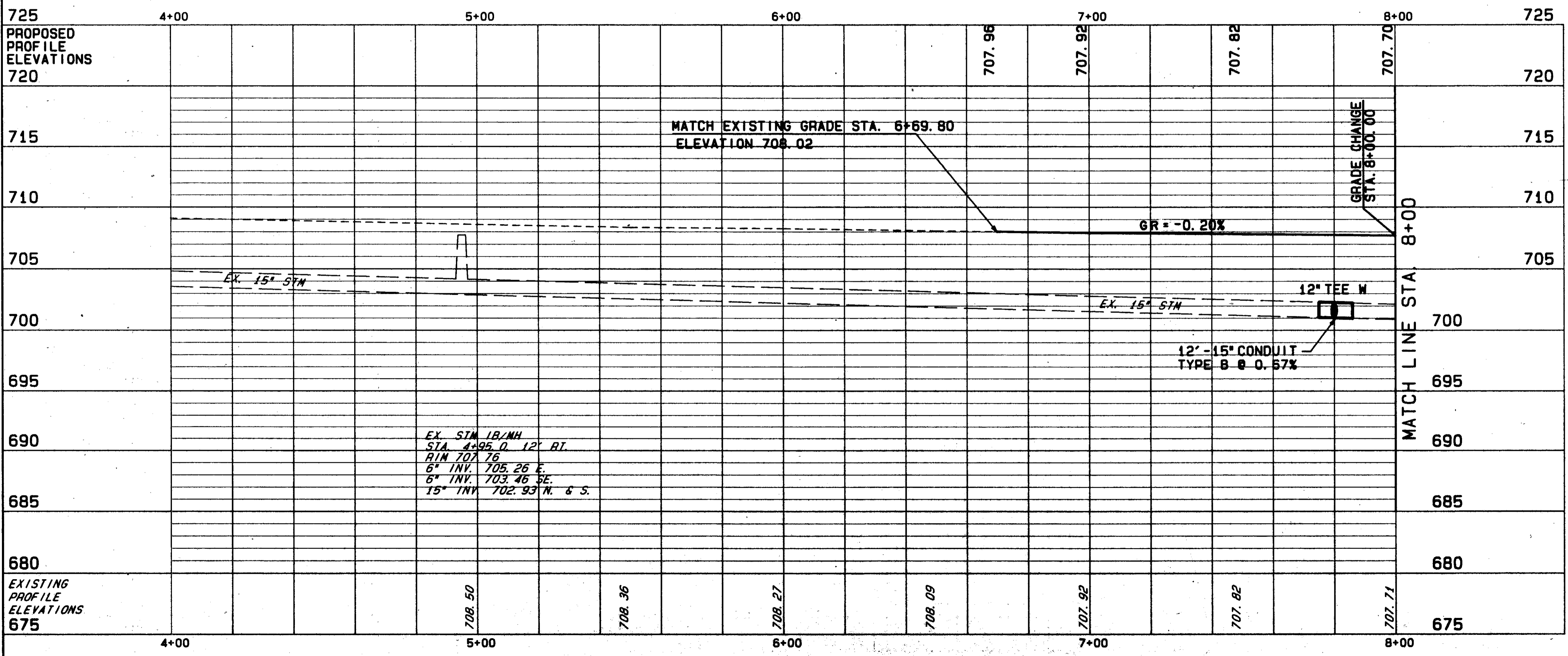

604	15' x 12' x 15' TEE	EA.	1	
604	INLET, NO. 1, AS PER PLAN	EA.	1	
603	15" CONDUIT, TYPE B AS PER PLAN, 706.02	L.F.	12	12
603	12" CONDUIT, TYPE B AS PER PLAN, 706.02	L.F.	31	31
			TOTALS	31

FOR STORM SEWER CONNECTION SCHEDULE SEE SHEET 46
 FOR TYPICAL SECTIONS SEE SHEET 4
 FOR CROSS SECTIONS SEE SHEETS 104-105
 FOR DRIVEWAY PROFILES SEE SHEET 130
 FOR DRIVEWAY DETAILS SEE SHEETS 150-151
 FOR PAVEMENT MARKING PLANS SEE SHEET 160
 FOR STAGING PLANS SEE SHEET 164

DRAINAGE & SANITARY		LOCATION	REF	QTY
D-1	STA. 7+74.00 RT. TO STA. 7+86.00 RT.			
D-2	STA. 7+80.00 LT. TO STA. 7+90.00 RT.			

90272 MON 03/25/96 09:33 AM RANDY FILES: PL1A.PLT PRIA21.PLT