

I:\PROJECTS\1790\dgn\12790gdf.dgn 08-NOV-2000 11:05AM jgrmovse

CENTER STREET INTERIM CONNECTOR

CL GEOMETRY

P.I. Sta = 0+44.67	P.I. Sta = 1+26.53	P.I. Sta = 1+93.02
D = 28° 38' 19" (LT)	D = 22° 13' 05" (RT)	D = 7° 24' 46" (RT)
Dc = 32° 44' 26"	Dc = 32° 44' 26"	Dc = 11° 15' 09"
R = 175.00'	R = 175.00'	R = 509.18'
T = 44.67'	T = 34.36'	T = 32.98'
L = 87.47'	L = 67.86'	L = 65.88'
E = 5.61'	E = 3.34'	E = 1.07'

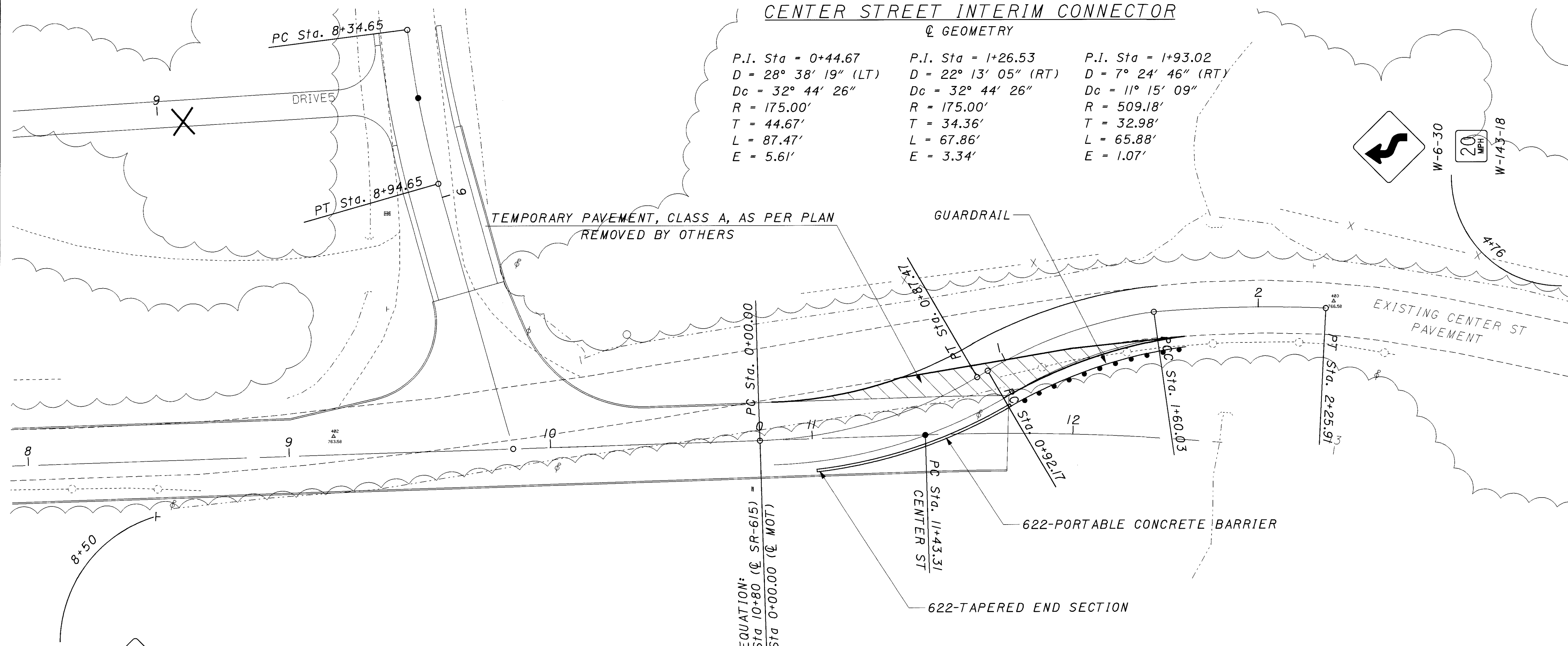

TEMPORARY PAVEMENT, CLASS A, AS PER PLAN
TEMPORARY ROADS, AS PER PLAN

THE PROVISIONS OF SECTION 615 OF THE CMS SHALL APPLY TO THESE ITEMS EXCEPT THAT THE REQUIREMENTS OF SECTION 615.08 SHALL BE WAIVED. ALL WORK REQUIRED TO CONSTRUCT THE INTERIM SR-615 CONNECTOR AS SHOWN ON THIS SHEET SHALL REMAIN IN PLACE AT THE END OF THIS PROJECT.

THE FOLLOWING ITEMS SHALL BE INCLUDED FOR PAYMENT WITH ITEM 615, TEMPORARY ROADS, AS PER PLAN. THESE QUANTITIES HAVE BEEN PROVIDED FOR ESTIMATING PURPOSES ONLY:

203, EXCAVATION	35 CU YD
606, GUARDRAIL, TYPE 5	100 LIN. FT.
622, PORTABLE CONCRETE BARRIER, 32"	80 LIN. FT.
626, BARRIER REFLECTOR, TYPE B2	8 EACH

THE FOLLOWING QUANTITIES HAVE BEEN PROVIDED FOR THE PURPOSE OF THIS WORK:

615, TEMPORARY PAVEMENT, CLASS A, AS PER PLAN	112 SQ YD
615, TEMPORARY ROADS, AS PER PLAN	LUMP SUM

MAINTENANCE OF TRAFFIC
SR-615 INTERIM CONNECTION

LAK-615-1.26

20
160