

Ⓞ TEMPORARY CONNECTION
TO S.R.615
(SEE SHEET XX FOR
DETAILS)

STA. 11+00 (CENTER RD.)
OFFSET:
14.5' LT, 0'

PART-WIDTH CONSTRUCTION
SHALL BE USED TO ENSURE
ACCESS TO KINGWOOD DRIVE
IS MAINTAINED AT ALL TIMES

TEMPORARY CONNECTION
TO BE CONSTRUCTED PRIOR
TO PHASE 2 CONSTRUCTION



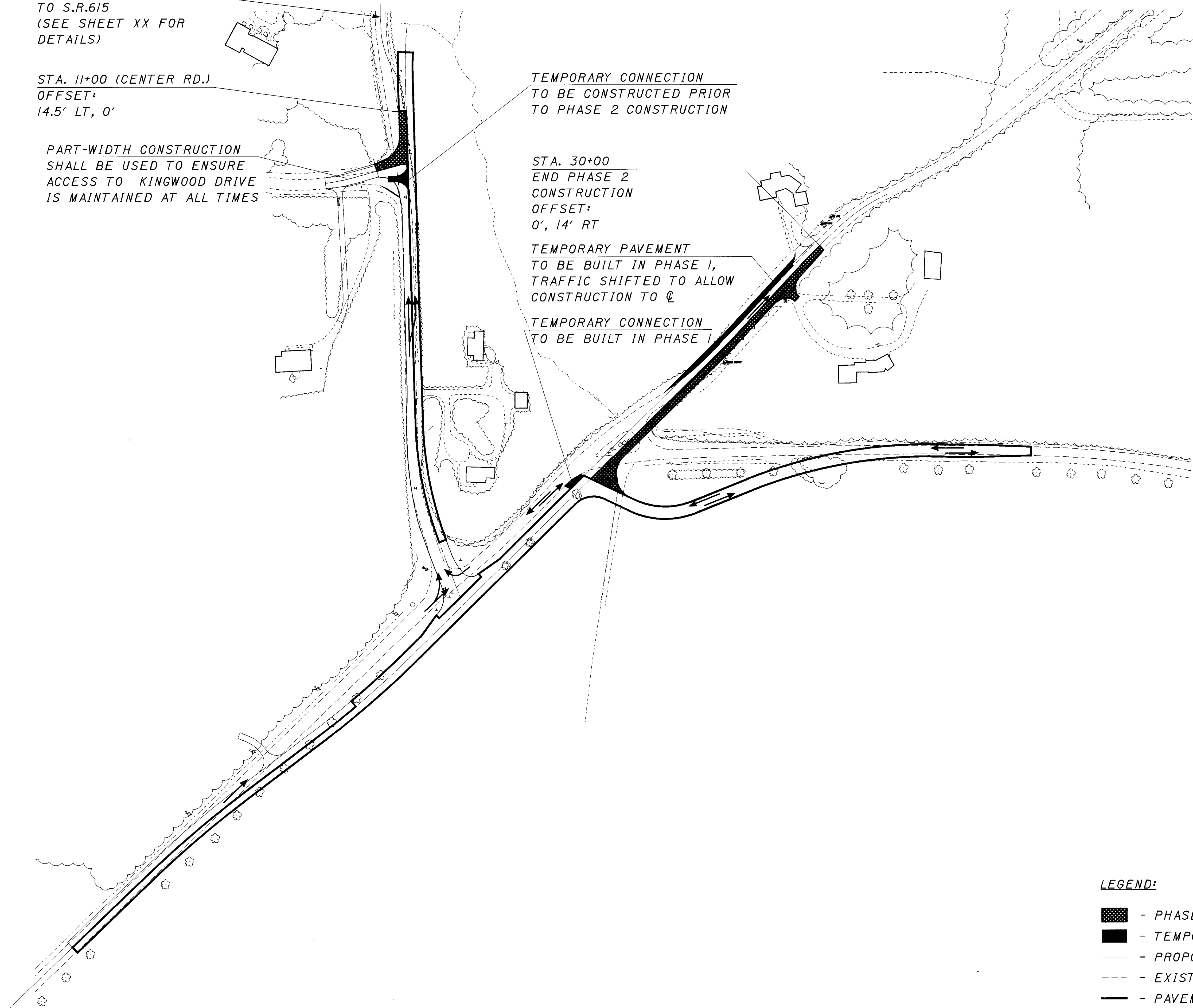

STA. 30+00
END PHASE 2
CONSTRUCTION
OFFSET:
0', 14' RT

TEMPORARY PAVEMENT
TO BE BUILT IN PHASE 1,
TRAFFIC SHIFTED TO ALLOW
CONSTRUCTION TO Ⓞ

TEMPORARY CONNECTION
TO BE BUILT IN PHASE 1

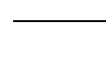
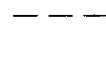

LEGEND:

-  - PHASE 2 CONSTRUCTION
-  - TEMPORARY PAVEMENT
-  - PROPOSED PAVEMENT
-  - EXISTING PAVEMENT
-  - PAVEMENT CONSTRUCTED
DURING PREVIOUS PHASES

SEQUENCE OF CONSTRUCTION
PHASE 2

LAK-615-1.26

16
160

