

11-1-1

H-10

STATE OF OHIO DEPARTMENT OF HIGHWAYS

FED. RD. DIVISION	STATE	PROJECT	TYPE FUNDS
2	OHIO		

1
19

LAK-608-0.60
LAKE COUNTY

LAK-608-0.60 LAKE COUNTY CONCORD TOWNSHIP

CONVENTIONAL SIGNS

COUNTY LINE _____
 CORPORATION LINE _____
 CENTER LINE _____
 RAIL ROAD _____

INDEX OF SHEETS

TITLE SHEET	1
TYPICAL SECTION	2
PAVEMENT CALC. & GENERAL SUMMARY	3
PLAN & PROFILE	4
DETAIL	5
CROSS SECTIONS	6 to 14
BRIDGE PLANS	15 to 19

LINE DATA

BEGIN PROJECT STATION 14+00
 END PROJECT STATION 25+00
 GROSS & NET LENGTH OF PROJECT: 1100 LIN. FT. OR .208 MILES.

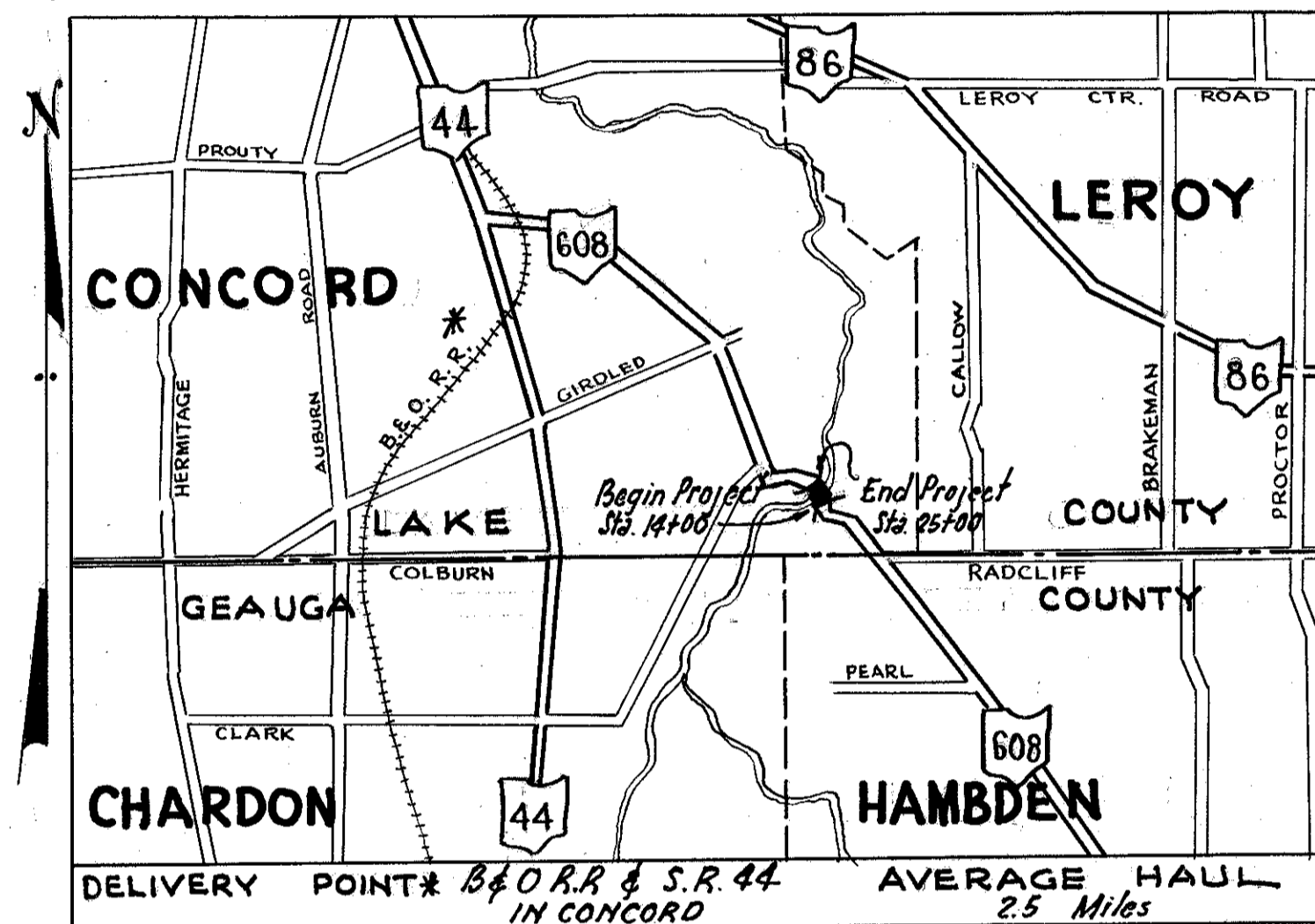

LOCATION PLAN

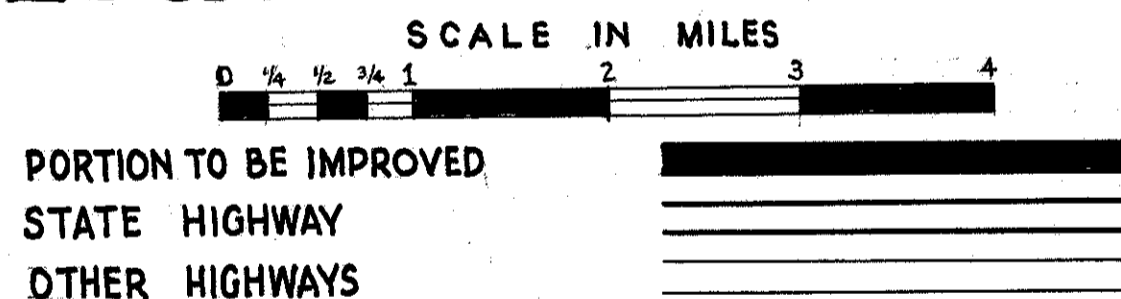

SCALES

PLAN 1" = 50'
 PROFILE VER. 1" = 10'
 PROFILE HOR. 1" = 50'

The standard specifications of The State of Ohio Department of Highways, including changes and supplemental specifications listed in the proposal shall govern this improvement.

I hereby approve these plans and declare that the making of this improvement will not require the closing to traffic of the highway and that provisions for the maintenance and safety of traffic will be as set forth on the plans and estimates.

The right of way for this improvement will be provided by the State of Ohio.

- Approved: Arthur A. Enove
 Date 1-5-55 Division Deputy Director
- Approved: John Heier
 Date 1-21-55 Deputy Director of Planning and Programming
- Approved: Richard Orth
 Date 1-19-55 Engineer of Bridges
- Approved: K. L. Roth
 Date 1-22-55 Engineer of Location & Design
- Approved: W. H. Wood
 Date 1-22-55 Deputy Director of Design & Construction
- Approved: J. P. Schaublin
 Date 1-22-55 First Assistant Director
- Approved: A. C. Swell
 Date 1-22-55 Director of Highways.

CONSTRUCTION BUREAU
 APR 12 1957
 GROUND PHOTOLAB

STANDARD DRAWINGS			
R.I.-1	6/1/53	L-3A	4/1/50
G-7.07	1/2/53	CS-1-54 2 SHEETS	12/1/54
T-35	10/1/52	AS-1-54	12-1-54
I-15 N#1	12-1-54	I-1,2,3,4,5	2-20-45
I-15 N#2	12-1-54	L-1	4-1-50
L-3	4/1/50		

SUPPLEMENTAL SPECIFICATIONS			
B-119	R. 12-1-54		
L-209.12	7-17-54		

00073R

FILE NO	LAKE COUNTY	LAK.608-0.60
DATE OF LETTING	195	
CONTRACT NO		