

FED. RD. DIST. NO.	STATE	FED. AID PROJECT	FISCAL YEAR
	OHIO		

I.C.H. No 34 SEC. C 4th D  
LAKE COUNTY

Sta. 360+18.5  
Extend 13' to right with standard 3'x3' conc. box culvert  
9.7 cu.yds. 1-2-A concrete  
396 lbs. steel  
5 cu.yds. excavation

Sta. 371+88  
Remove west wall to old stone culvert - 10 cu.yds. stone masonry & build standard 3'x3' concrete box culvert 36' long  
16.9 cu.yds. 1-2-A concrete  
907 lbs. steel  
2 cu.yds. excavation

Sta. 386+83  
Extend 6' to right with standard 3'x3' concrete box culvert  
4.45 cu.yds. 1-2-A concrete  
175 lbs. steel  
2 cu.yds. excavation

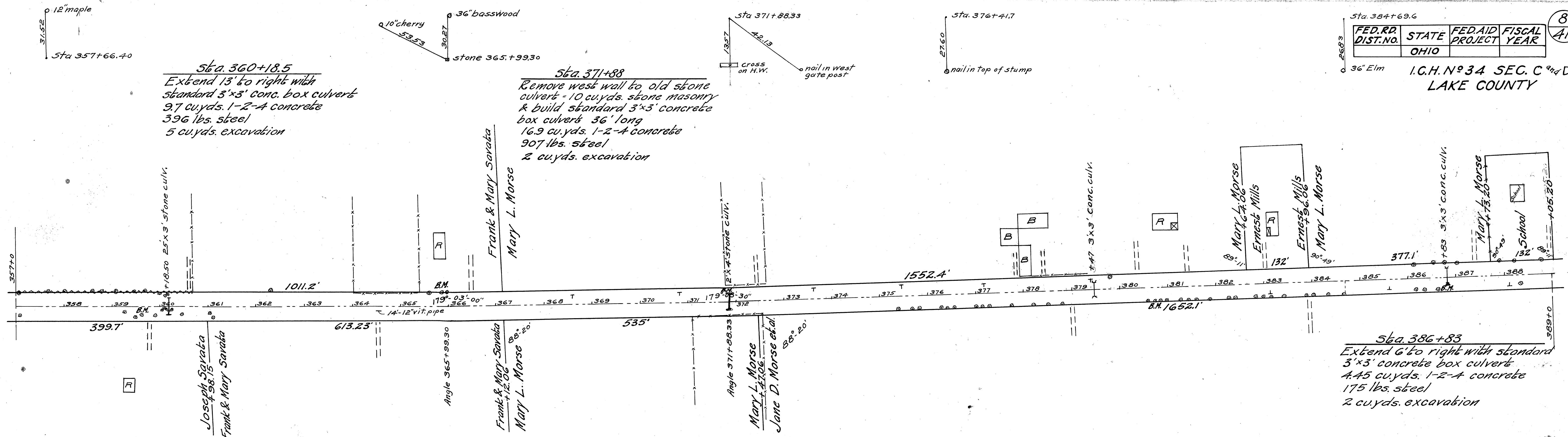

B.M. Sta. 359+63  
Spike in ash  
16' to E. of  $\Phi$   
Elev. = 1044.83

B.M. Sta. 365+88  
Spike in roof of maple  
29' to L. of  $\Phi$   
Elev. = 1069.50

B.M. Sta. 371+88  
\* on NW cor. parapet  
16' to L. of  $\Phi$   
Elev. = 1050.31

B.M. Sta. 380+72  
Spike in 12" maple  
27' to R. of  $\Phi$   
Elev. = 1062.46

B.M. Sta. 386+83  
S.W. cor. culvert  
10' to R. of  $\Phi$   
Elev. = 1061.70

