

Sta. 230+10 26'-10" Vit pipe
to be relaid in concrete. 1 headwall
18" inlet basin on right to be capped
1 cu. yd. 1-2-4 concrete
2.8 cu. yds. 1-3-6 concrete
6 cu. yds. excavation

LEFT				RIGHT			
edge of pav	width	Station	grade elev.	width	edge of pav.	Station	grade elev.
672.36	8.00	232+18.92	672.53	8.00	672.36		
672.00	8.00	232+25	672.17	8.00	672.10		
671.09	8.00	232+50	671.26	8.00	671.39		
670.46	8.00	232+68.92	670.63	8.00	670.86		
670.26	8.00	232+75	670.43	8.00	670.76		
669.50	8.00	233+00	669.67	8.00	670.20		
668.76	8.00	233+25	668.93	8.00	669.46		
668.09	8.00	233+50	668.26	8.00	668.79		
667.50	8.00	233+75	667.67	8.00	668.20		
666.99	8.00	234+00	667.16	8.00	667.69		
666.55	8.00	234+25	666.72	8.00	667.10		
666.19	8.00	234+50	666.36	8.00	666.59		
665.90	8.00	234+75	666.07	8.00	666.10		
665.65	8.00	235+00	665.82	8.00	665.65		

No extra pavement

LEFT				RIGHT			
Edge of pav	width	Station	grade elev.	width	edge of pav.	Station	grade elev.
685.23	8.00	245+50	685.15	8.00	684.98		
687.78	9.00	245+72.91	687.45	8.00	687.28		
690.73	11.00	246+00	690.15	8.60	689.98		
693.48	12.50	246+25	692.65	9.30	692.48		
695.98	13.40	246+50	695.15	9.60	694.98		
698.48	14.00	246+75	697.65	10.00	697.48		
700.98	14.00	247+00	700.15	10.00	699.98		
703.48	13.80	247+25	702.65	10.00	702.48		
705.98	13.00	247+50	705.15	9.40	704.98		
708.48	11.70	247+75	707.65	9.00	707.48		
710.68	10.00	248+00	710.15	8.30	709.98		
711.95	9.00	248+25	711.62	8.00	711.45		
712.83	8.20	248+50	712.65	8.00	712.48		

91.59 yds. extra pavement

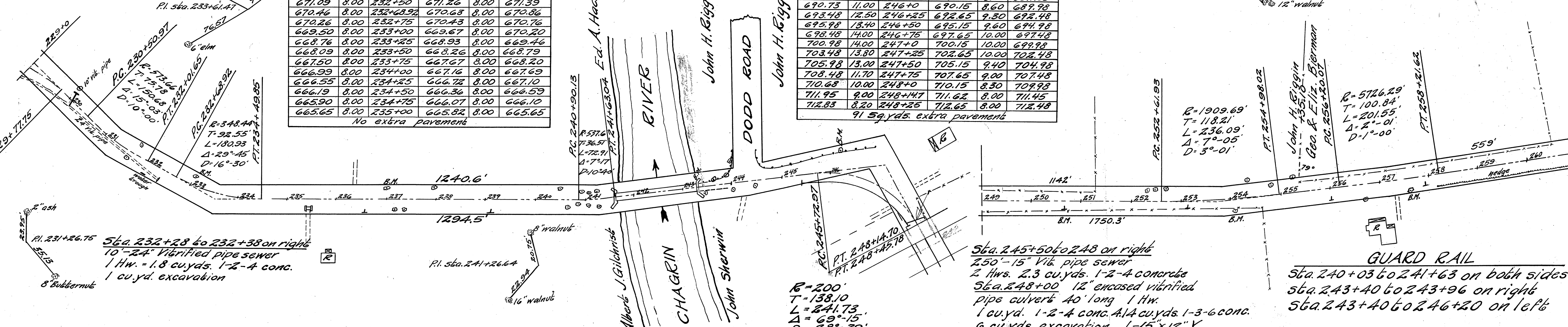

Sta. 232+28 to 232+38 on right
10'-24" Vitrified pipe sewer
1 Hw. - 1.8 cu. yds. 1-2-4 conc.
1 cu. yd. excavation

Sta. 245+50 to 248 on right
250'-15" Vit pipe sewer
2 Hws. 2.3 cu. yds. 1-2-4 concrete
Sta. 248+00 12" encased vitrified
pipe culvert 40' long 1 Hw.
1 cu. yd. 1-2-4 conc. 4.14 cu. yds. 1-3-6 conc.
6 cu. yds. excavation 1-15'x12" Y.

GUARD RAIL
Sta. 240+03 to 241+63 on both sides
Sta. 243+40 to 243+96 on right
Sta. 243+40 to 246+20 on left

B.M. Sta. 237+0
Spike in root of 46' sycamore
22' to L of E
Elev. = 663.43

B.M. Sta. 243+35
Knob on N.W. side abutment
60' L of E
Elev. = 667.42

B.M. Sta. 246+27
Spike in root of 32" walnut
17' to L of E
Elev. = 693.61

B.M. Sta. 248+09
Spike in tel. pole
15' to E of E
Elev. = 716.35

B.M. Sta. 250+65
Spike in tel. pole
11' to E of E
Elev. = 731.19

B.M. Sta. 254+06
Spike in root of 24' walnut
28' to E of E
Elev. = 758.18

B.M. Sta. 257+58
Spike in root of 20' walnut
27' to E of E
Elev. = 787.66

