

STATE OF OHIO
 DEPARTMENT OF HIGHWAYS AND PUBLIC WORKS
DIVISION OF HIGHWAYS
 BUREAU OF CONSTRUCTION

FED. RD. DIST. NO.	STATE	FED. AID PROJECT	FISCAL YEAR
	OHIO		

I.C.H. No. 34 SEC. C and D
 LAKE COUNTY
 USR-6.
276-10.31
 INDEX

EUCLID-CHARDON ROAD
 I.C.H. NO. 34 SECTIONS C and D PET. NO. 4794
LAKE COUNTY
 WILLOUGHBY & KIRTLAND TWPS. MAR. 1923

Table page	p. 1
Typical Crosssection	p. 2
Plan and Profile	p. 3-13
Cross Sections	p. 14-38
Structural Plans	p. 39
Summary Sheets	p. 40-41

The Standard Specifications of the State of Ohio, Division of Highways, in force on date of contract will govern this improvement.
 I hereby approve these plans and declare that the making of this improvement will require the closing to traffic of the highway and that detours will be provided as shown on the plan and estimate.

Approved: *Rydelthadden*
 Date, ~~May 21, 1923~~ *October 18th, 1923* Resident Engineer

Approved: *Fred E. Swineford* 10/29/23
 Date, ~~2-23-1923~~ Division Engineer

Approved: *E. Hoover* 4/7/24
 Date, ~~5/25/23~~ State Highway Engineer 2/8/24

Approved: *Leon C. Glensick* 2/8/24
 Date, ~~3/28/23~~ Director of Highways and Public Works 2/8/24

Recommended for Approval: _____
 Date _____ District Engineer
 Bureau of Public Roads

Recommended for Approval: _____
 Date _____ Chief Engineer
 Bureau of Public Roads

Approved: _____
 Date _____ Chief of Bureau



CONVENTIONAL SIGNS

State line	-----
County line	-----
Township line	-----
Section line	-----
Property line not fenced	-----
Center line	-----
City or Village line	-----
Fence	-----
Telephone or Telegraph	TTTTTTTT
Steam railroad	-----
Electric line	-----

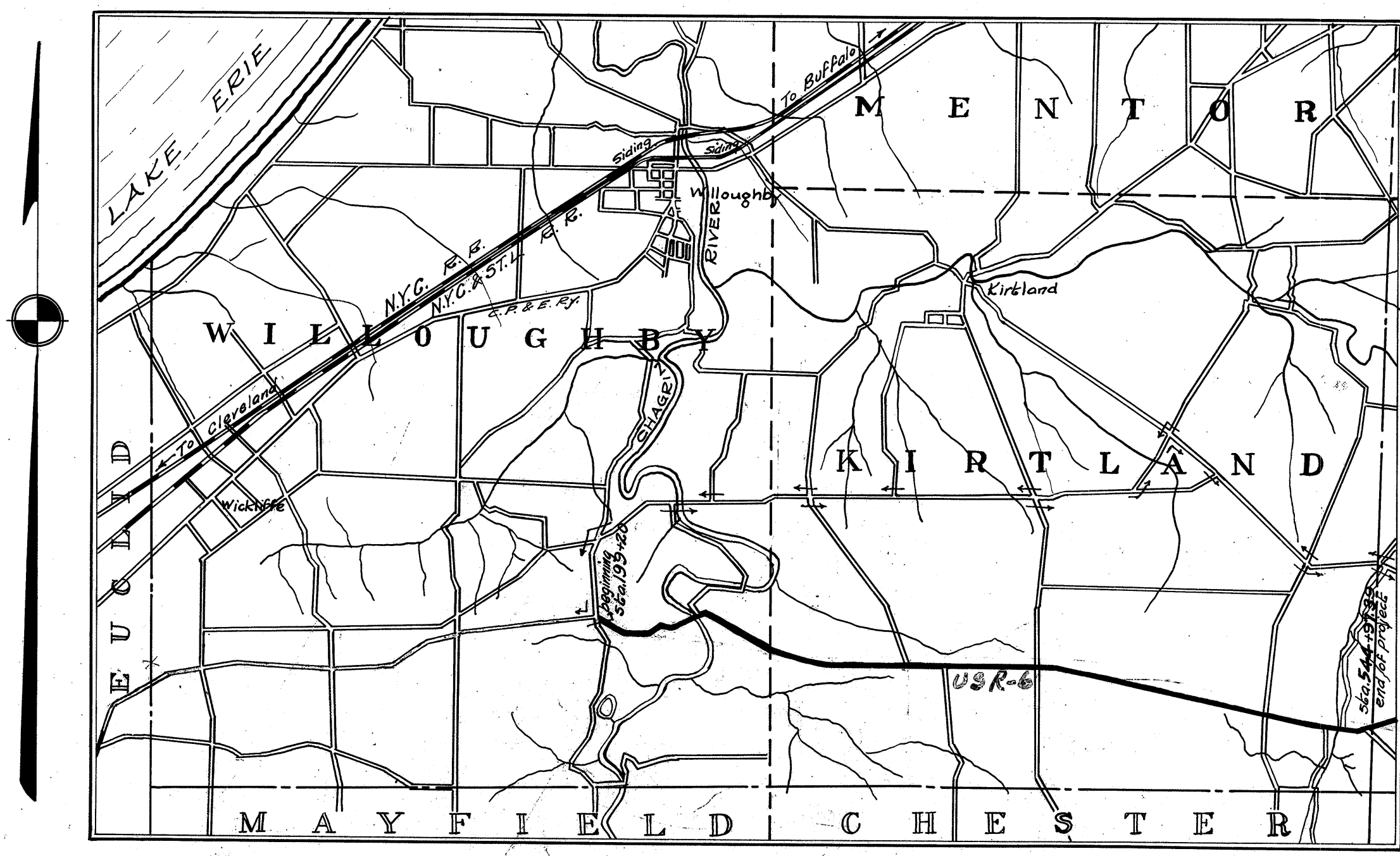

LOCATION PLAN

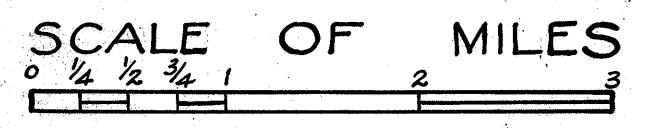

PORTION TO BE IMPROVED
 DETOURS SHOWN THUS

SCALES

Plan 1" = 100'
 Profile (Vertical) 1" = 10'
 Profile (Horizontal) 1" = 100'
 Cross-sections 1" = 5'

We, the Commissioners of Lake County hereby approve these plans and certify that the right of way 60' wide is available for the construction, maintenance & repair of the above highway

W. E. Thompson
H. J. Wright

Date, ~~May 21, 1923~~ *October 18th, 1923* County Commissioners