

I. C. H. No. 34 SEC. A & B
LAKE COUNTY

SUMMARY OF QUANTITIES

23745 sq. yds. 9'-7"x9' 1-2-3 conc. pavement
19900 lin. ft. finishing berm (both sides)
1028 sq. yds. 6" conc. par. to be removed (on curves)
4540 cu. yds. excavation
57 cu. yds. 1-4-7 concrete (to superelevate curves)
Replacement: 1000 sq. yds. 9'-7"x1-2-3 conc. 1000 sq. yds. old pav. to be removed

Summary of pav. removed		Summary of extra pavement		pavement deducted	
Station	For	Station	For	Station	For
5+71	curve	5+71	curve	22+64	Intersection
40+29	curve	40+29	curve	137+32	"
123+27	curve	123+27	curve		
		198+35	Intersection		
Total	1028	Total	1816	Deduct	182

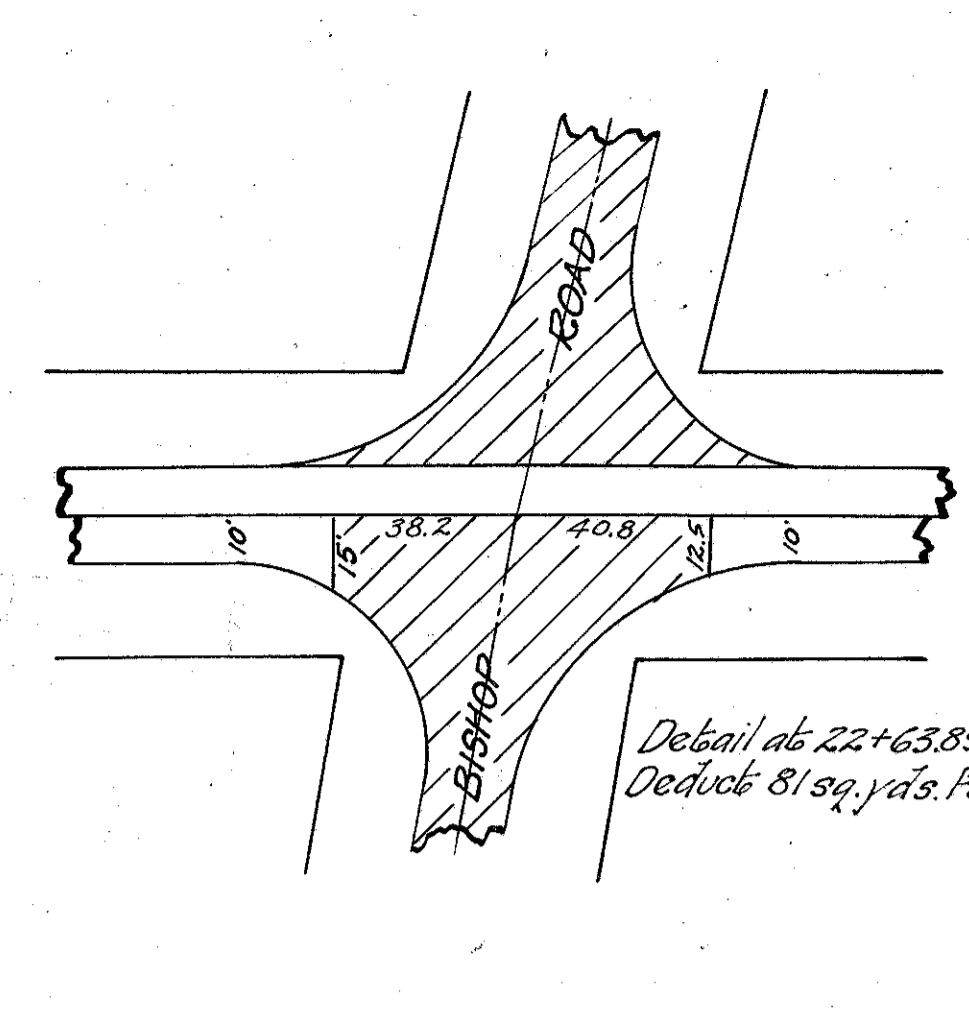
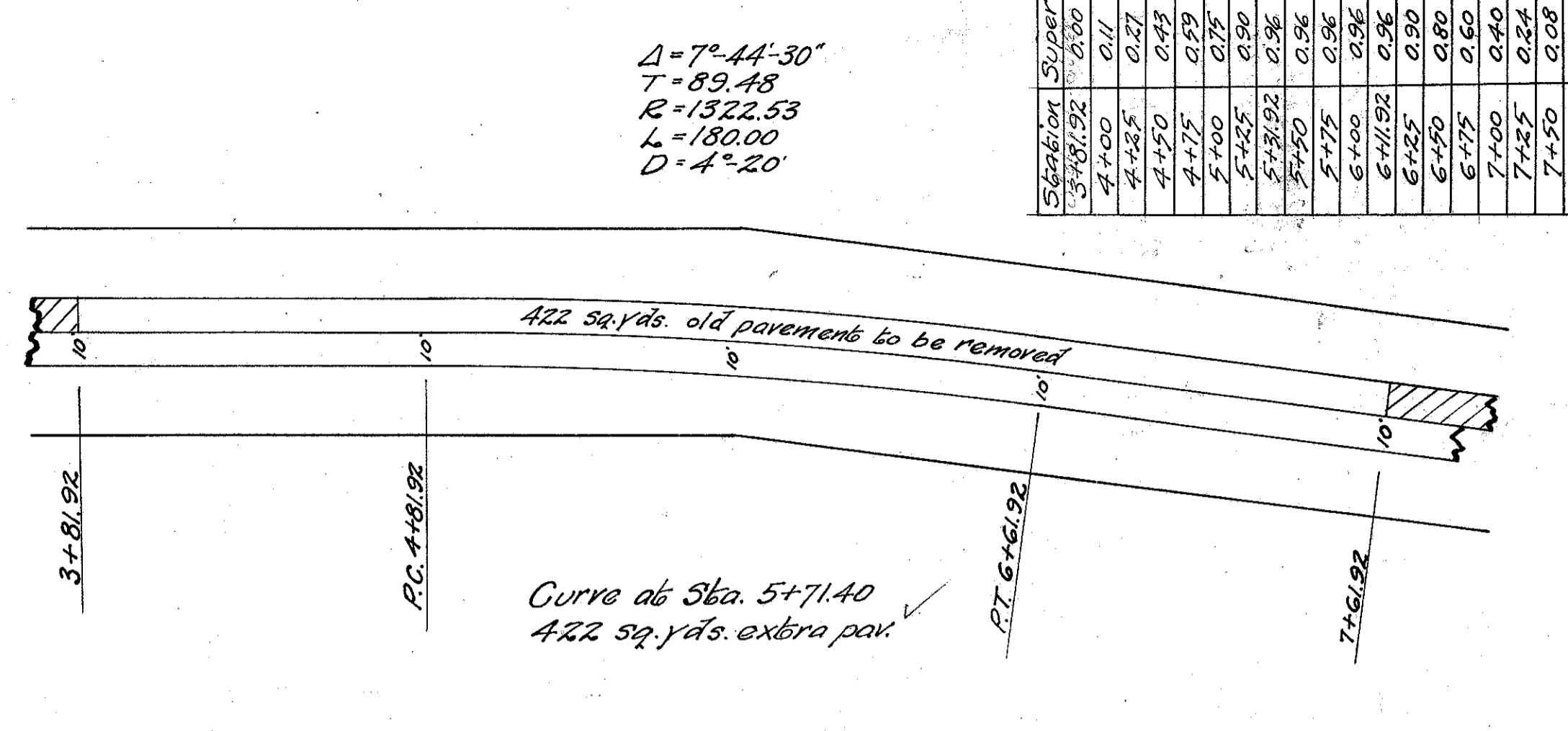
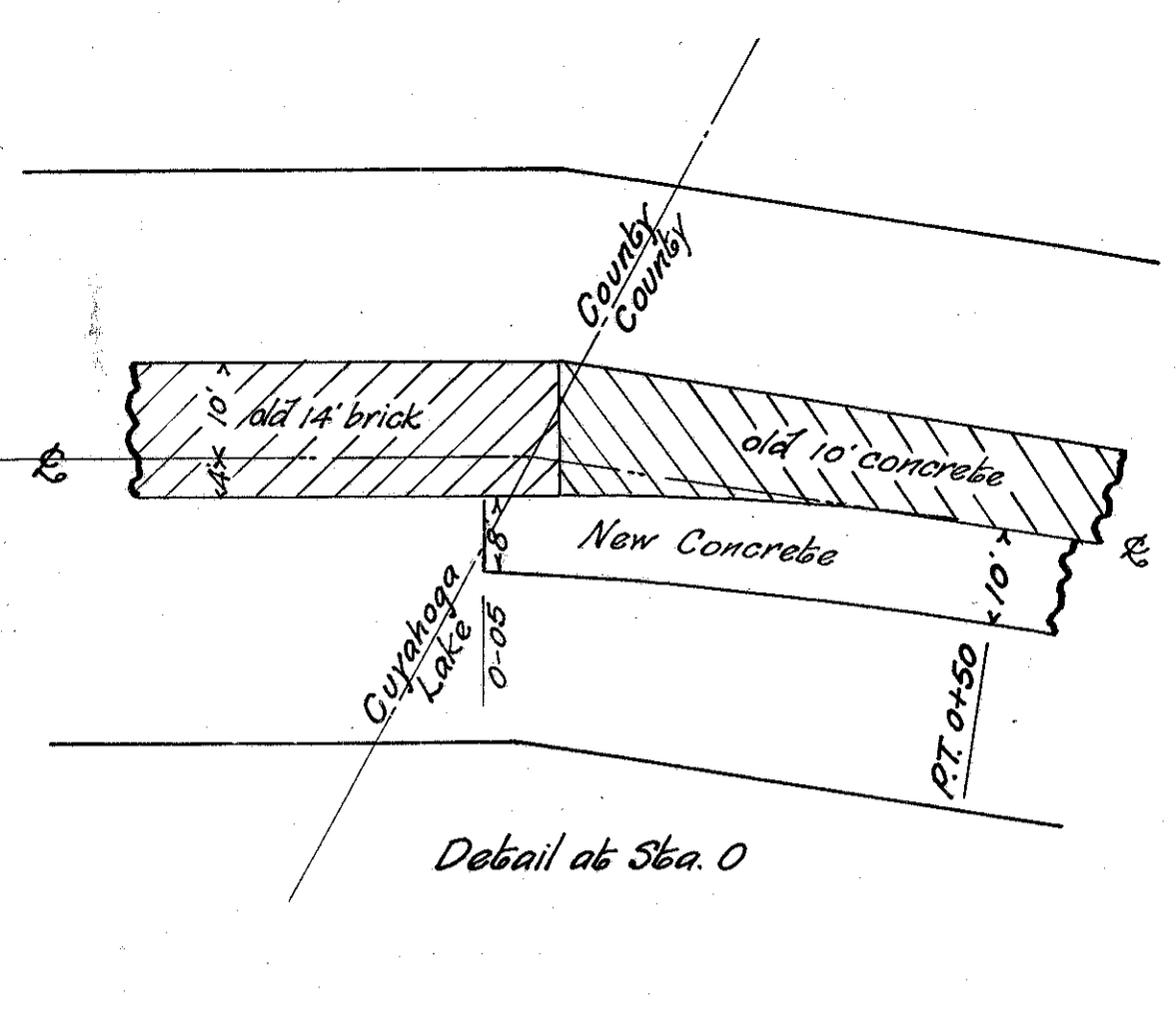

Station	Super Elevation
3+81.92	0.00
4+00	0.11
4+25	0.27
4+50	0.43
4+75	0.59
5+00	0.75
5+25	0.90
5+50	0.96
5+75	0.96
6+00	0.96
6+25	0.90
6+50	0.80
6+75	0.60
7+00	0.40
7+25	0.24
7+50	0.08
7+61.92	0.00

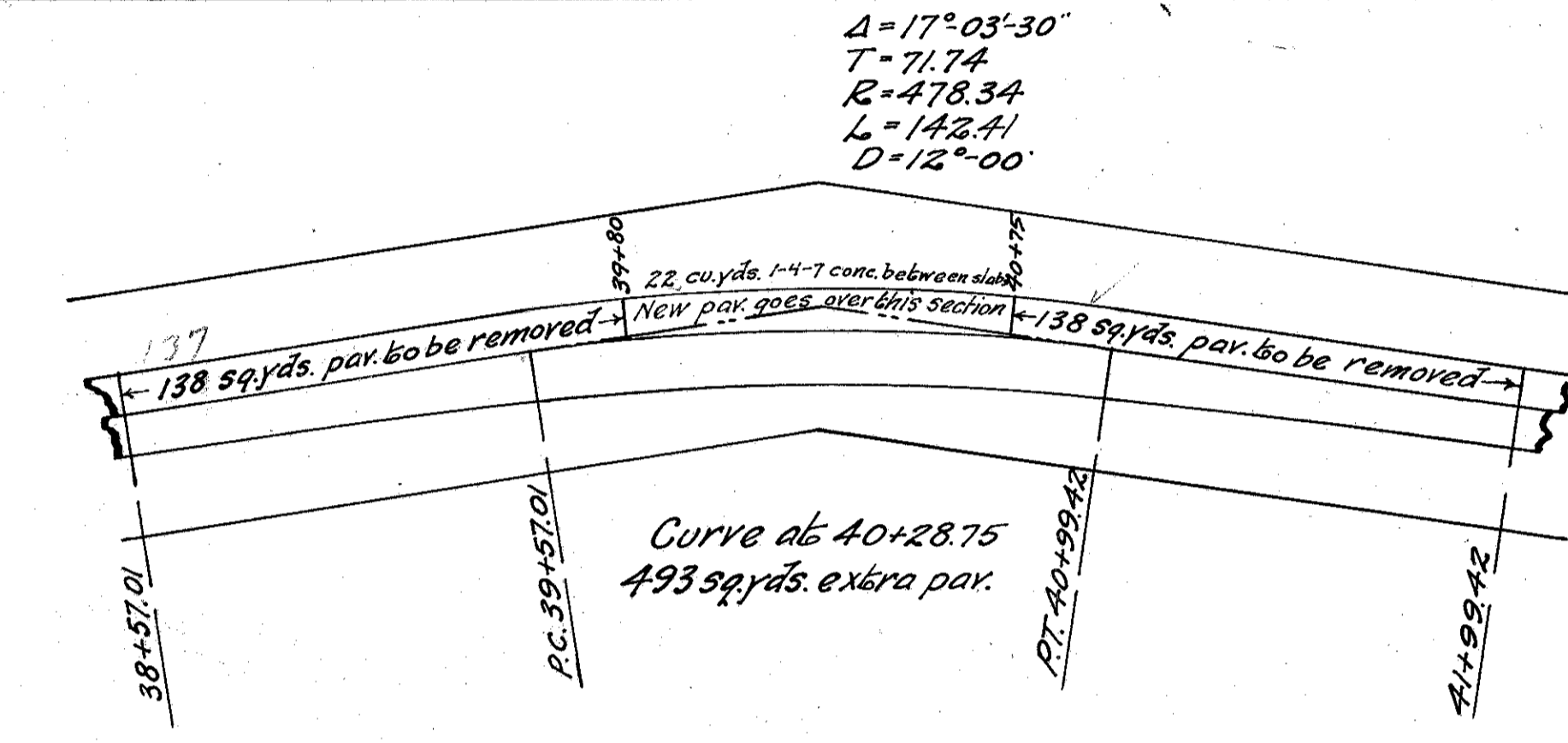

Station	Extra Width	Super Elevation
38+57.01	0.00	0.00
38+75	0.09	0.20
39+00	0.47	0.48
39+25	1.17	0.76
39+50	2.19	1.04
39+75	2.57	1.12
40+00	3.23	1.32
40+25	3.70	1.60
40+50	3.75	1.68
40+75	3.75	1.68
41+00	3.75	1.68
41+25	3.41	1.40
41+50	2.57	1.12
41+75	1.42	0.84
41+99.42	0.63	0.56
41+99.42	0.15	0.28
41+99.42	0.00	0.00

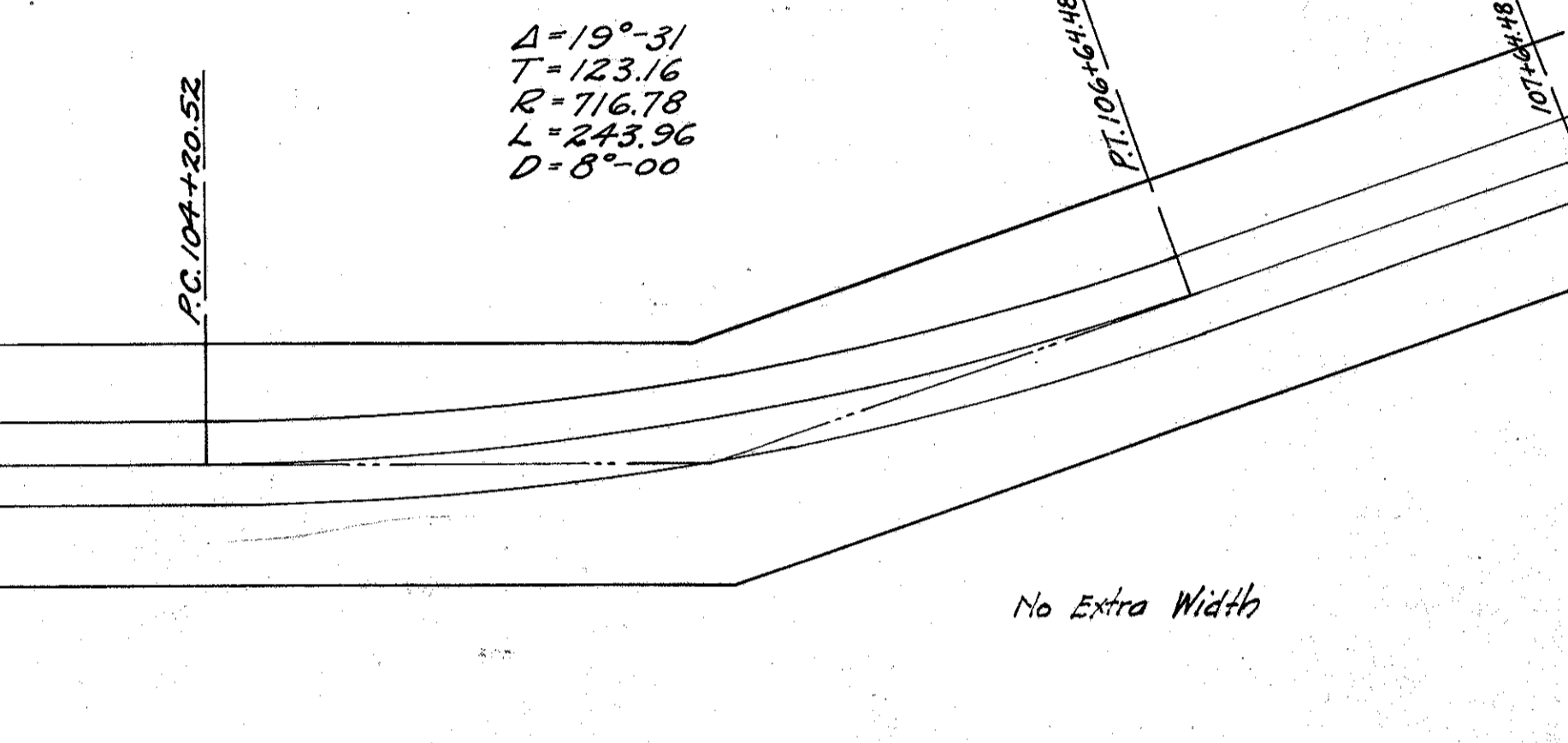
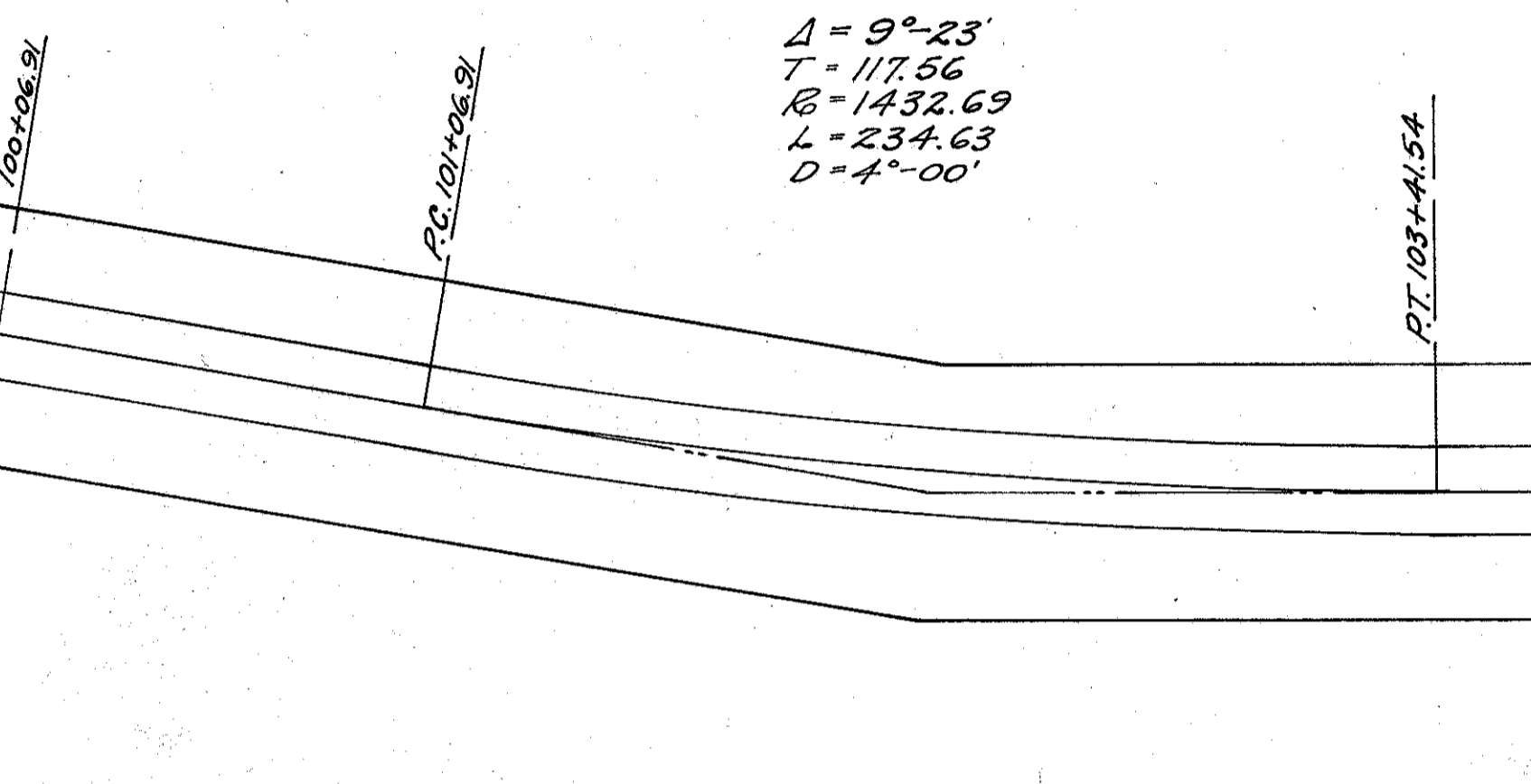

Station	Super for new 10' on R.
100+06.91	0.00
100+25	0.03
100+50	0.13
100+75	0.20
101+00	0.28
101+25	0.36
101+50	0.43
101+56.91	0.45
101+75	0.45
102+00	0.45
102+25	0.45
102+50	0.45
102+91.54	0.45
103+00	0.45
103+25	0.36
103+41.54	0.30
103+50	0.35
103+75	0.45
103+81.03	0.50
104+00	0.52
104+20.57	0.54
104+25	0.57
104+50	0.58
104+75	0.61
105+00	0.65
105+25	0.65
105+50	0.65
105+75	0.65
106+00	0.65
106+41.48	0.65
106+25	0.60
106+50	0.48
106+62.48	0.44
106+75	0.38
107+00	0.27
107+25	0.16
107+50	0.06
107+64	0.00

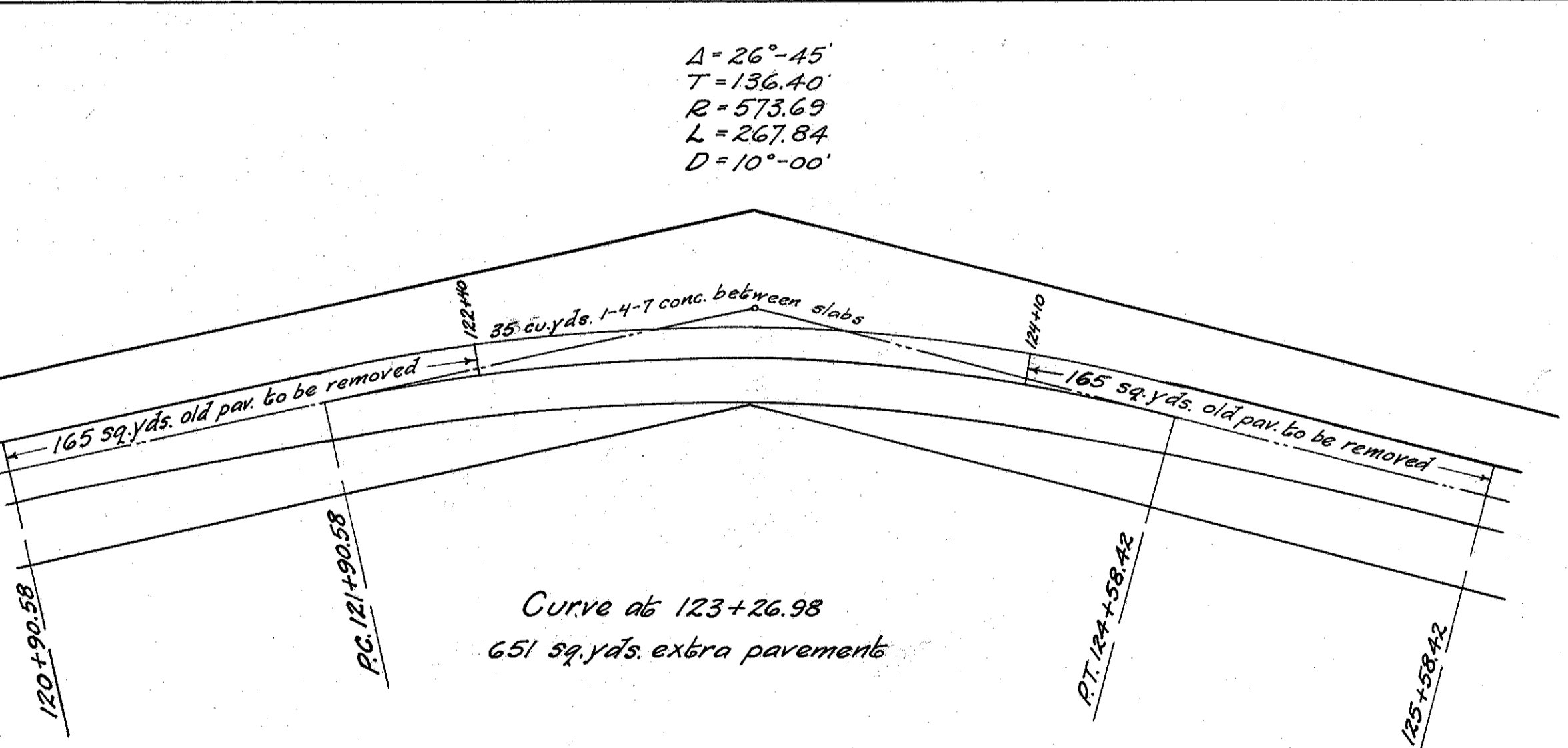

Station	Extra Width	Super Elevation
120+90.58	0.00	0.00
121+00	0.02	0.10
121+25	0.27	0.36
121+50	0.77	0.65
121+75	1.56	0.88
121+90.58	2.15	1.05
122+00	2.51	1.18
122+25	3.11	1.41
122+50	3.25	1.58
122+75	3.25	1.58
123+00	3.25	1.58
123+25	3.25	1.58
123+50	3.25	1.58
123+75	3.25	1.58
124+00	3.25	1.58
124+25	3.09	1.40
124+50	2.47	1.14
124+58.42	2.15	1.05
124+75	1.56	0.87
125+00	0.77	0.61
125+25	0.27	0.35
125+50	0.02	0.09
125+58.42	0.00	0.00

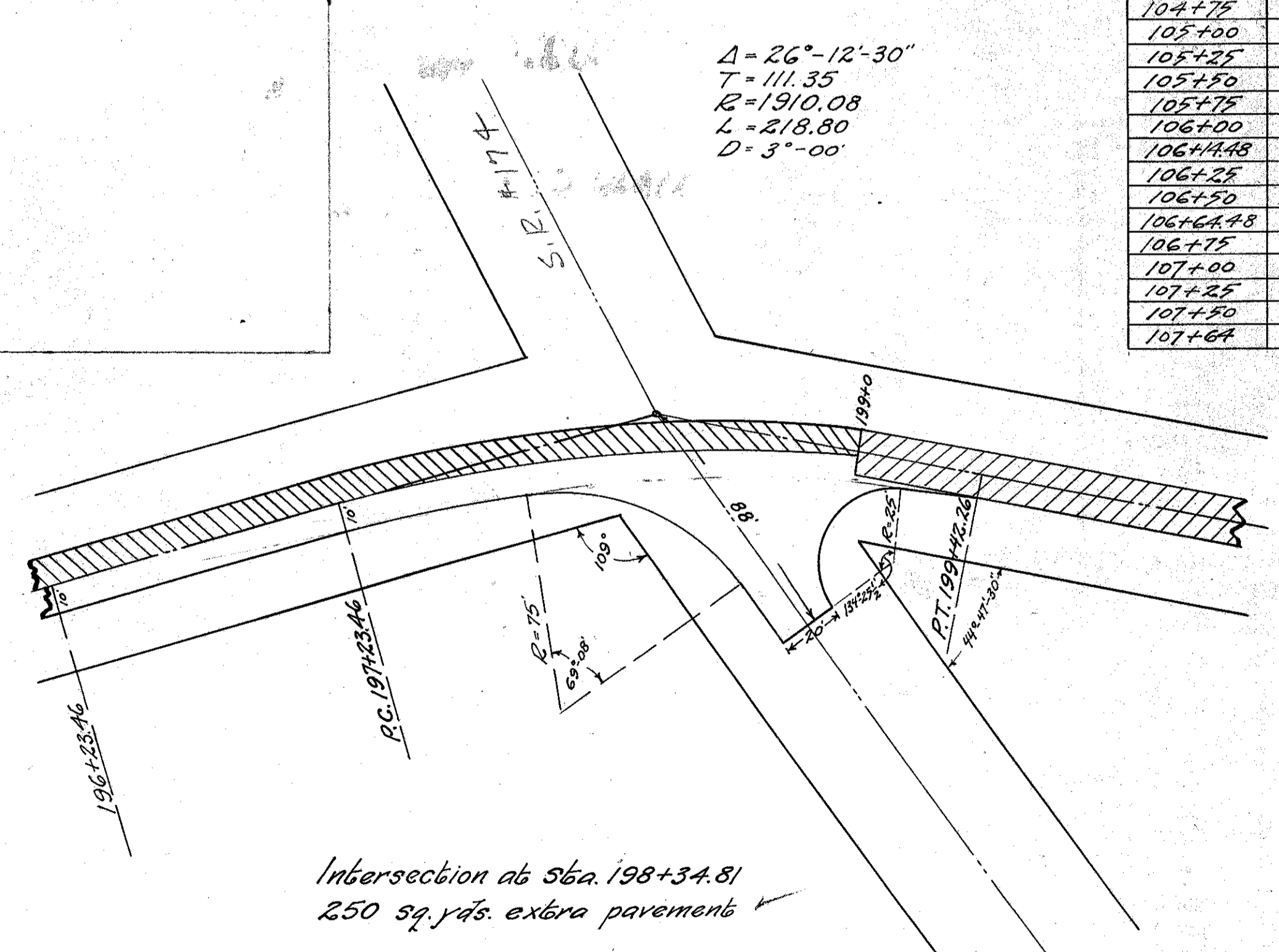
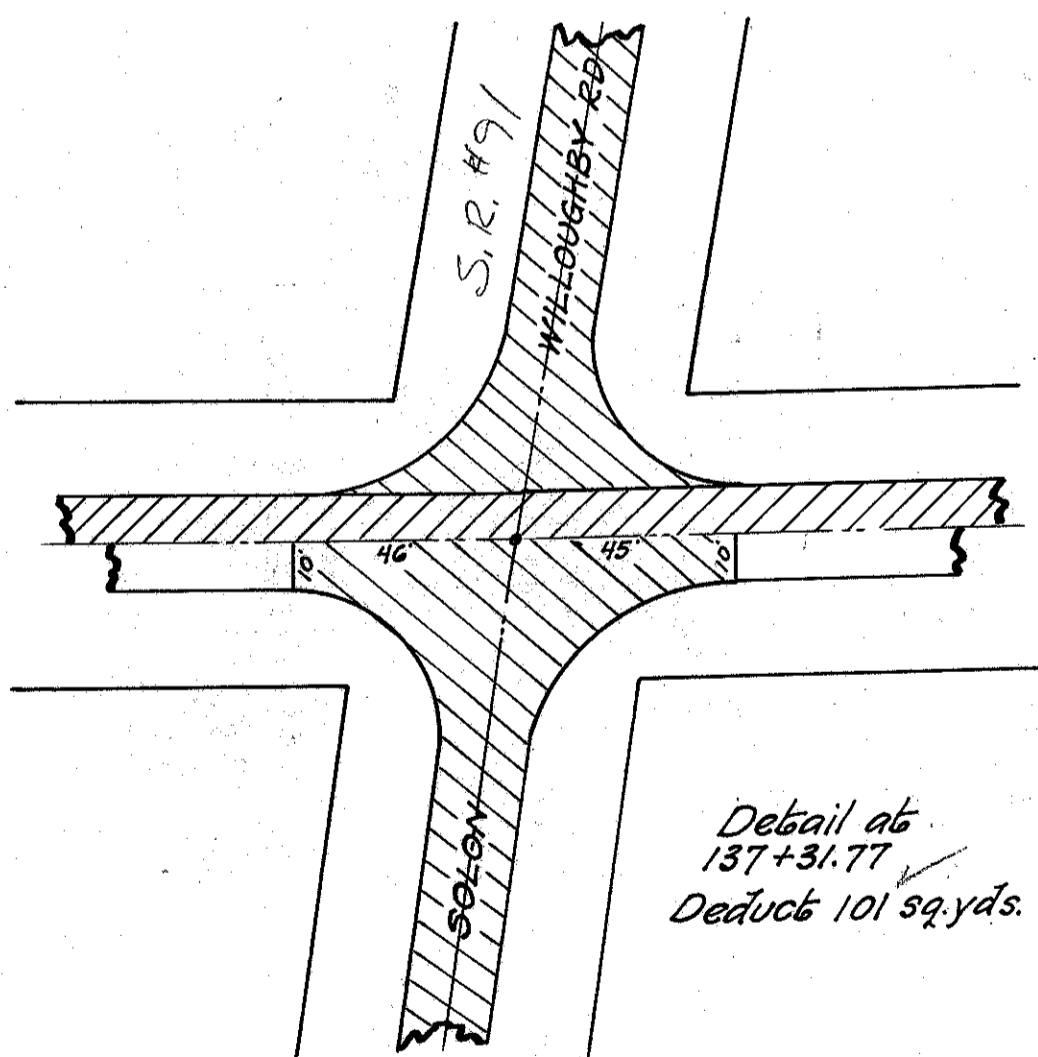

Intersection at Sta. 198+34.81
250 sq. yds. extra pavement