

DATE: _____ BY: _____
 REVISIONS: _____
 DRAWING NO. _____
 PROJECT NO. _____
 SHEET NO. _____

DATE: _____ BY: _____
 REVISIONS: _____
 DRAWING NO. _____
 PROJECT NO. _____
 SHEET NO. _____

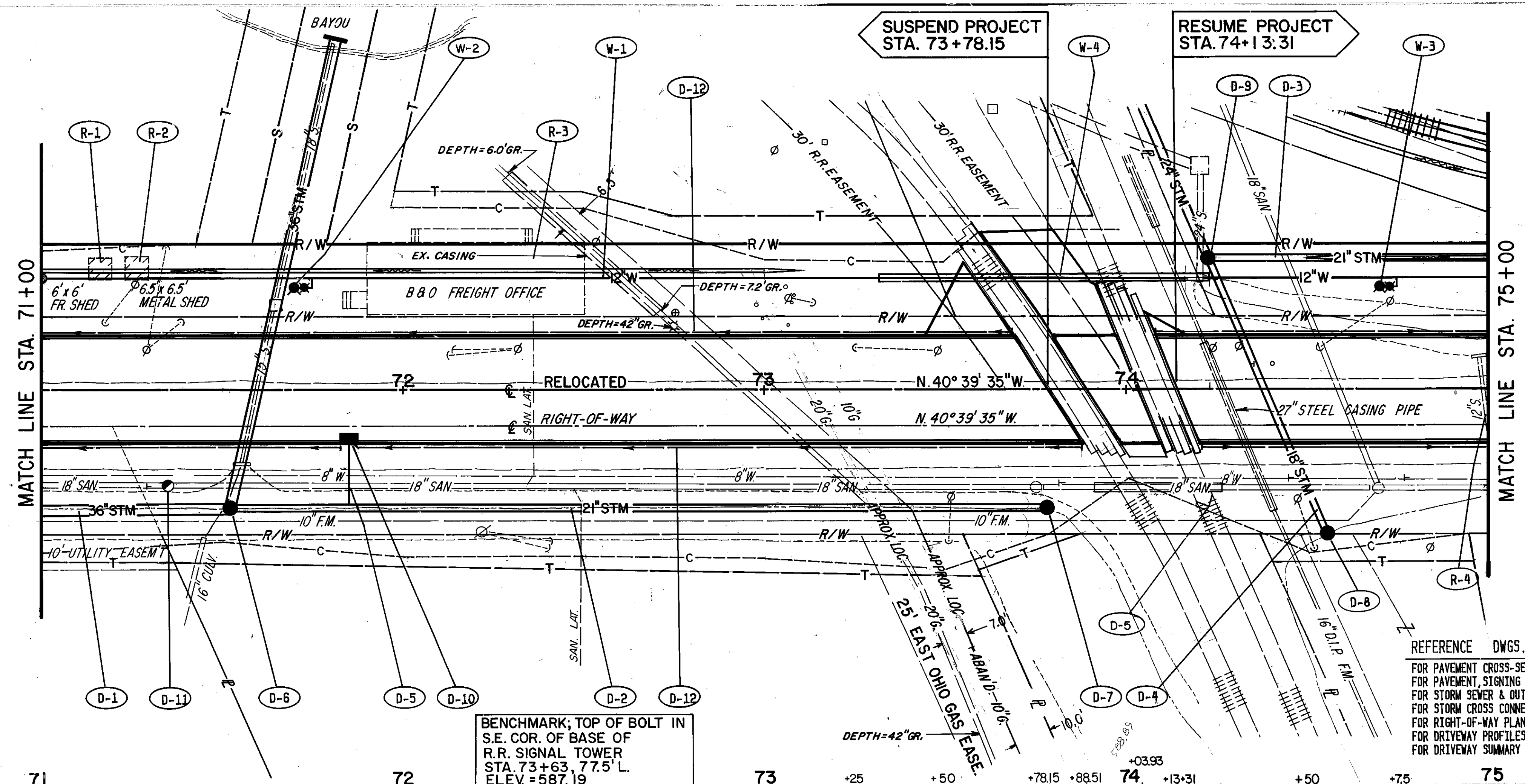

REF	LOCATION	LF.	EA.	LF.	EA.	LF.	EA.	LF.	EA.	LF.	EA.	LF.	EA.	LF.	EA.	TOTALS							
603	6" SHALLOW PIPE UNDERDRAIN AS PER PL.															269							
604	MANHOLE ADJUSTED TO GRADE															93							
604	CATCH BASIN STD NO. 5															278							
604	CATCH BASIN STD NO. 3 MOD AS PER PLAN															81							
604	MANHOLE STD NO. 3																						
603	6" CONDUIT TYPE F, AS PER PLAN																						
603	12" CONDUIT TYPE C, AS PER PLAN																						
603	18" CONDUIT TYPE B, AS PER PLAN																						
603	21" CONDUIT TYPE C, AS PER PLAN																						
603	36" CONDUIT TYPE C, AS PER PLAN																						
52		52														52							
TOTALS															52	303	83	19.5	10	2	1	1	721

REFERENCE DWGS.
 FOR PAVEMENT CROSS-SECTIONS 65-68
 FOR PAVEMENT, SIGNING & STRIPING PLANS 137
 FOR STORM SEWER & OUTLET PROFILES 150, 157, 158
 FOR STORM CROSS CONNECTION DETAILS 165
 FOR RIGHT-OF-WAY PLANS 204-205
 FOR DRIVEWAY PROFILES 107
 FOR DRIVEWAY SUMMARY & CONSTRUCTION DETAILS 132

REF	LOCATION	SH'T NO.
D-1	71+00 - 71+52, 33'R.	65-68
D-2	71+52 - 73+78, 33'R.	137
D-3	74+22.79 - 75+00, 36'L.	150, 157, 158
D-4	74+22.79 - 75+00, 36'L.	165
D-5	71+00 - 74+55.5, 40'R.	204-205
D-6	71+00 - 73+78, 33'R.	107
D-7	73+78, 33'R.	132
D-8	74+55.5, 40'R.	
D-9	74+22.79, 36'L.	
D-10	71+00 - 73+78, 33'R.	
D-11	71+35, 26.8'R. (SANITARY)	
D-12	71+00 - 73+68.65, LT.	
	74+07.25 - 75+00, LT.	
	71+00 - 73+87.65, RT.	
	74+19.37 - 75+00, RT.	

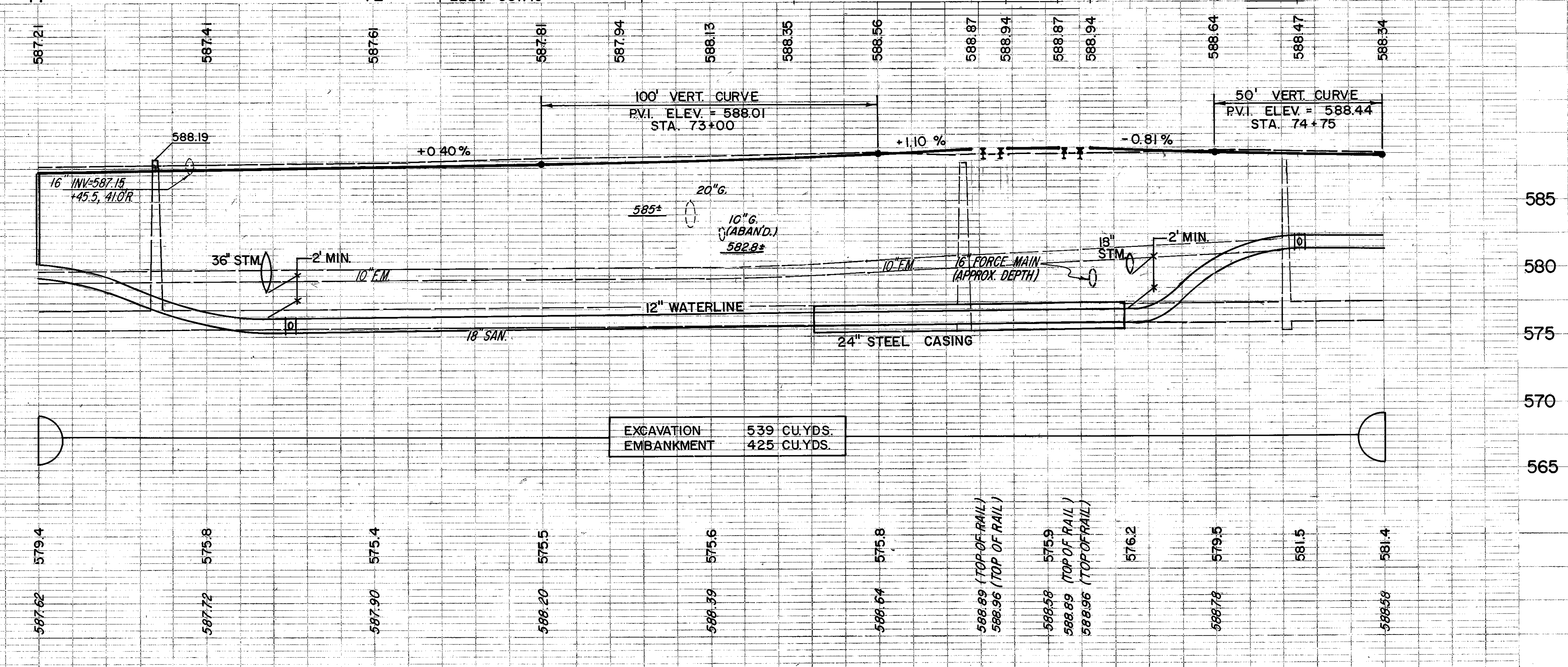

EXCAVATION 539 CU.YDS.
 EMBANKMENT 425 CU.YDS.

REF	LOCATION	202	202	202	202
R-1	71+15, 30'L.				
R-2	71+25, 30'L.				
R-3	71+90 - 72+50, 21'L.				
R-4	74+97, 9.5'L. - 75+00, 16'R.				
TOTALS		LUMP	LUMP	LUMP	25

REF	LOCATION	12" CL. 52 D.I. PIPE AND CI. FITTINGS	6" HYDRANT ASSEMBLY TYPE B	24" STEEL CASING W/ 0.500" WALL THICKNESS
W-1	71+00 - 75+00	400		
W-2	71+75, 30.5'L.		1	
W-3	74+75, 30.5'L.		1	
W-4	73+31 - 74+23			92
TOTALS		400	2	92