

PAINESVILLE TWP.  
 CITY OF PAINESVILLE

BEGIN PROJECT STA. 27+55

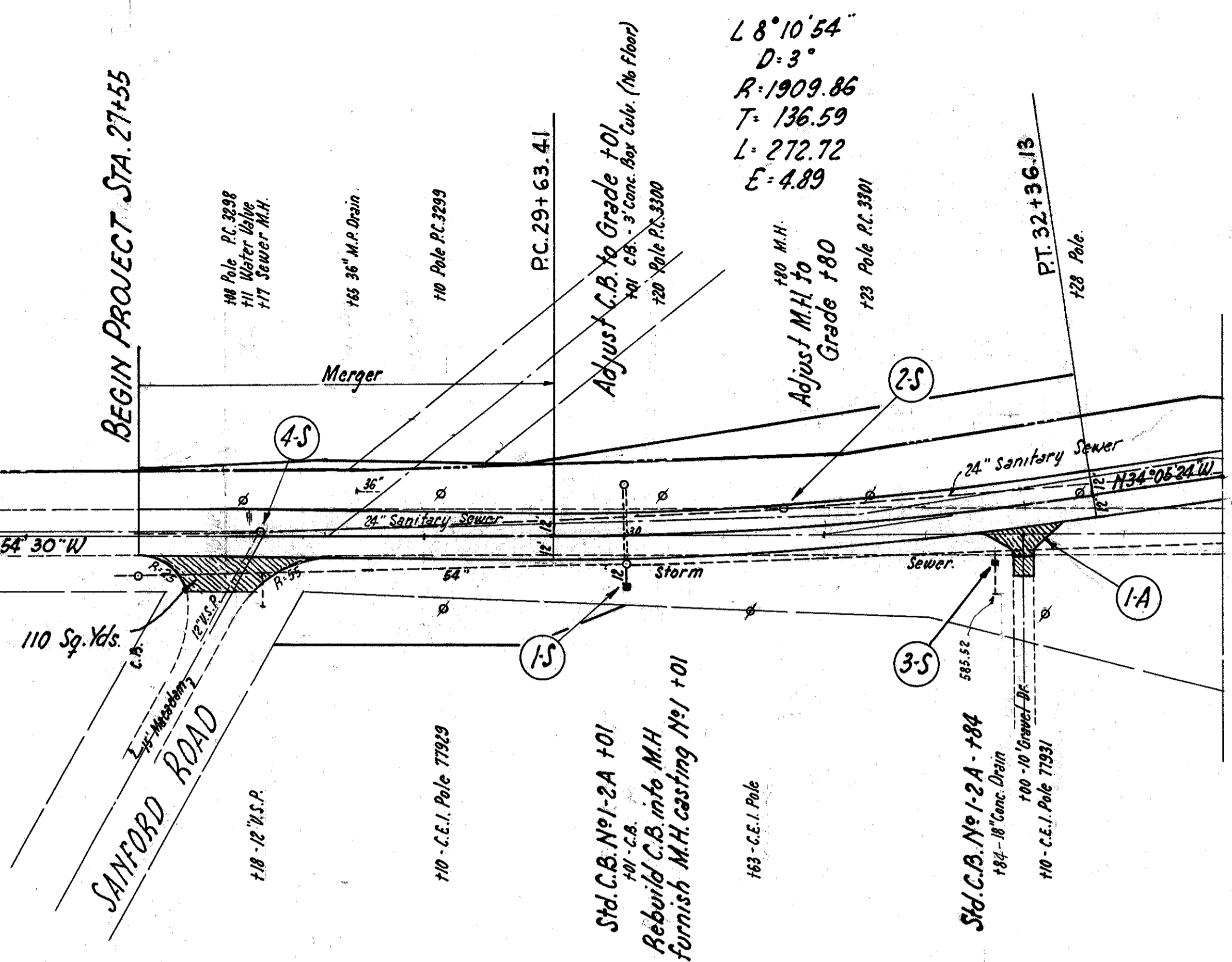

$L = 8^{\circ}10'54''$   
 $D = 3'$   
 $R = 1909.86$   
 $T = 136.59$   
 $L = 272.72$   
 $E = 4.89$

21 22 23 24 25 26 27 28 29 30 31 32 33

SEWERS.						
Item No	Station	Side	Std. C.B. No. 1'-4"	Adjust. C.B. to Grade	Adjust. M.H. to Grade	12" Pipe for Storm Sewer
1-S	30+01	RorL	Each	Each	Each	10
2-S	30+20	L	1	1	1	
3-S	31+24	R	1			
4-S	28+17	L			1	
Total			2	1	2*	10

\* Note: - The two manholes to be adjusted to grade are sanitary manholes in the City of Painesville.

**EXTRA AREA**

Asphaltic Concrete Surface Course	T-35	110 Sq. Yds.
Asphaltic Concrete Leveling Course	B-35	110 Sq. Yds.
Asphaltic Concrete Base Course	B-35	110 Sq. Yds.
Crushed Aggregate Base Course	B-119	119 Sq. Yds.
Sub Base	1-22	119 Sq. Yds.
Excavation		60 Cu. Yds.

**DRIVE**

1-A

Crushed Aggregate for Drives	B-119	44 Sq. Yds.
Asphaltic Concrete Surface Course	T-35	44 Sq. Yds.
Excavation		9 Cu. Yds.

REMOVAL & DISPOSAL OF EXISTING PAVEMENT = 1563 SQ. YDS.

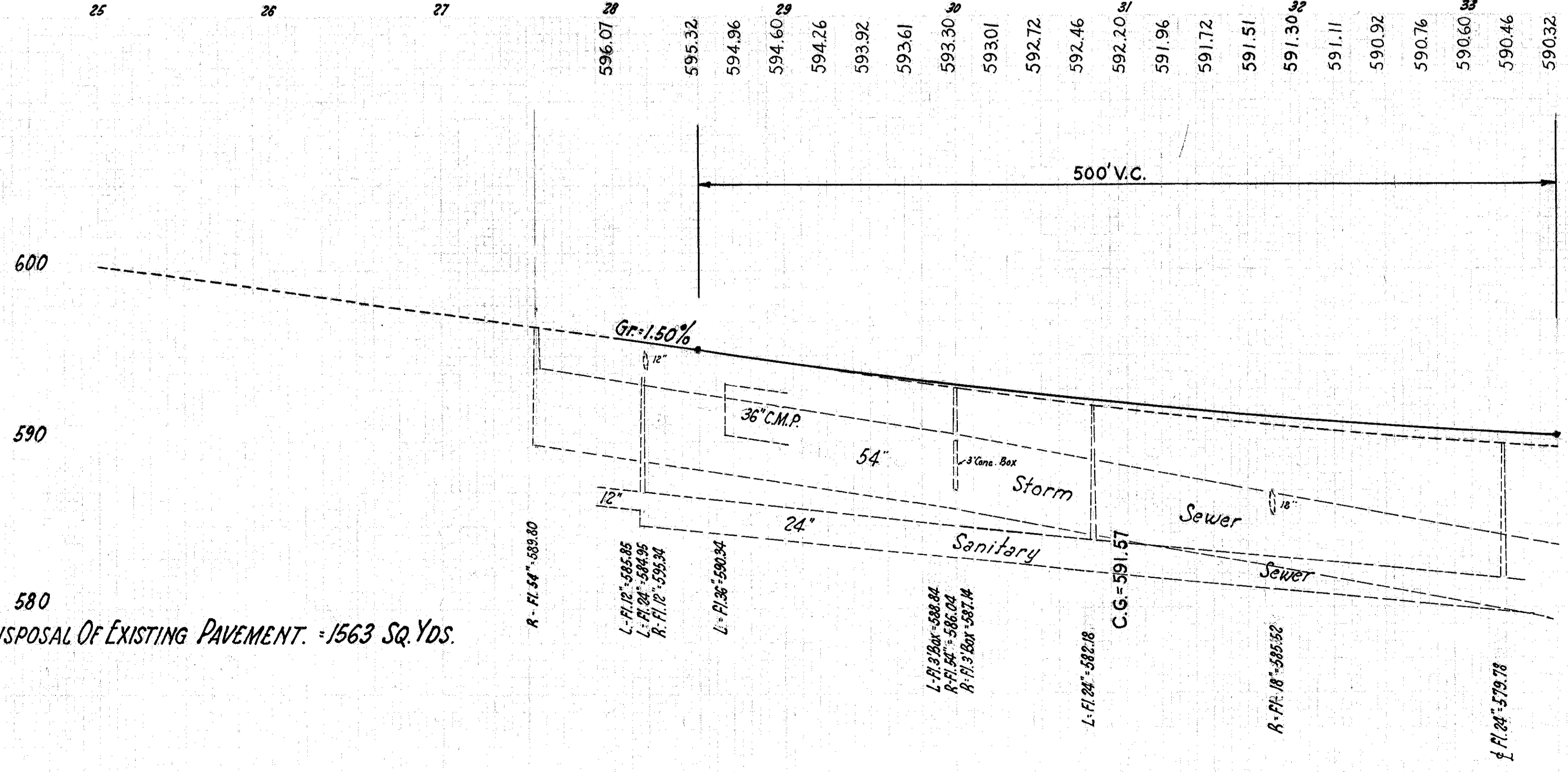

Stations	SUPERELEVATION Elevations	
	Left Edge	Right Edge
28+00	595.69	596.07
28+50	594.94	595.32
28+75	594.55	594.96
29+00	594.16	594.60
29+25	593.77	594.26
29+50	593.38	593.92
29+75	592.99	593.61
30+00	592.60	593.30
30+25	592.24	593.01
30+50	591.95	592.72
30+75	591.69	592.46
31+00	591.43	592.20
31+25	591.19	591.96
31+50	590.95	591.72
31+75	590.72	591.51
32+00	590.53	591.30
32+25	590.35	591.11
32+50	590.24	590.92
32+75	590.17	590.76
33+00	590.09	590.60
33+25	590.02	590.46
33+50	589.94	590.32