

LAKE COUNTY
S.H. 520 SEC. PAINESVILLE (PT.)
S.H. 744 SEC. PAINESVILLE (PT.)
& FAIRPORT (PT.)

PAINESVILLE TOWNSHIP

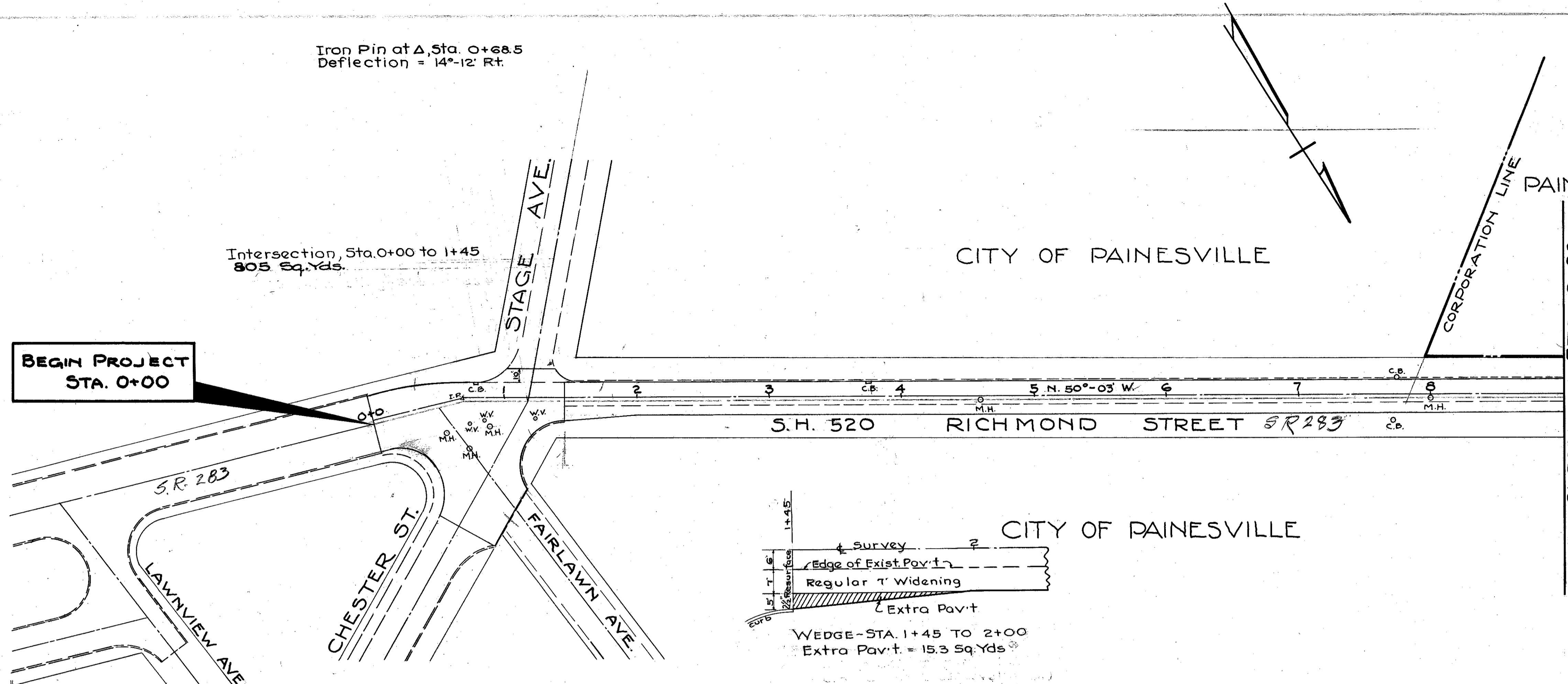

Iron Pin at Δ Sta. 0+68.5
Deflection = 14°-12' Rt.

**BEGIN PROJECT
STA. 0+00**

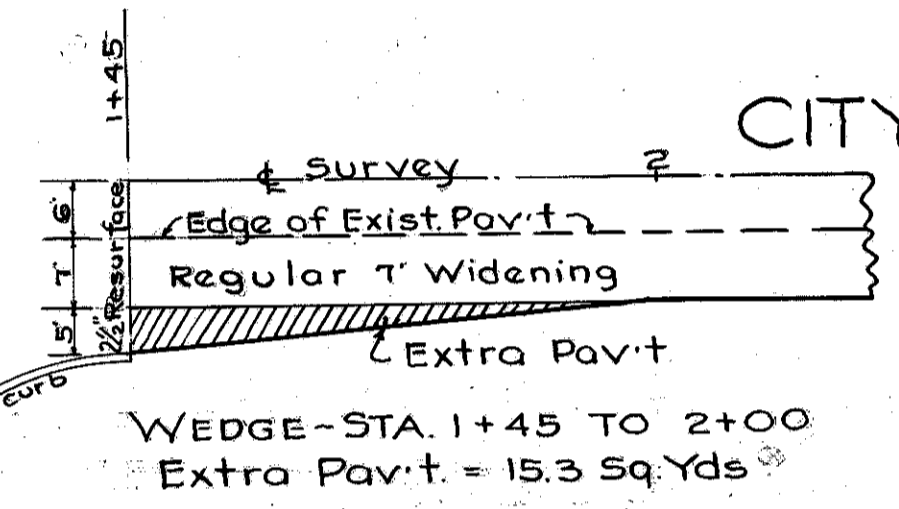

RESET TO GRADE					
Station	Side	Distance	M.H.	C.B.	W.V.
0+52	Rt	22			
0+75	Rt	39			
0+75	Rt	18			
0+81	Lt	10.5			
0+85	Rt	16.5			
0+89	Rt	22			
1+24	Rt	15			
3+75	Lt	11.5			
4+61	Rt	2			
7+72	Rt	19			
7+75	Lt	12			
8+00	℄	-			
Total			5	4	3

SEALING ONLY EDGE OF EXIST. PAV'T			
Station To	Station	Side	Lin. Ft.
1+45	0+00	Rt.	755
Total			755

B.M. No 1 U.S.G.S. Marker at B.&O. Freight Station Elev. 643.273

B.M. No 2 Spike S.E. Root Popular 50' on W. Sta. 0-5 Elev. 637.073

B.M. No 3 Spike E. Root 26' Maple At 577 Richmond St. Elev. 632.133

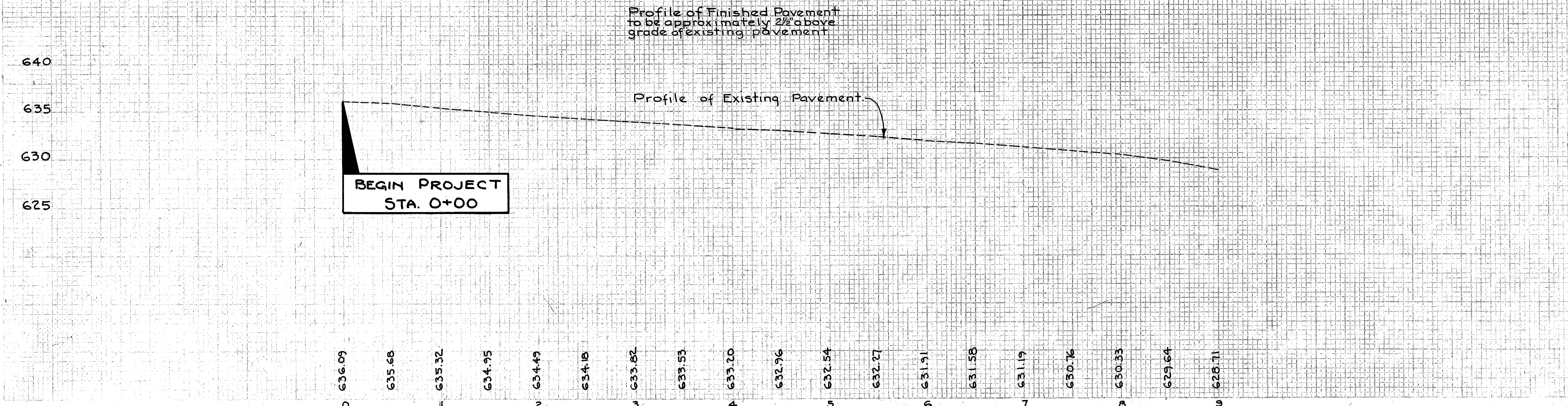

PLAN & PROFILE STA. 0+00 TO STA. 9+00