

**REBAR SCHEDULE**



**ABUTMENTS**

MARK	NUMBER			LENGTH (mm)	WEIGHT (kg)	TYPE	A	B	C	D	SERIES INC. (mm)
	REAR ABUT.	FWD. ABUT.	TOTAL								
A15M01	4	4	8	7660	96	STR*					
A15M02	4	4	8	7500	94	STR*					
A15M03	4	4	8	3200	40	STR					
A15M04	2-SER. OF 25	2-SER. OF 25	4-SER. OF 25	1365 TO 1605	5850	7	360 TO 480	255 TO 375			5
A15M05	22	22	44	1110	77	1	250	900			
A15M06	20	20	40	350	22	STR					
A25M01	20	20	40	1535	241	5	960	305			
ABUTMENT SUBTOTAL =					6420						

**SUPERSTRUCTURE**

MARK	NUMBER			LENGTH (mm)	WEIGHT (kg)	TYPE	A	B	C	D	SERIES INC.
			TOTAL								
S15M01			50	3485	274	1	3225				
S15M02			20	5600	176	STR					
S15M03			50	1045	82	2	600	225			
S15M04			50	605	45	1	345				
S15M05			14	1910	42	6	762	203			
S20M01			36	5600	475	STR					
S20M02			25	7445	438	STR *					
S20M03			25	7420	437	STR *					
SUPERSTRUCTURE SUBTOTAL =					1969						

**RAILING \*\***

MARK	NUMBER			LENGTH (mm)	WEIGHT (kg)	TYPE	A	B	C	D	SERIES INC.
			TOTAL								
R15M01			16	991	25	3	457	165			
R15M02			8	2007	25	4					
R15M03			8	2718	34	2	1067	1422			
R15M04			16	2515	63	6	1067	203			
R15M05			8	1420	18	STR					
R15M06			8	5600	72	STR					
RAILING TOTAL ** =					237						

\*\* TO BE INCLUDED WITH ITEM 517, RAILING, FOR PAYMENT

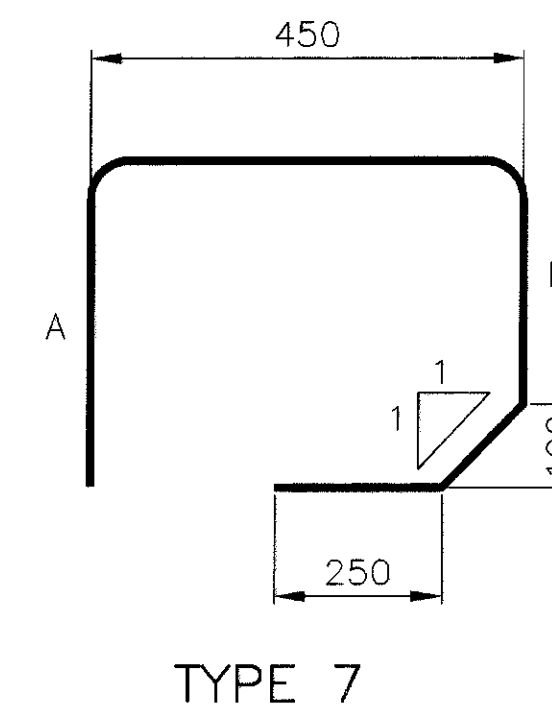
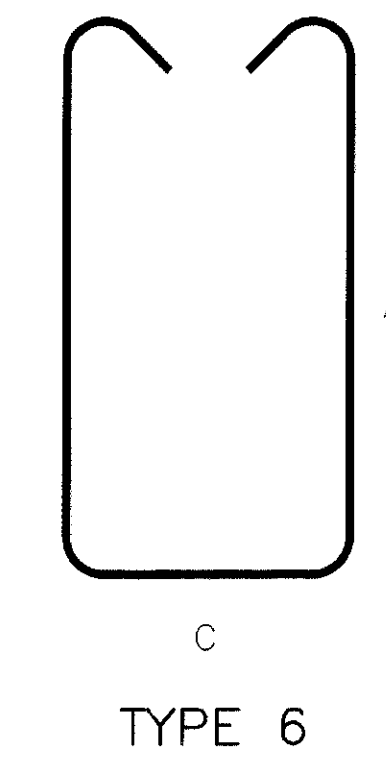
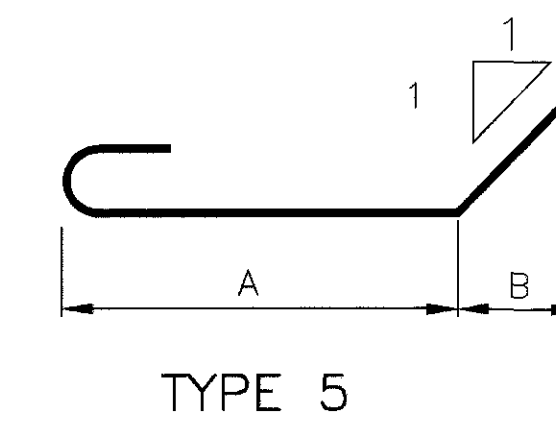
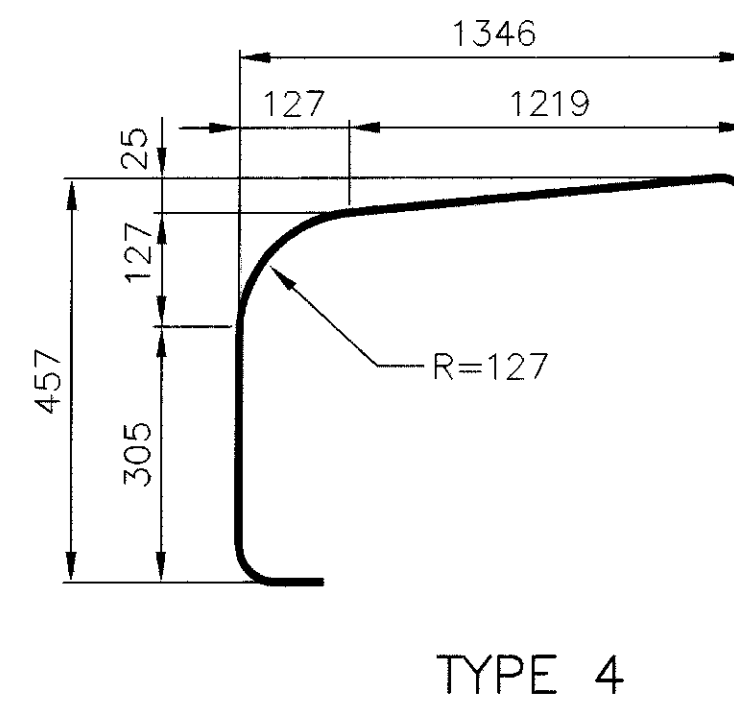
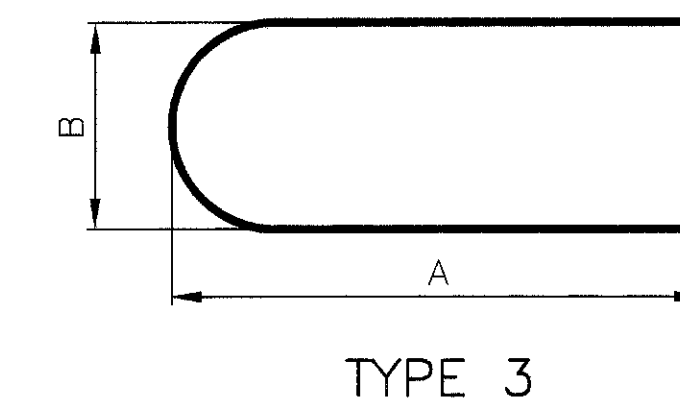
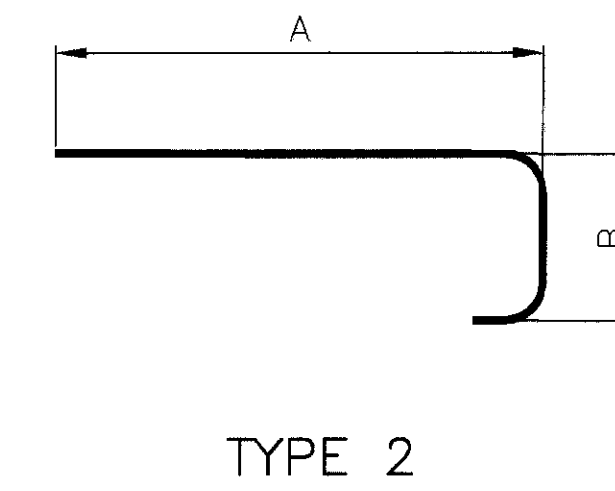
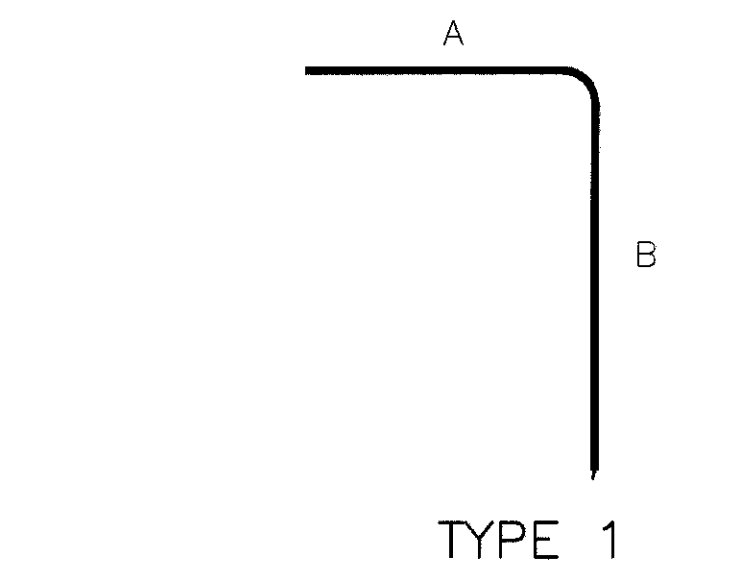

**NOTES**

1. ALL DIMENSIONS ARE GIVEN IN MILLIMETERS, UNLESS NOTED OTHERWISE.
2. ALL BARS DIMENSIONS ARE GIVEN OUT-TO-OUT.
3. ALL BARS SHALL BE EPOXY COATED.
4. STR\* INDICATES USE OF MECHANICAL CONNECTOR SPLICE.