

LAKE COUNTY
S. H. 327 SEC. MADISON
(PT) & F

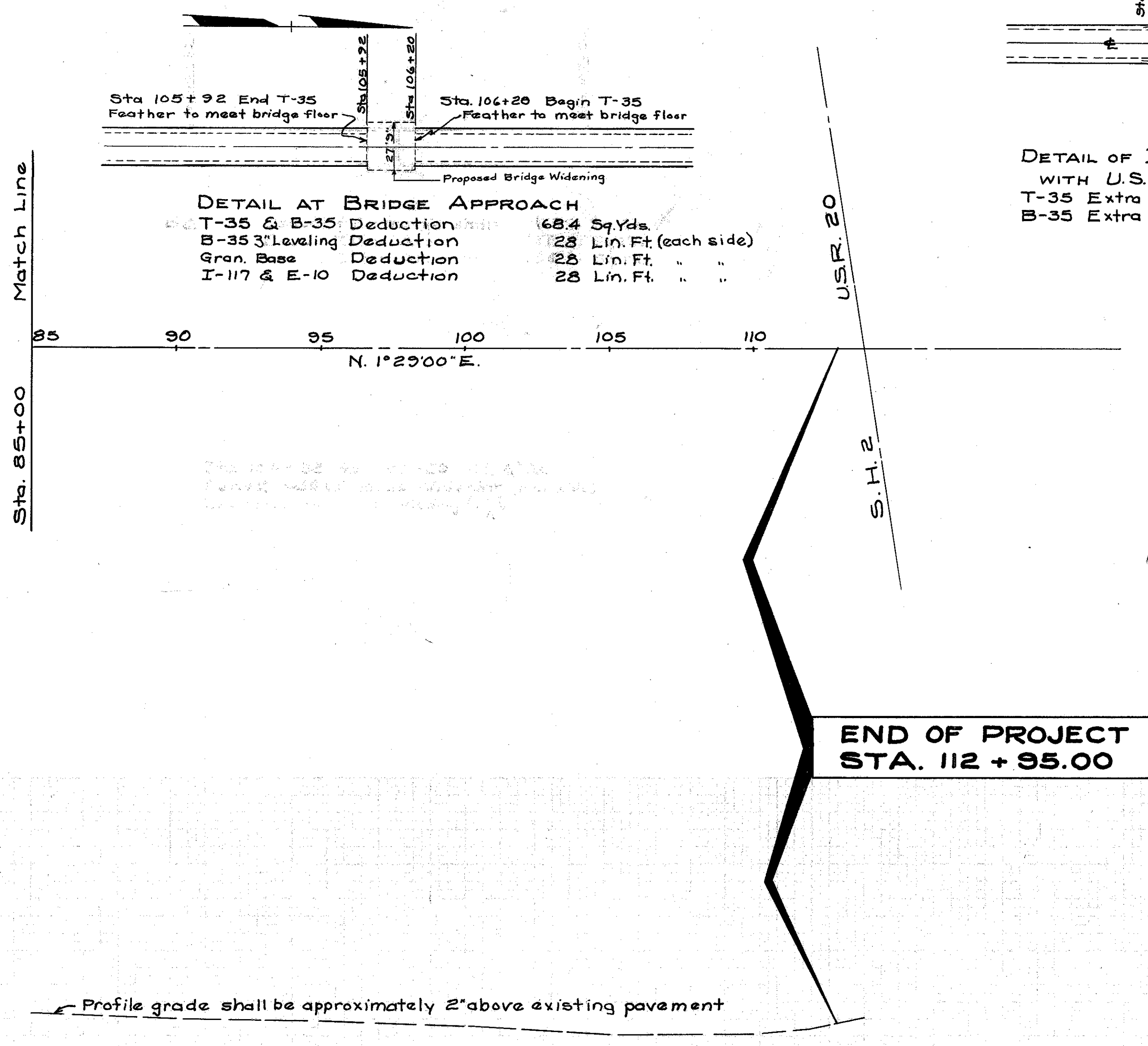

DETAIL AT BRIDGE APPROACH

T-35 & B-35 Deduction	68.4 Sq. Yds.
B-35 3" Leveling Deduction	28 Lin. Ft. (each side)
Gran. Base Deduction	28 Lin. Ft. " "
I-117 & E-10 Deduction	28 Lin. Ft. " "

DETAIL OF INTERSECTION WITH U.S.R. 20
 T-35 Extra Area - 81 Sq. Yds.
 B-35 Extra Area - 63 Sq. Yds.

**END OF PROJECT
 STA. 112 + 95.00**

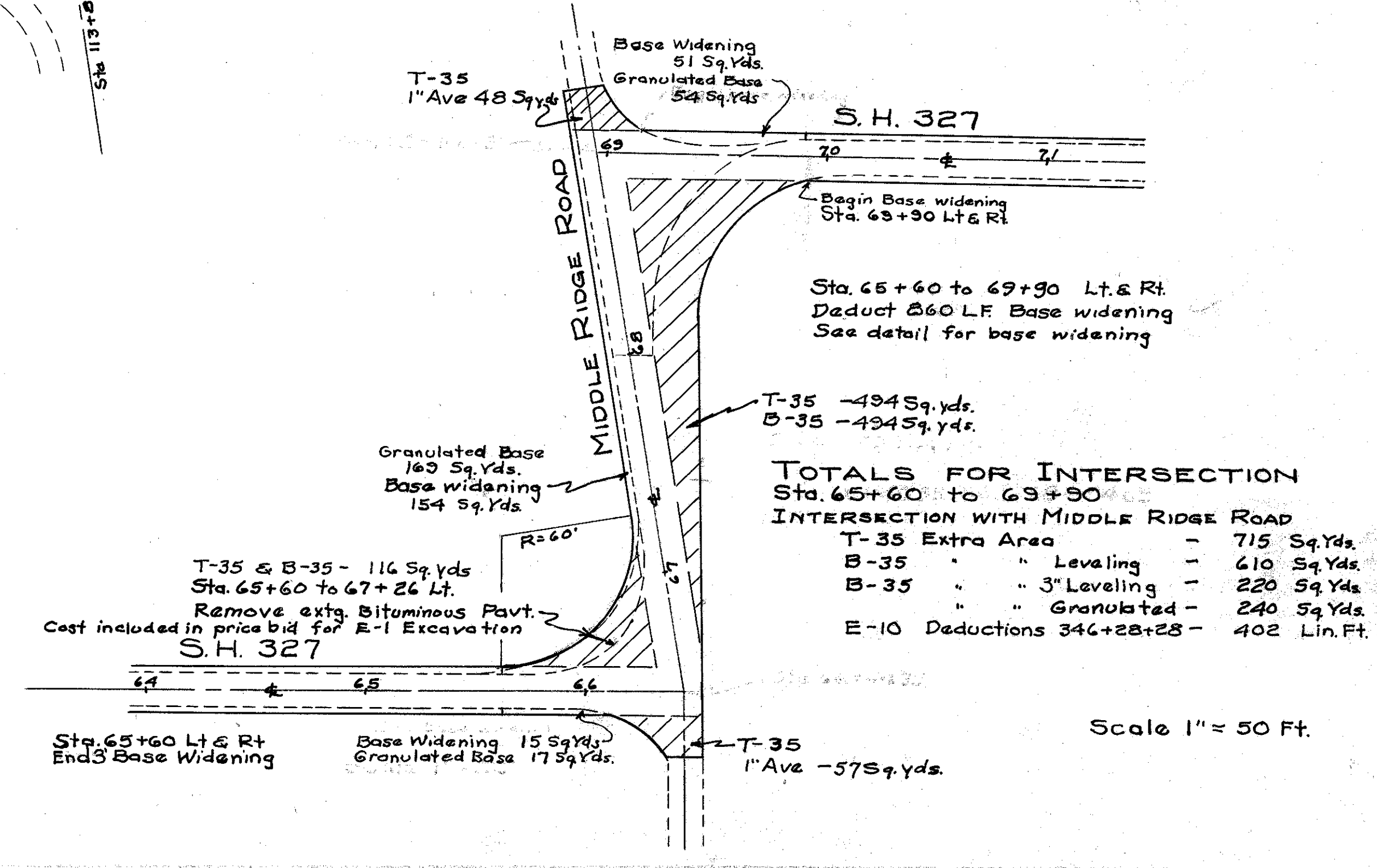
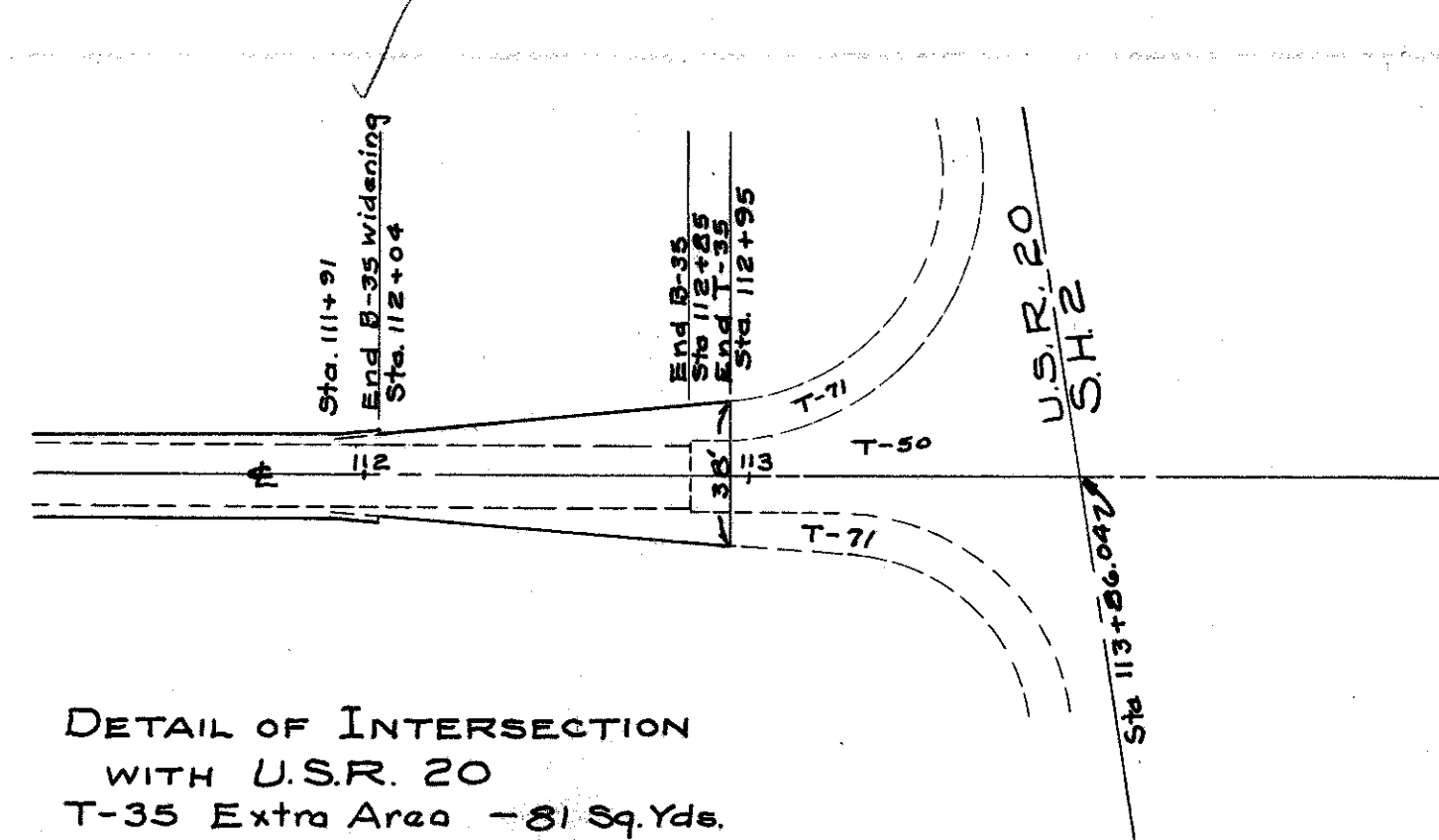

**TOTALS FOR INTERSECTION
 Sta. 65+60 to 69+90
 INTERSECTION WITH MIDDLE RIDGE ROAD**

T-35 Extra Area	- 715 Sq. Yds.
B-35 " " Leveling	- 610 Sq. Yds.
B-35 " " 3" Leveling	- 220 Sq. Yds.
B-35 " " Granulated	- 240 Sq. Yds.
E-10 Deductions	346+28+28 - 402 Lin. Ft.

Scale 1" = 50 Ft.

