

GENERAL PLAN

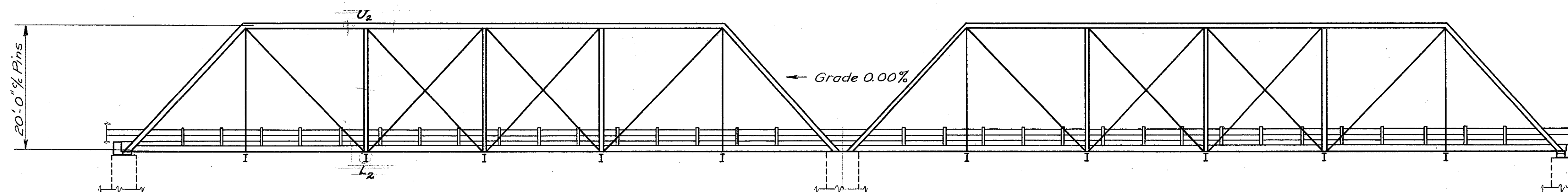

GENERAL ELEVATION
(EXISTING TRUSS SPANS)

GENERAL NOTES

PROPOSED WORK

1. Remove existing bituminous wearing surface, wood block and plank floor.
2. Remove existing guard rails and 7" I steel joists.
3. Reinforce existing floor beams with new cover plates.
4. Straighten Ls and lacing on post U₂L₂ of S. truss-W. span, and bent lacing on other posts.
5. Repair corroded E of end post at S.E. bearing of east span.
6. Remove portions of stone and concrete back walls and bridge seats. Construct new concrete bridge seats.
7. Install new floor stringers, new guard rail, and miscellaneous steel.
8. Construct new concrete backwalls.
9. Install new 6" strip floor and a variable thickness bituminous surface course.
10. Clean and lubricate truss bearings.
11. Clean and paint all steelwork.

DISPOSAL OF REMOVED PORTIONS OF EXISTING STRUCTURE

Removed portions of existing superstructure shall become the property of the contractor and shall be removed from the site.
Removed portions of the substructure shall be disposed of at the site as directed by the Engineer.

LOADING - S-12-46

WELDING shall be class "A"

PAINTING - Clean existing steel. Apply a spot prime coat to all surfaces from which the paint has been removed and two field coats in accordance with Section S-8.06.

WORK to be done under Item S-7 "Recondition Existing Structural Steel As Per Plan" consists of straightening Ls and lacing, and cleaning and lubricating truss bearings, as listed in "Proposed Work".

TACK COAT shall be applied at the rate of 1/10 gal. per sq. yd.

ESTIMATED QUANTITIES

ITEM	TOTAL	UNIT	DESCRIPTION	EAST ABUT.	WEST ABUT.	PIER	SUPER-STRUCTURE	GENERAL		
S-1	6	Cu. yd.	Class "C" concrete	3	3					
S-4	280	Lb.	Reinforcing steel	141	133			6		
S-7	50,500	Lb.	Structural steel (new)				50,500			
S-7	Lump	Sum	Recondition existing structural steel as per plan					Lump		
S-8	50,500	Lb.	Field painting of new structural steel				50,500			
S-8	Lump	Sum	Field painting of existing structural steel					Lump		
S-13	3,568	Sq. ft.	6" strip flooring, creosoted				3,568			
S-14	455.33	Lin. ft.	Railing (Type I-15.13) (With steel posts)				455.33			
S-22	Lump	Sum	Removal of portions of existing structure					Lump		
S-23	70	Lin. ft.	Dowel holes	25	25	20				
S-13	0.345	M.B.M.	Bridge timber, creosoted				0.345			
T-35	20	Cu. yd.	Asphaltic concrete surface course, Type A or C (70-80) or (85-100)				20			
T-30	40	Gal.	Bituminous tack coat, Sec. M-5.5, MS-2 or 55-1				40			

Revised As-built No. Change 11-29-51 R.W.T.

STATE OF OHIO
DEPARTMENT OF HIGHWAYS
BUREAU OF BRIDGES AND RAILROAD CROSSINGS

GENERAL PLAN & ELEVATION
NOTES & ESTIMATED QUANTITIES
FLOOR RECONSTRUCTION
BRIDGE NO. LA-528-21A
OVER GRAND RIVER
LAKE COUNTY
LAKE COUNTY
LAK-528-2.09 STA. 8+62.07

DESIGNED	DRAWN	TRACED	CHECKED	REVIEWED	DATE	REVISED
C.R.	C.R.	ER	HGR	BFG	4-26-50	3-29-50