

Lake County
Lak-528-2.09

EXISTING BRIDGE DATA
 Spans, % bearings 2@111'-3"
 Clear Height= 15'-3"
 Skew= 0°
 Loading= H-4
 Flooring= 1/2" bit Mat on 6" Wood
 Clear Roadway= 15'-9"

PROPOSED STRUCTURE
 New stringers and 6" strip floor on existing structure

PAVEMENT CALCULATIONS

ITEM T-35 1 1/2" ASPHALTIC CONCRETE SURFACE COURSE
 Sta. 6+00 to Sta. 7+48.24 = (148.24 x 18) ÷ 9 = 296.48 Sq. Yds.
 Sta. 9+75.90 to Sta. 11+00 = (124.10 x 18) ÷ 9 = 248.20 Sq. Yds.
 Total Area = 544.68 Sq. Yds.
 544.68 x 1.25 ÷ 36 = 18.91 Cu. Yds. Use 19 Cu. Yds.

ITEM B-35 ASPHALTIC CONCRETE LEVELING COURSE
 Sta. 6+25 to Sta. 7+48.24 = (123.24 x 18) ÷ 9 = 246.48 Sq. Yds.
 Sta. 9+75.90 to Sta. 10+75 = (99.10 x 18) ÷ 9 = 198.20 Sq. Yds.
 Total Area = 444.68 Sq. Yds.
 444.68 x 5 ÷ 36 = 61.76 Cu. Yds. Use 62 Cu. Yds.

ITEM T-30 BITUMINOUS TACK COAT
 Total Area (same as for ITEM T-35) = 544.68 Sq. Yds.
 544.68 x 0.10 = 54.47 Gals. Use 55 Gals.

ITEM I-17 SIDE APPROACHES, MAIL BOX TURNOUTS AND BERM MATERIAL
 Sta. 6+00 to Sta. 7+48.24 = 2(148.24 x 5) ÷ 9 = 164.71 Sq. Yds.
 Sta. 9+75.90 to Sta. 11+00 = 2(124.10 x 5) ÷ 9 = 137.89 Sq. Yds.
 Total Area = 302.60 Sq. Yds.
 302.60 x 4 ÷ 36 = 33.62 Cu. Yds.
 +15% = 5.04 Cu. Yds.
 Total = 38.66 Cu. Yds. Use 39 Cu. Yds.

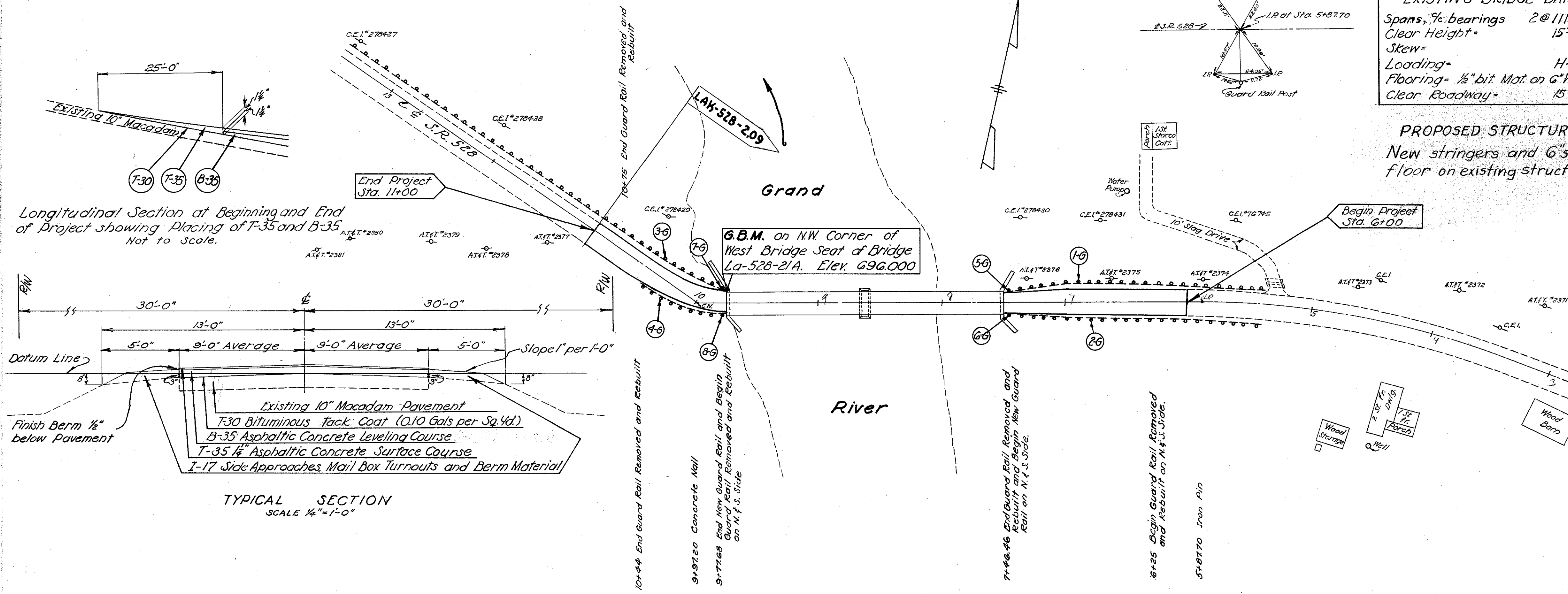

Longitudinal Section at Beginning and End of Project showing Placing of T-35 and B-35. Not to Scale.

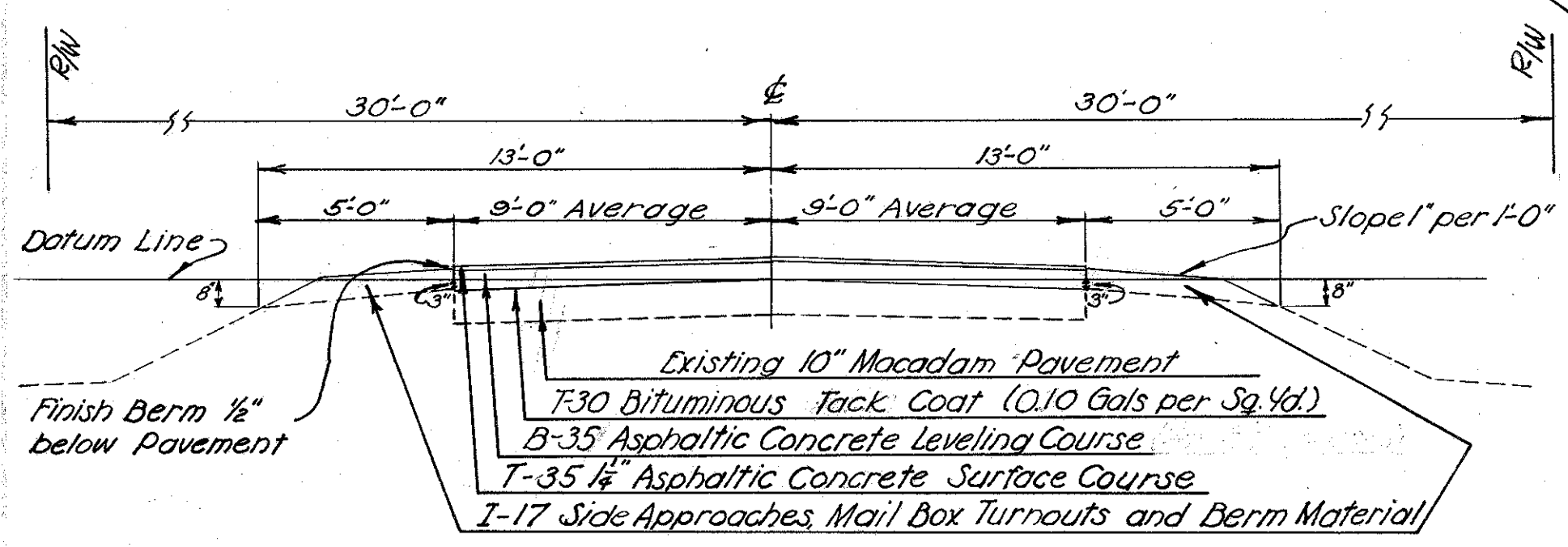

TYPICAL SECTION
SCALE 1/4" = 1'-0"

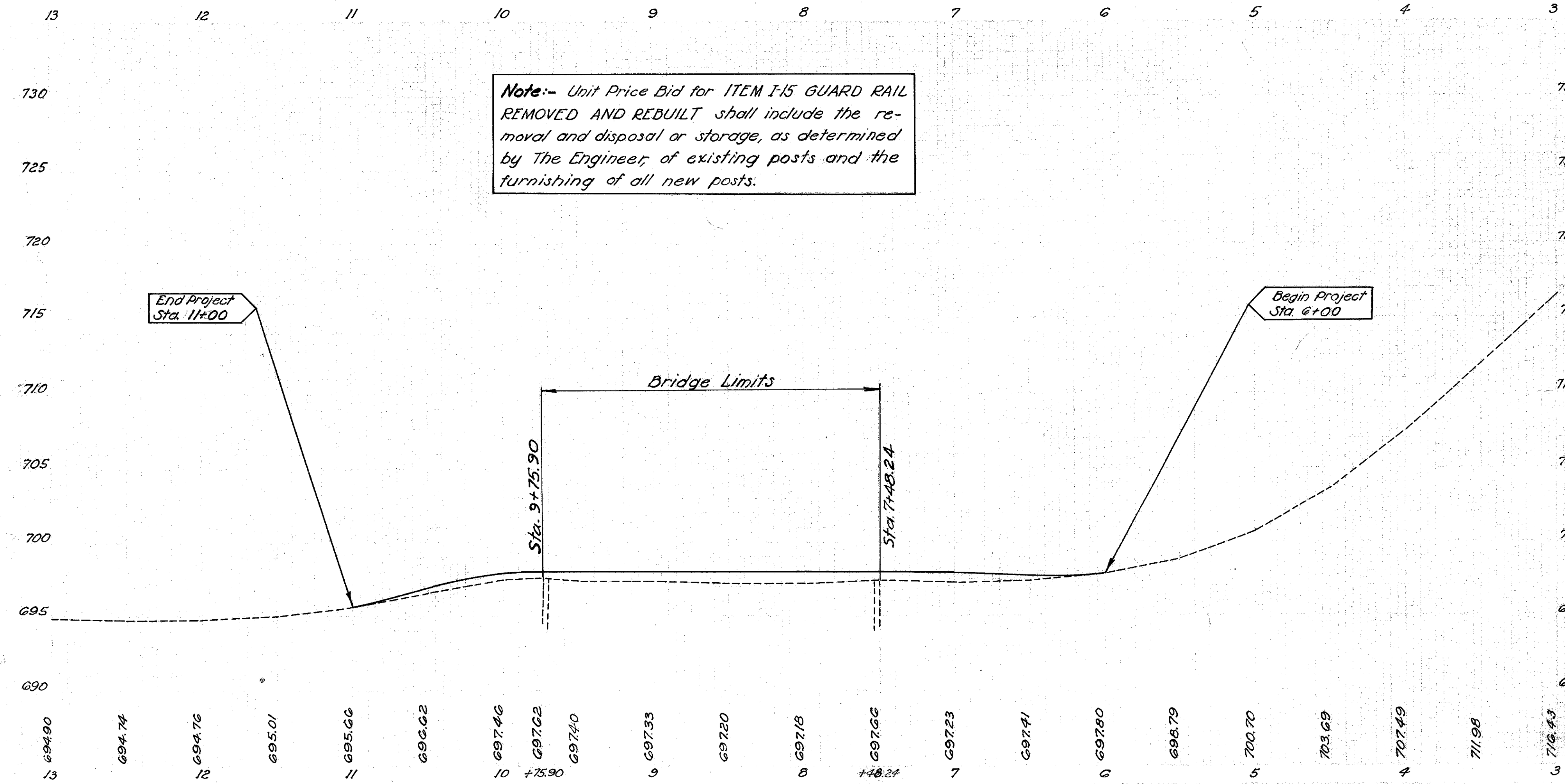

Note: Unit Price Bid for ITEM I-15 GUARD RAIL REMOVED AND REBUILT shall include the removal and disposal or storage, as determined by The Engineer, of existing posts and the furnishing of all new posts.

GENERAL SUMMARY

ITEM	TOTAL	UNIT	DESCRIPTION
T-30	35	Gals	Bituminous Tack Coat Sec. M-5.5 MS-2 or SS-1
B-35	62	Cu. Yds.	Asphaltic Concrete Leveling Course (70-80 or 85-100)
T-35	19	Cu. Yds.	Asphaltic Concrete Surface Course, Type No. 1 (70-80 or 85-100)
I-17	39	Cu. Yds.	Side Approaches, Mail Box Turnouts and Berm Material
I-15	407	Lin. Ft.	Guard Rail Removed and Rebuilt, As Per Plan
I-15	716	Lin. Ft.	Guard Rail, Steel Beam Type (Deep)

For quantities on Structure No. La-528-2/A see sheet No. 3.

ITEM I-15 GUARD RAIL REMOVED AND REBUILT

MARK	SIDE	LOCATION		LENGTH LIN. FT.
		FROM	TO	
1-G	N	Sta. 6+25	Sta. 7+46.45	121.45
2-G	S	Sta. 6+25	Sta. 7+46.45	121.45
3-G	N	Sta. 9+77.69	Sta. 10+75	97.31
4-G	S	Sta. 9+77.69	Sta. 10+44	66.31
Total				406.52

ITEM I-15.13 GUARD RAIL

MARK	SIDE	LOCATION		LENGTH LIN. FT.
		FROM	TO	
5-G	N	Sta. 7+46.45	Sta. 7+48.24	1.79
6-G	S	Sta. 7+46.45	Sta. 7+48.24	1.79
7-G	N	Sta. 9+75.90	Sta. 9+77.69	1.79
8-G	S	Sta. 9+75.90	Sta. 9+77.69	1.79
Total				7.16