

metric
units

SCALE
HORIZONTAL RATIO 1 : 400
VERTICAL RATIO 1 : 200

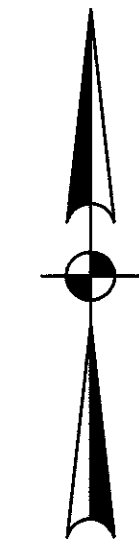

DEFLECTIONS
A=148° 21'59"
B=164° 16'16"
C=144° 16'14"

DESCRIPTION:

THE FLOOD PLAIN OF McMACKIN CREEK AT ITS POINT OF INTERSECTION WITH S.R. 528 IS A MEANDERING CREEK WITH PARTLY GROWN-IN STREAM BED WITH HIGH GRASS AND PARTIALLY OBSTRUCTED WITH DEBRIS ON ALL BANKS NEAR THE STRUCTURE. UP STREAM AND DOWN STREAM IS PARTIALLY OBSTRUCTED WITH DENSE TREES.

NOTE:

1. THE ORDINARY HIGH WATER ELEVATION DETERMINED BY MARKINGS ALONG THE NORTH AND SOUTH WINGWALLS.

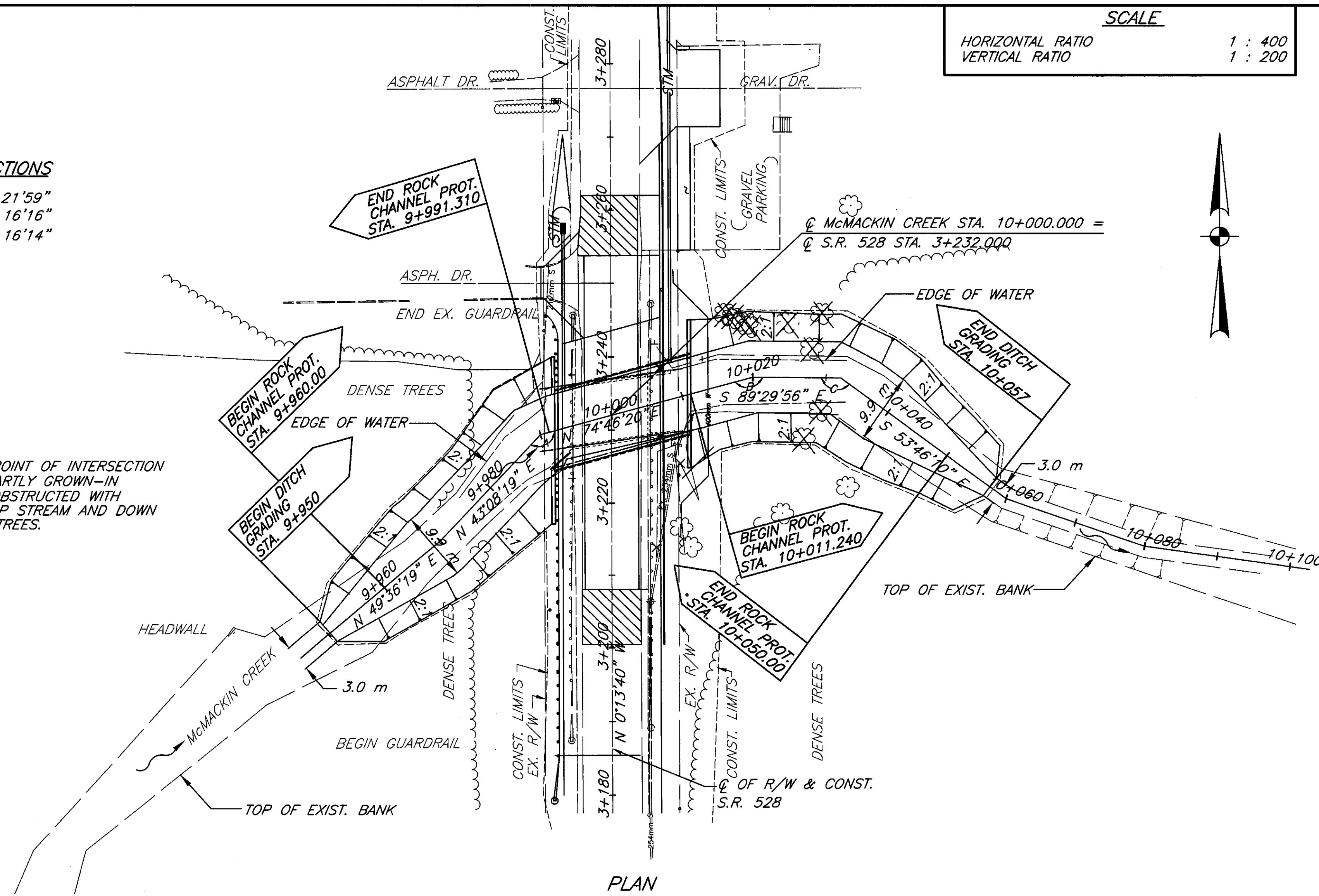

PLAN

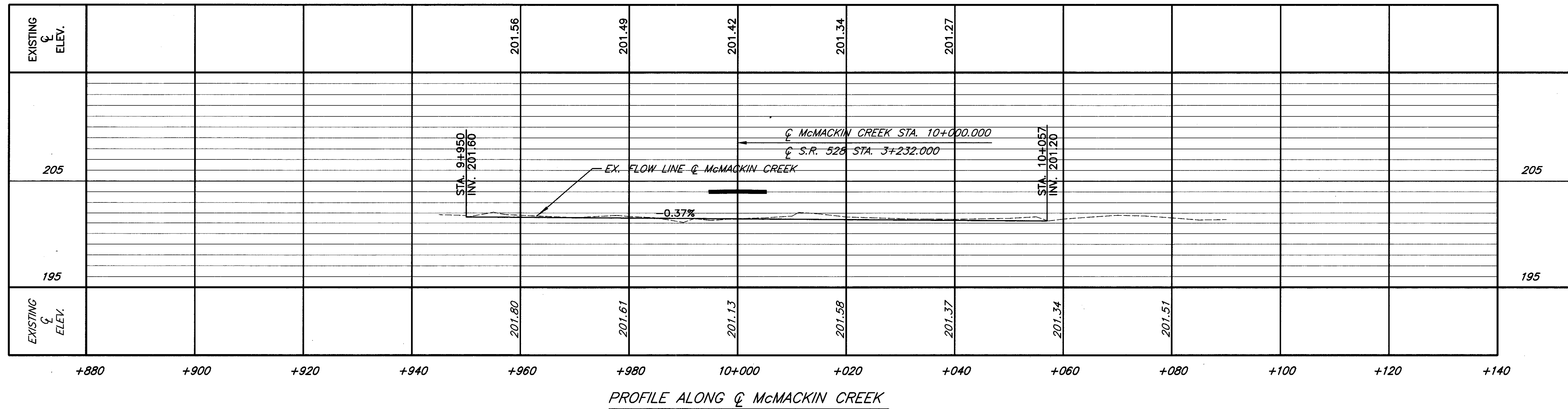

PROFILE ALONG C McMACKIN CREEK

DESIGN AGENCY
MCCOY ASSOCIATES INC.
367 GHEENT ROAD, SUITE 1A
AKRON, OHIO

DATE
8-12-96

REVIEWED
JSK

STRUCTURE FILE NUMBER
4306139

DESIGNED
PSB

CHECKED
SAM

LAKE COUNTY
STA. 3+226.558
STA. 3+237.442

GRADING DETAILS
BRIDGE NO. LAK-528-110240
LAK-528-0685(ENGLISH)
OVER McMACKIN CREEK

LAK-528-11.024

30
49