

LAKE COUNTY METRO
PARK DISTRICT

BRIDGE LIMITS = 987.00'±
982'-0"± c/c ABUTMENT BEARINGS

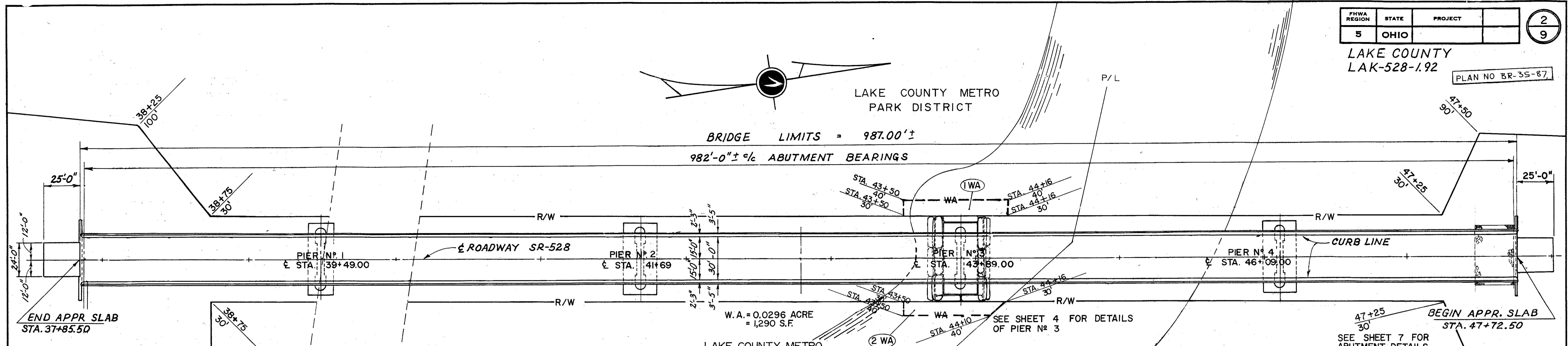

W.A. = 0.0296 ACRE
= 1,290 S.F.

LAKE COUNTY METRO
PARK DISTRICT

PLAN

SUMMARY OF ADDITIONAL RIGHT OF WAY		
PARCEL	OWNER	REMARKS
1 WA	LAKE COUNTY METRO PARK DISTRICT	WORK AGREEMENT TO BE USED FOR ACCESS IN THE PLACEMENT OF THE FABRIC BAGS AROUND PIER NO. 3
2 WA	LAKE COUNTY METRO PARK DISTRICT	WORK AGREEMENT TO BE USED FOR ACCESS IN THE PLACEMENT OF THE FABRIC BAGS AROUND PIER NO. 3

+3.00%

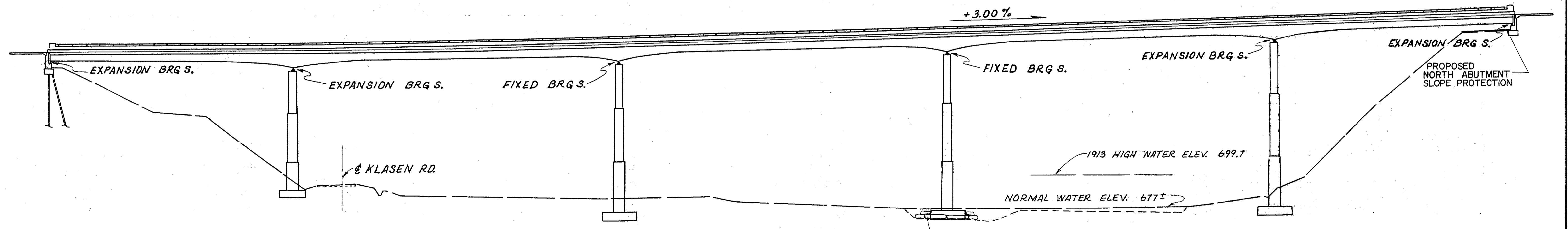

ELEVATION

STATE OF OHIO
DEPARTMENT OF TRANSPORTATION
DIVISION OF HIGHWAYS
DISTRICT 12 BRIDGE DEPARTMENT

GENERAL PLAN
BRIDGE NO. LAK-528-0192
OVER GRAND RIVER

DESIGNED	DRAWN	TRACED	CHECKED	REVIEWED	DATE	REVISED
BGT	DCF	DCF	D.V.Z. 8/87	G.W.M.	8/87	