

Note: Marker will be furnished and erected on the left by State forces prior to acceptance of this improvement.

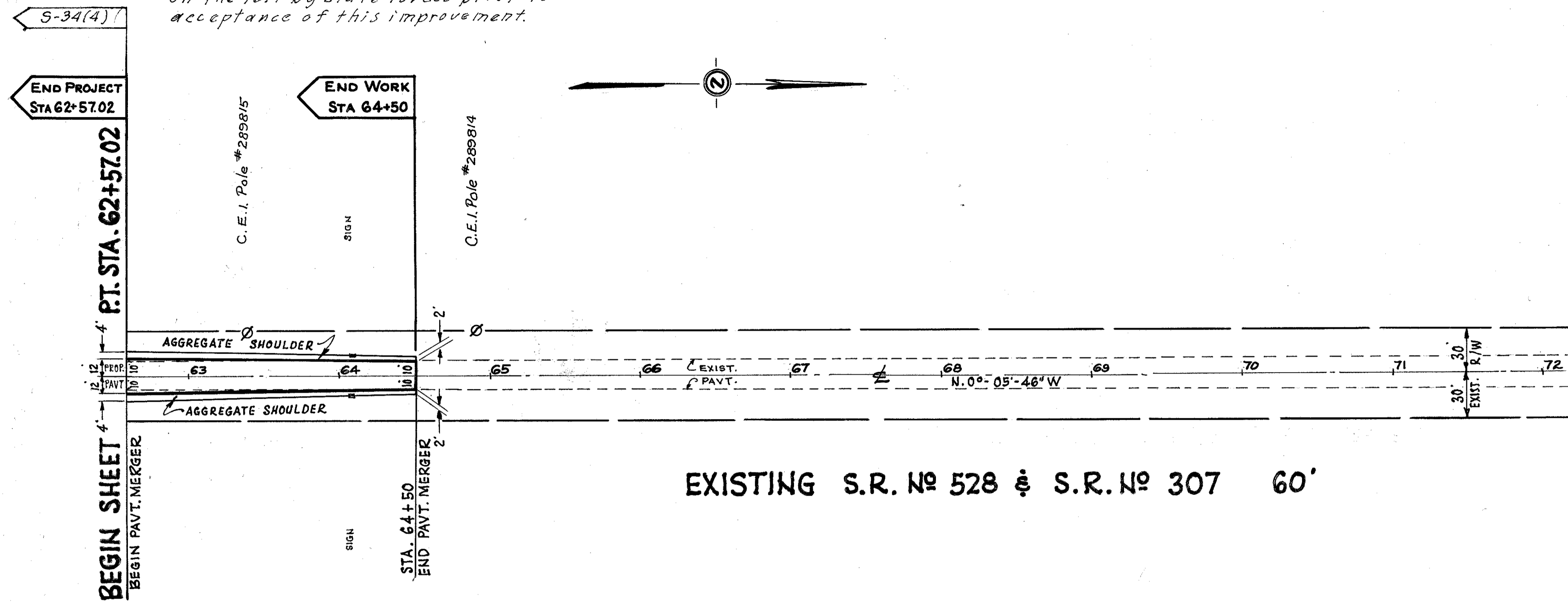

EXISTING S.R. No 528 & S.R. No 307 60'

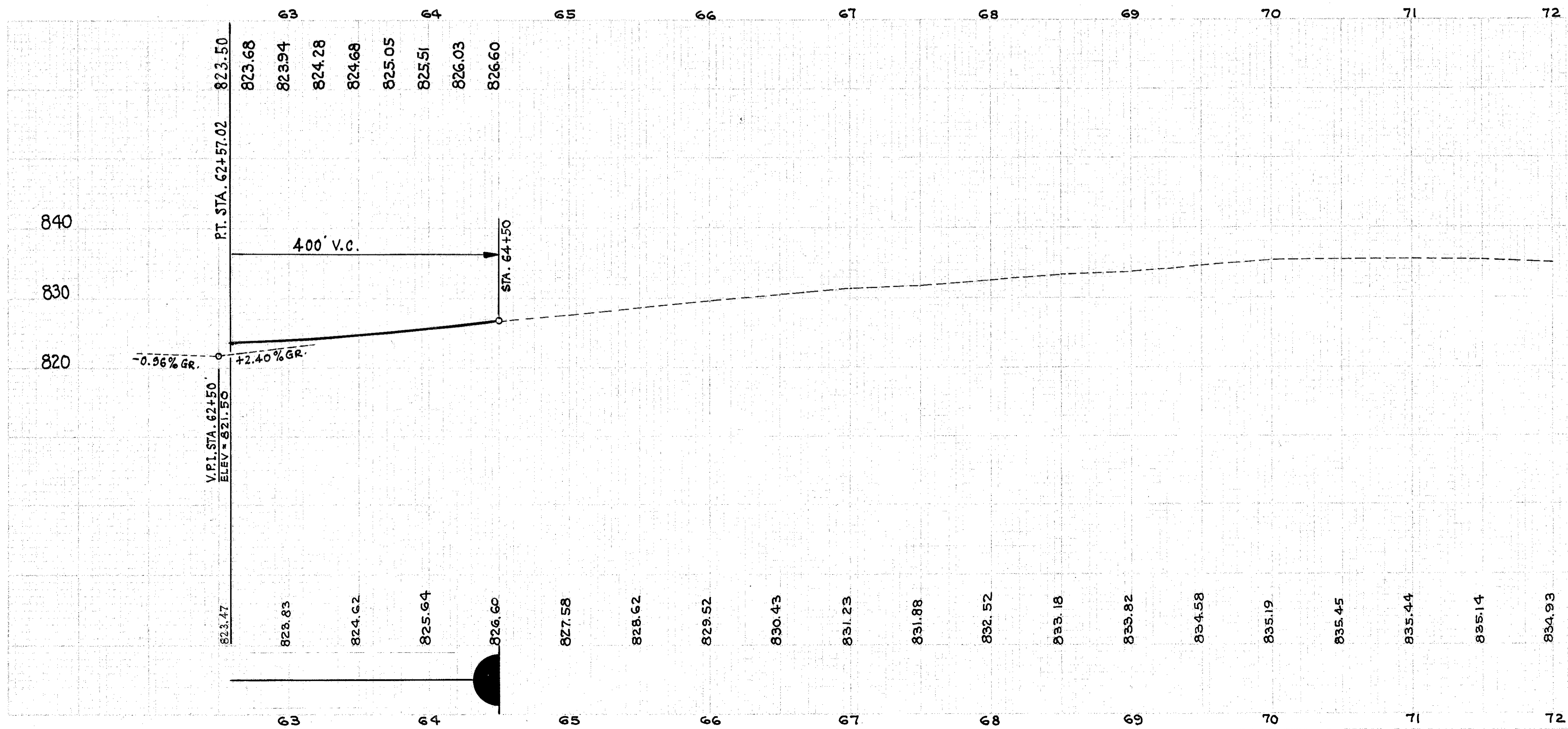

SKEWED DRIVE DIMENSIONS		
Δ	A	B
55° to 65°	8'	24'
65° to 75°	10'	20'
75° to 85°	12'	18'
85° to 90°	15'	15'

LAKE COUNTY
LAK.-528-124

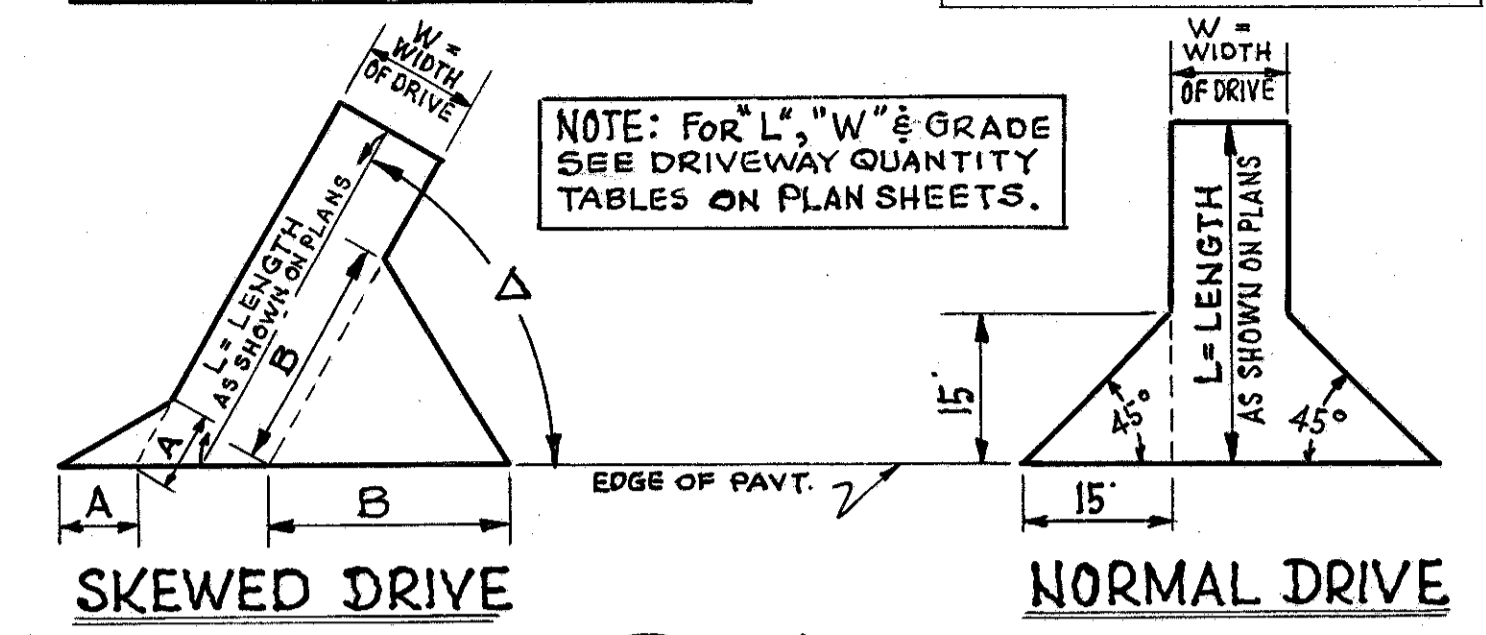

PLAN DRIVEWAY DETAILS
SCALE: 1"=20'

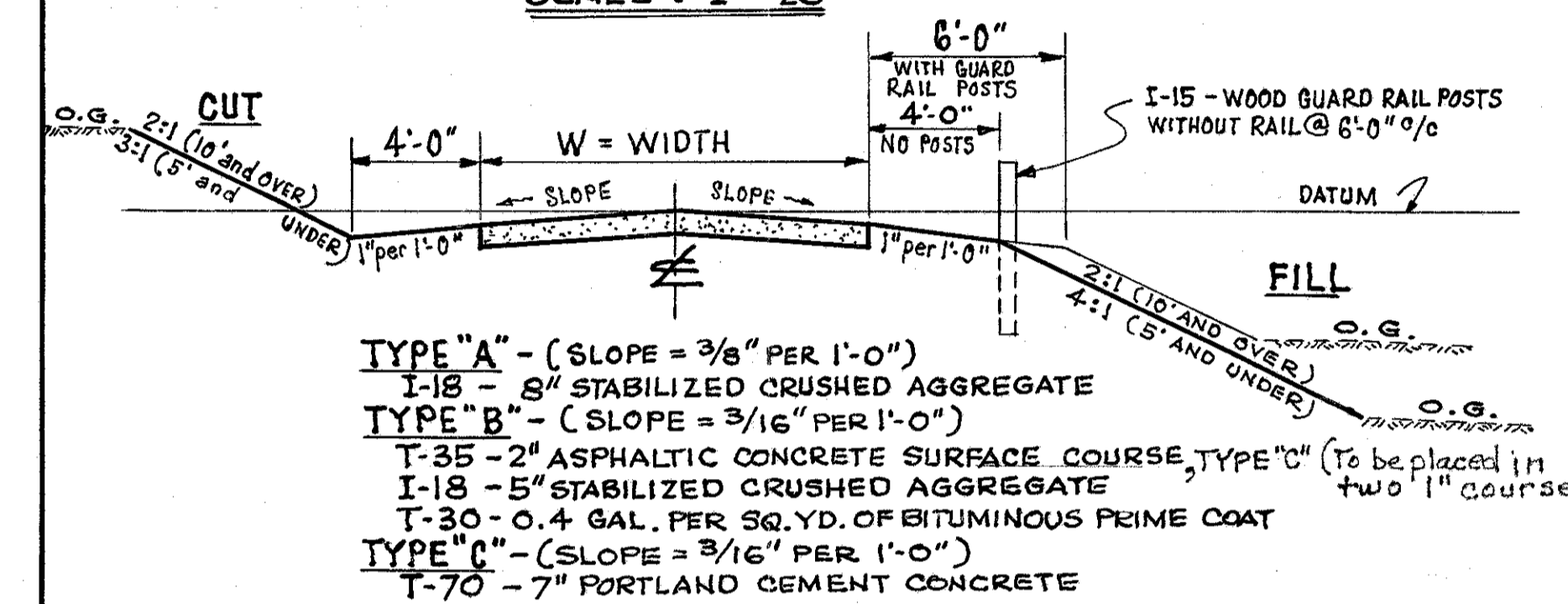

TYPICAL SECTION DRIVE
SCALE: HOR. = 1"=5'-0" & VERT. = 1"=5'-0"

NOTE: For Typical Mailbox Approach and Combined Driveway & Mailbox Approach, See STD. DWG. No DR-1.

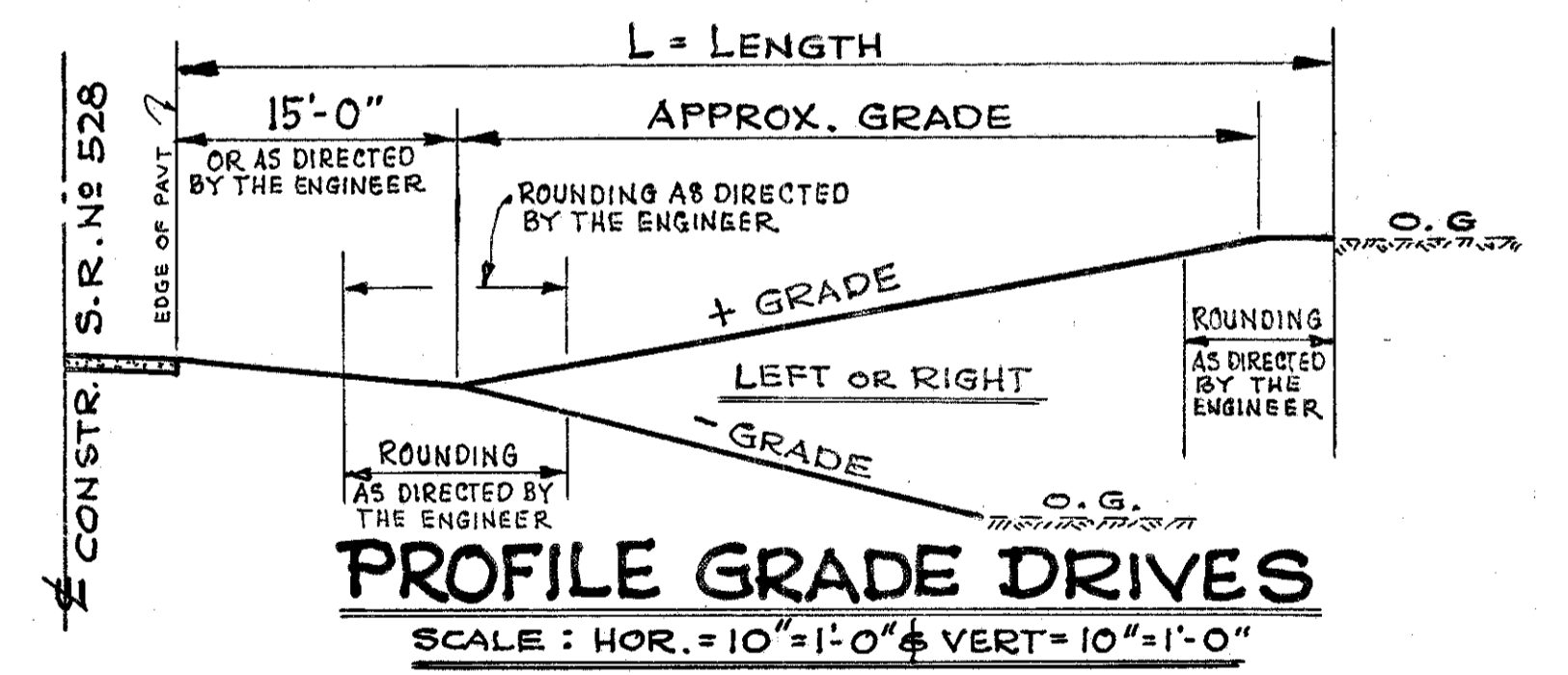

PROFILE GRADE DRIVES
SCALE: HOR. = 10"=1'-0" & VERT. = 10"=1'-0"