

LAKE COUNTY
LAK-44-7.22

(D) DRAINAGE

REF. NO.	STATION	S I D E	E-12	I-1	I-8
			PIPE REMOVAL 15" & UNDER	12" PIPE CLASS B-1	12" PIPE CLASS E-1
I-D	9+25 TO 9+56	-	35	42	30

(P) PAVEMENT

REF. NO.	STATION	S I D E	B-19	I-9	I-22	T-30	T-32				
			AGGR. BASE COURSE	STONE U-DRAIN NO. 2	SUB-BASE	BIT. PRIME COAT	BIT. MAT'L FOR ROAD MIX	#46 AGGR. FOR ROAD MIX	#6 AGGR. FOR CHOKE	#6 AGGR. FOR SEAL COAT	BIT. MAT'L FOR SEAL COAT
I-P	8+00 TO 9+60	-	53	45	42	145	398	20.3	1.5	2.9	91

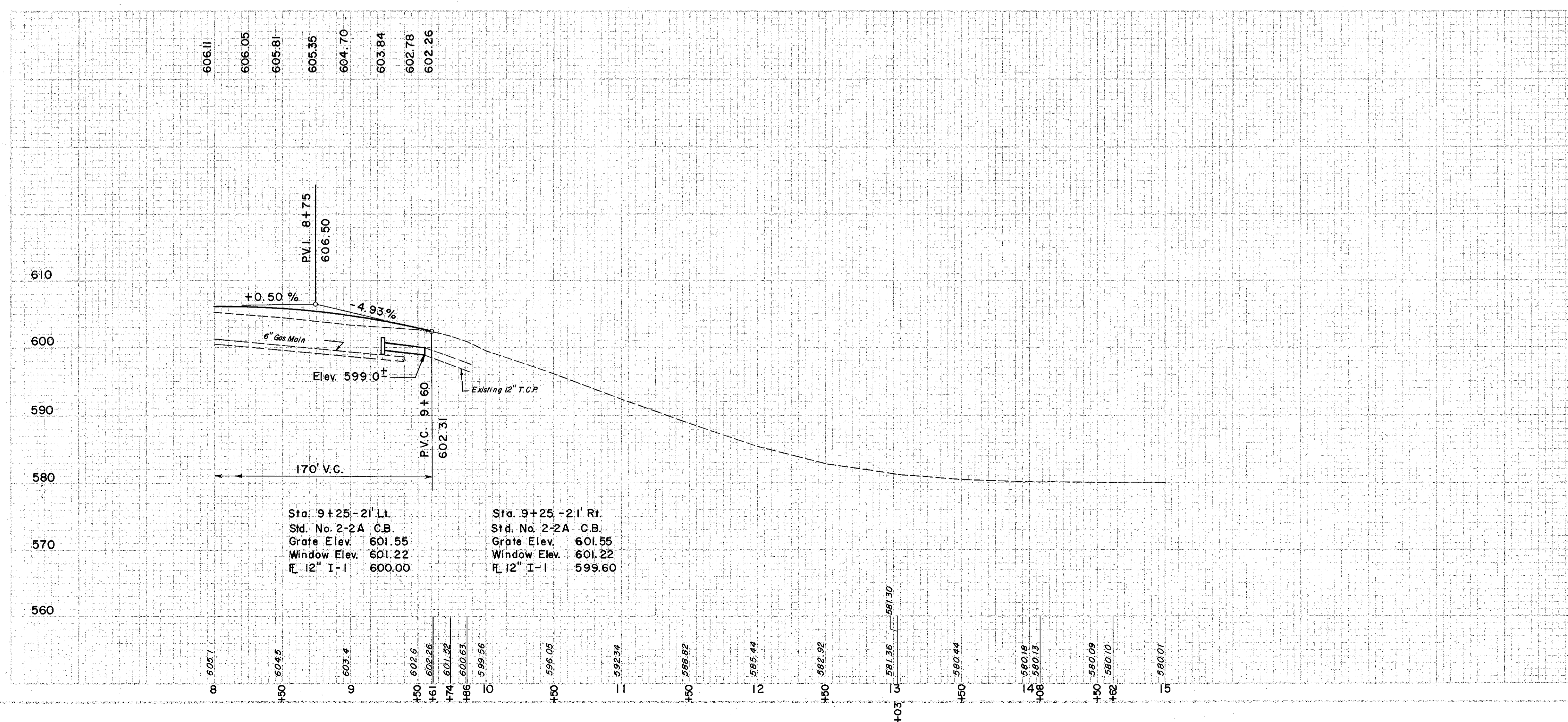
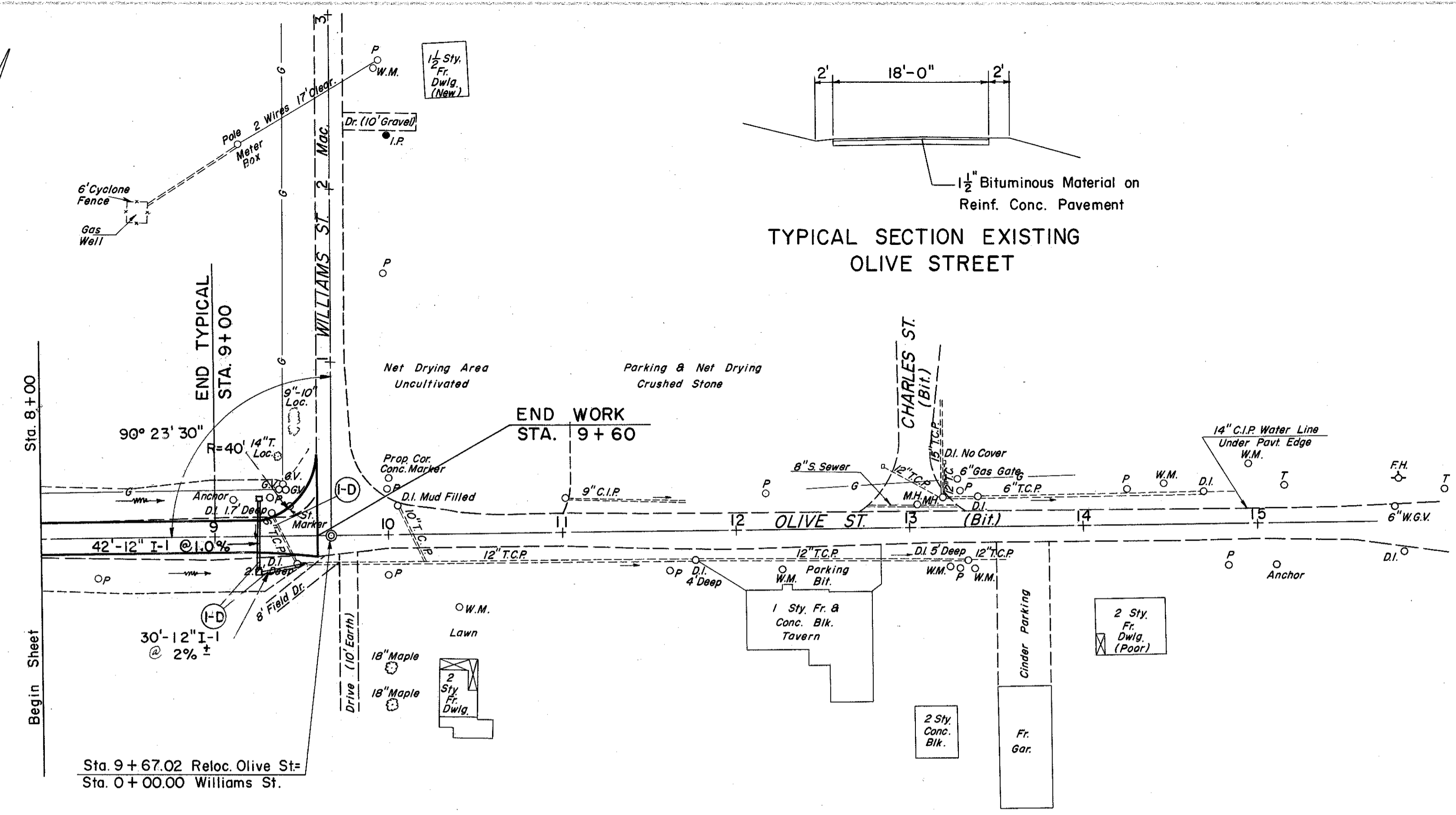
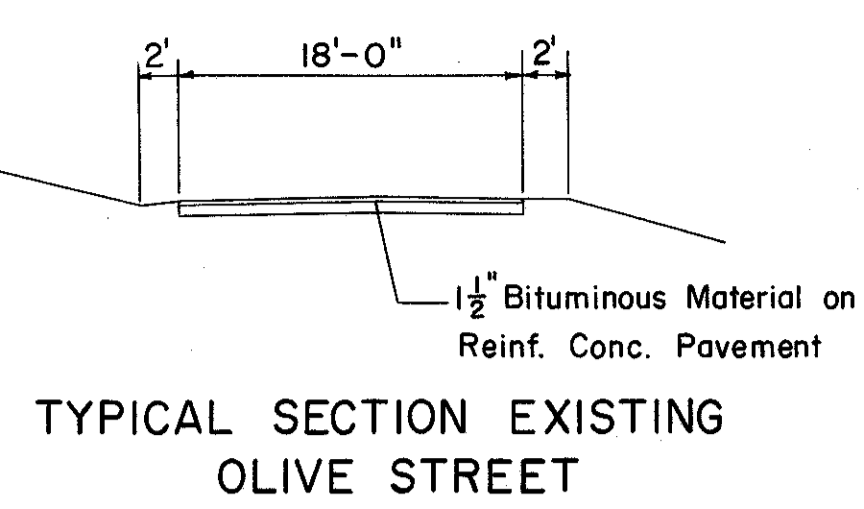

EXCAVATION	=	175 C.Y.
EMBANKMENT	=	95 C.Y.
EMBANKMENT @ 20'	=	114 C.Y.

RELOCATION OLIVE ST. STA. 8+00 TO STA. 15+00