

(D) DRAINAGE

REF. NO.	STATION		SIDE	I-15 PIPE CLASS C-1 M-64(C)	
	FROM	TO		L.F.	S.Y.
1-D	0+56	3+50	LT.	52	80
2-D	0+85	3+50	RT.		91
TOTAL				52	171

(P) PAVEMENT

REF. NO.	STATION		SIDE	B-19	I-9	I-22	T-30	T-32				
	FROM	TO		AGGR. BASE COURSE	STONE U-DRAIN NO.2	SUB-BASE	BIT. PRIME COAT	BIT. MAT'L FOR ROAD MIX	#46 AGGR. FOR ROAD MIX	#6 AGGR. FOR CHOKE	#6 AGGR. FOR SEAL COAT	BIT. MAT'L FOR SEAL COAT
				C.Y.	L.F.	C.Y.	GAL.	GAL.	C.Y.	C.Y.	GAL.	
1-P	0+00	4+50		133	160	107	365	1003	51.1	3.7	7.3	228
2-P	2+45		LT.	24			68	187	9.5	0.7	1.4	43
TOTAL				157	160	107	433	1190	60.6	4.4	8.7	271

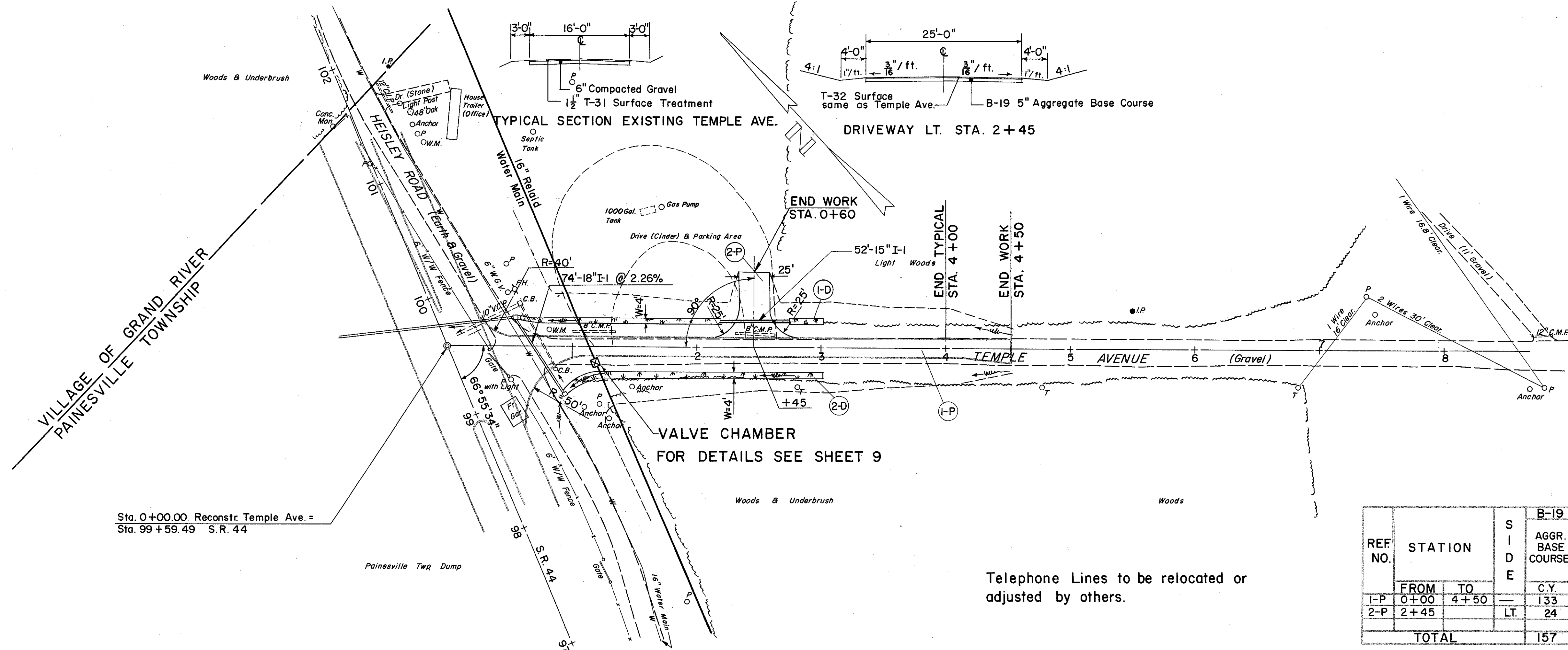

Sta. 0+00.00 Reconstr Temple Ave. =
Sta. 99+59.49 S.R. 44

Telephone Lines to be relocated or adjusted by others.

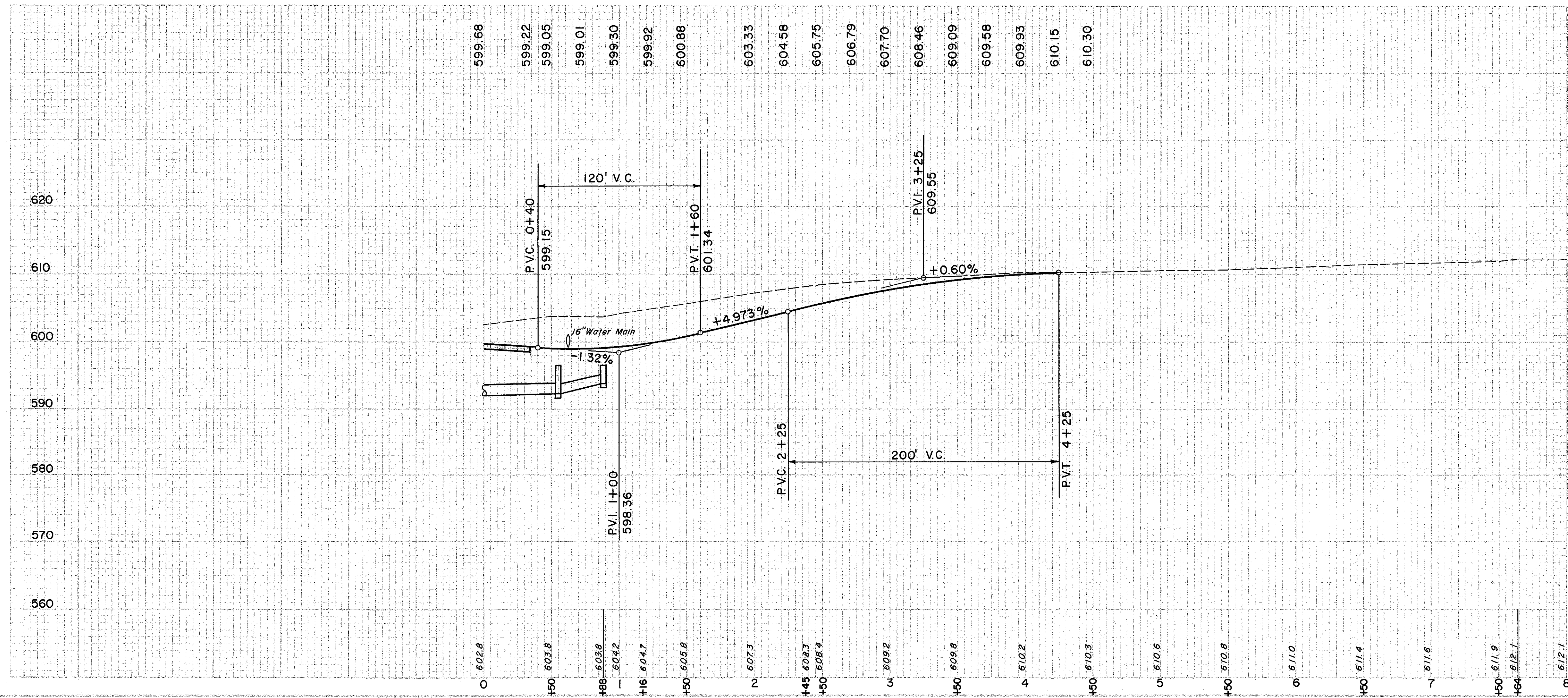

EXCAVATION	=	2,763 C.Y.
EMBANKMENT	=	8 C.Y.
EMBANKMENT + 20'	=	10 C.Y.