

FOR PAVEMENT DETAILS AND ELEVATIONS SEE SHEETS 160

SHEET NO.	STATE	PROJECT
2	OHIO	

141
212

LAKE COUNTY
LAK-44-722

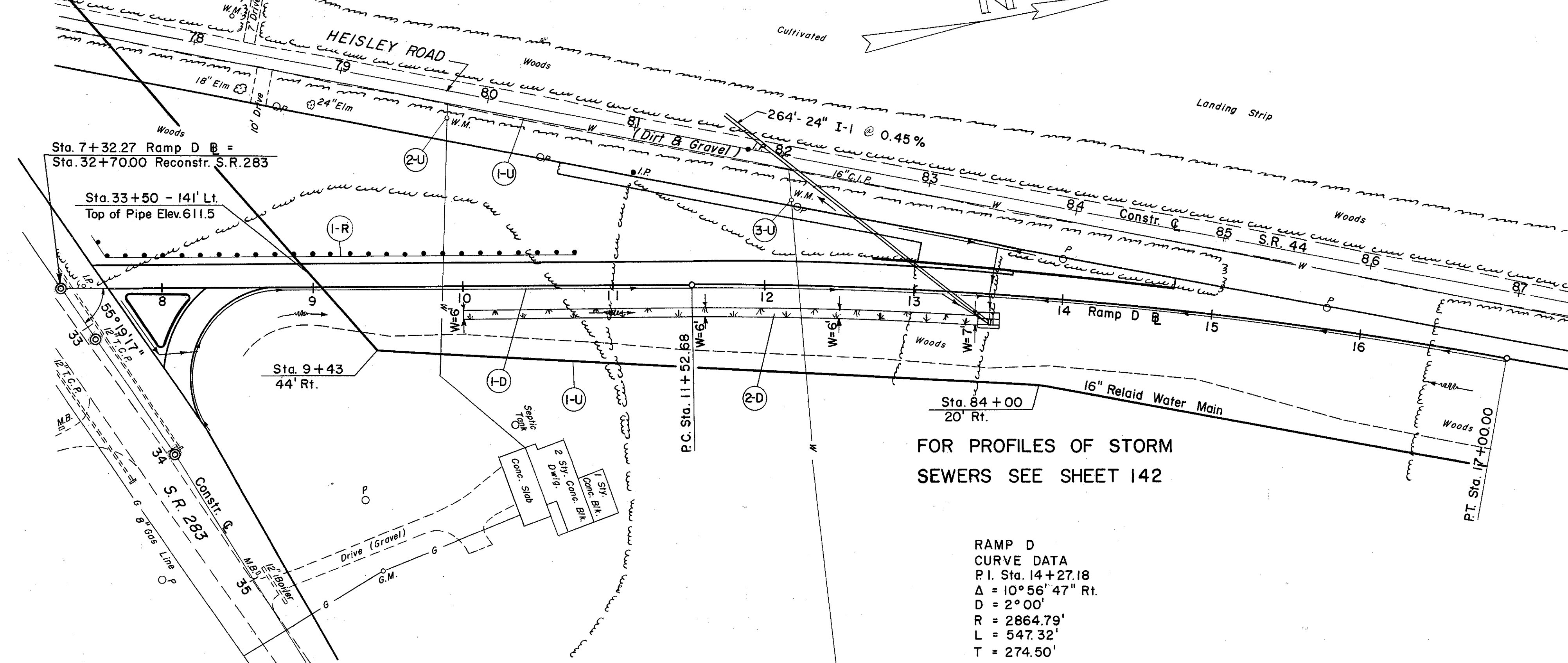

FOR PROFILES OF STORM SEWERS SEE SHEET 142

RAMP D
CURVE DATA
P.I. Sta. 14+27.18
 $\Delta = 10^\circ 56' 47''$ Rt.
D = 2° 00'
R = 2864.79'
L = 547.32'
T = 274.50'

(D) DRAINAGE

REF. NO.	STATION	SIDE	I-1		I-5		L-10	
			6" PIPE CLASS I-3 (DEEP)	8" PIPE CLASS F-1	6" 60° WYE	6" 30° BEND	SODDING	
	FROM TO		L.F.		EA.		S.Y.	
I-D	8+23 17+00	RT.	890	10				
2-D	10+00 13+45	RT.					230	

(R) ROADWAY

REF. NO.	STATION	SIDE	I-15	
			GUARD RAIL STEEL BEAM STD. TYPE (DEEP)	L.F.
I-R	7+62.5 10+75	LT.	312.5	

(P) PAVEMENT

REF. NO.	STATION	SIDE	B-21		I-12		I-18		I-22		T-31		T-71	
			WATER PROOFED AGGR. BASE COURSE	CONC. CURB SPECIAL	CONC. CURB TYPE 6	STAB. CRUSH. AGGR.	SUB-BASE	BIT. MAT'L.	# 6 AGGR.	REINF. PORT. CONC. PAVT. 9"				
	FROM TO		C.Y.	L.F.	L.F.	C.Y.	C.Y.	GAL.	C.Y.	S.Y.				
I-P	7+32.27 17+00	-	80	200	154	139	714	239	7.6	1791				

(U) UTILITIES

REF. NO.	STATION	SIDE	I-124.03		I-124.04		I-124.08		I-124.11	
			16" CAST IRON FITTINGS	1/8 BEND	16" WATER MAIN REMOVED & RELAID	SERVICE STOPS & BOXES REMOVED & RESET	WATER METERS REMOVED & RESET			
	FROM TO		EA.		L.F.	EA.		EA.		
1-U	9+43 84+00	R	1		444					
2-U	9+86									
3-U	12+23									
TOTAL			1		444	2		2		

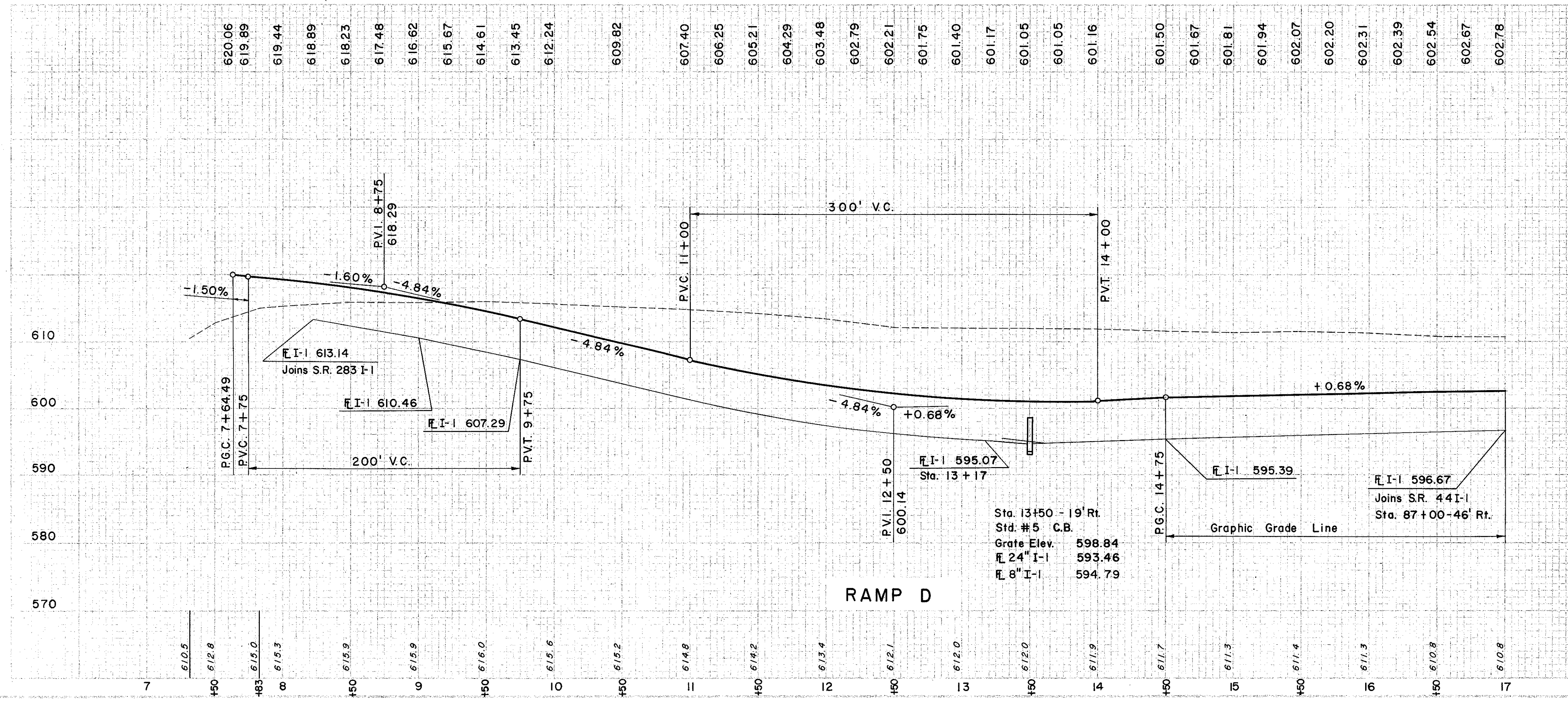

RAMP D

Sta. 13+50 - 19' Rt.
Std. # 5 C.B.
Grate Elev. 598.84
E 24" I-1 593.46
E 8" I-1 594.79

EXCAVATION	= 4,467 C.Y.
EMBANKMENT	= 314 C.Y.
EMBANKMENT @ 20"	= 37 C.Y.

RAMP D S.R. 283 INTERCHANGE
STA. 7+32.27 TO STA. 17+00.00