

FOR PROFILES OF STORM SEWERS SEE SHEET 142
FOR PAVEMENT DETAILS AND ELEVATIONS SEE SHEETS 158
FOR DETAILS OF CULVERT SEE SHEET 180

RAMP B
CURVE DATA
P.I. Sta. 11+16.57
Δ = 25° 04' 38" Lt.
D = 4° 00' 00"
R = 1432.39'
L = 627.07'
T = 318.64'

SECTION A-A THRU DUMPED ROCK

Sta. 3+32.42 Ramp B =
Sta. 27+57.97 Reconstr. S.R. 283

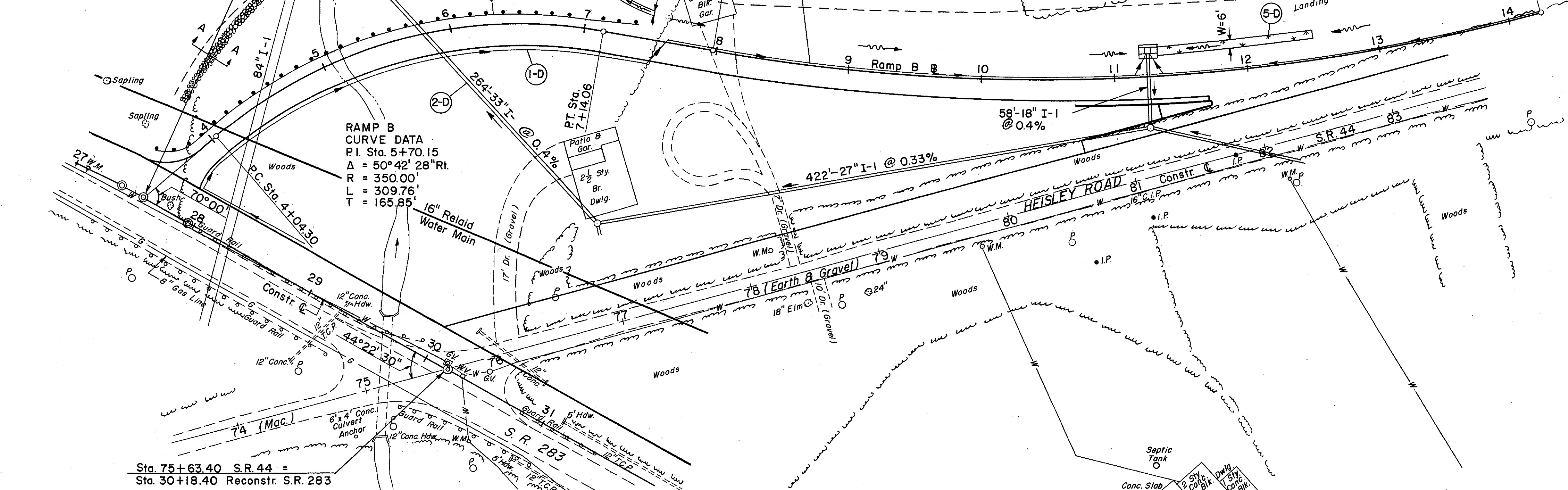

(D) DRAINAGE

REF. NO.	STATION	SIDE	I-1		I-5		I-10		I-15		DUMPED ROCK CHANNEL PROTECT.	SODDING	I-2 MASONRY
			33" PIPE CLASS B-1-M-6.6(d)	6" PIPE CLASS I-3	8" PIPE CLASS F-1	6" BEND	6" BEND	6" BEND	EA.	C.Y.			
1-D	3+70	14+25		834	270	20	2	2					0.55
2-D	5+80		264									68	
3-D	6+50	7+50	LT.								40		
4-D	4+00	5+00	LT.									79	
5-D	11+32	12+50										147	0.55
TOTAL			264	834	270	20	2	2	40		147		0.55

(R) ROADWAY

REF. NO.	STATION	SIDE	I-15	
			GUARD RAIL	STEEL BEAM STD. TYPE (DEEP)
I-R	S.R. 283 Ramp B	LT.	387.5	

(P) PAVEMENT

REF. NO.	STATION	SIDE	B-21	I-12	I-18	I-21	I-22	T-31	T-71	
			WATER-PROOFED AGGR. BASE COURSE	CONC. CURB TYPE 6	STAB. CRUSHED AGGR.	PORT. CONC. MEDIAN TYPE 1	SUB-BASE	BIT. MAT'L.	#6 AGGR.	REINF. PORT. CONC. PAV'T. 9'
I-P	3+32.42	14+25	60	206	107	30.2	511	181	5.8	2130

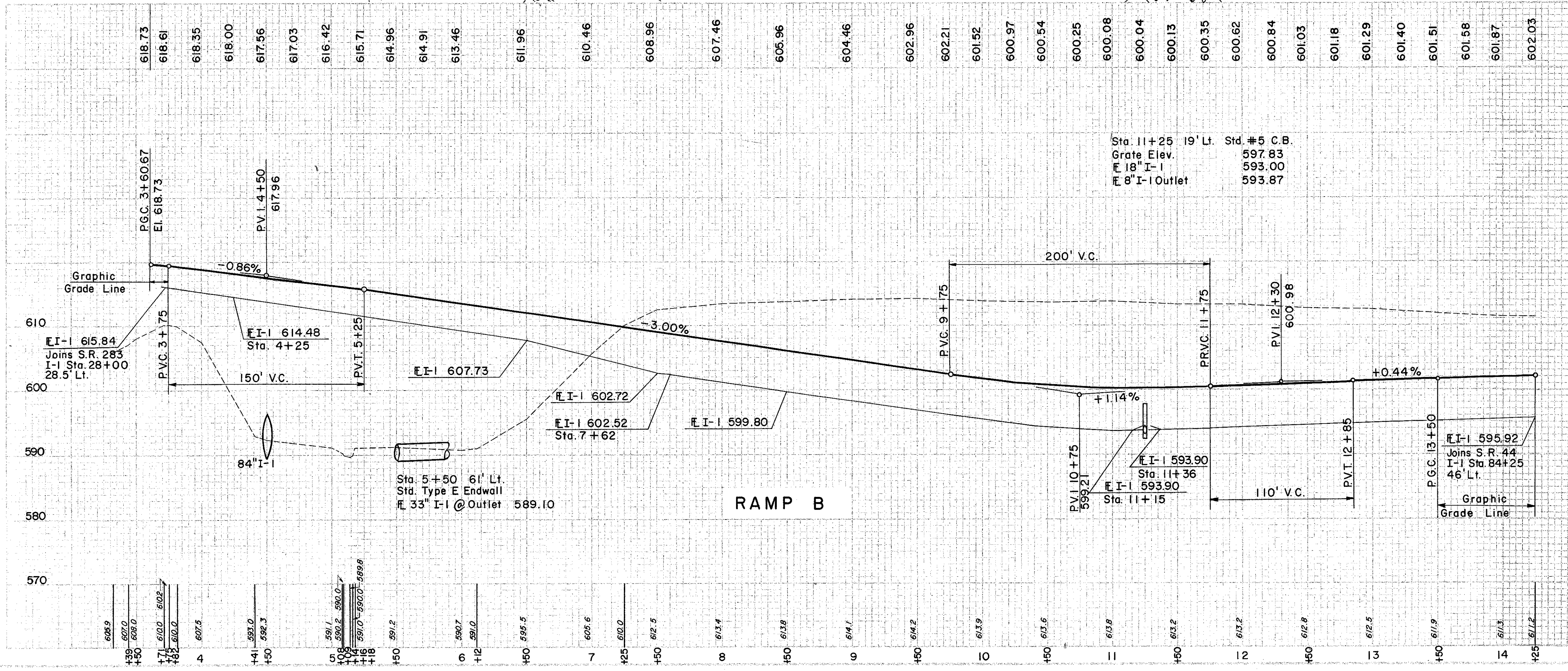

EXCAVATION	= 14,256 C.Y.
EMBANKMENT	= 28,001 C.Y.
EMBANKMENT @ 20%	= 33,601 C.Y.

RAMP B S.R. 283 INTERCHANGE
STA. 3 + 32.42 TO STA. 14 + 25.00