

FOR DETAILS OF OLIVE STREET  
INTERSECTION SEE SHEET 100

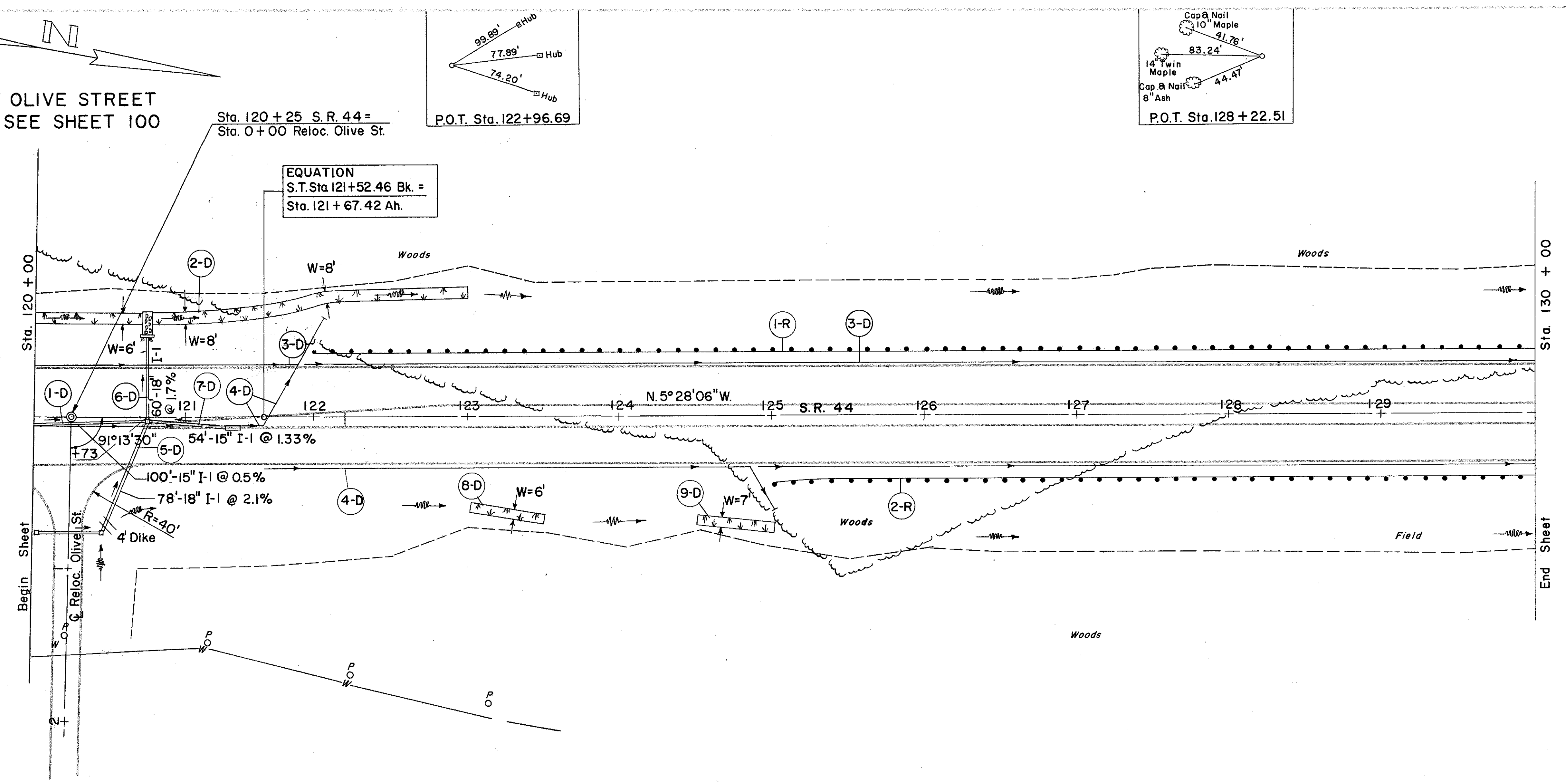

B.M. # 10 Lag bolt in power pole  
#P.C. 6621, 220' Rt. Sta. 125+12 Elev. 595.61

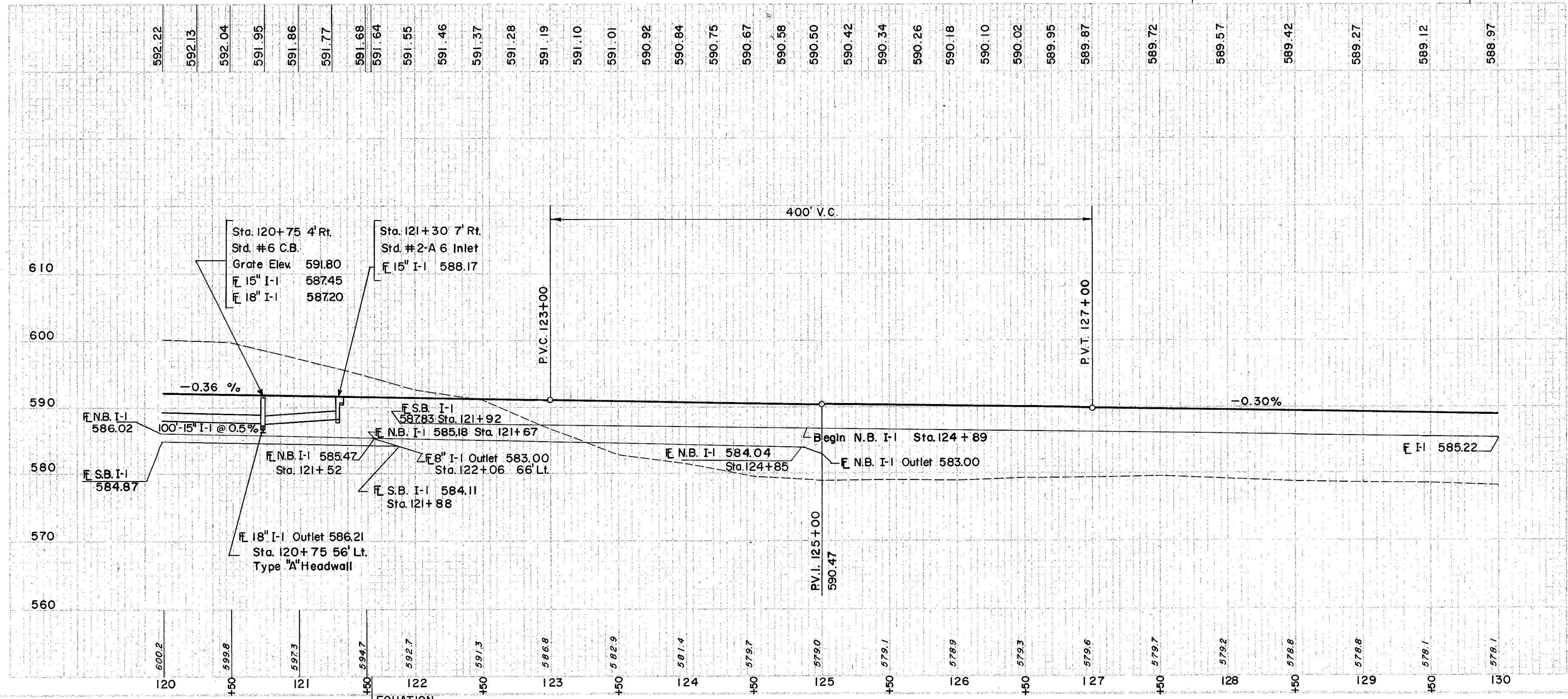

EQUATION  
S.T. Sta. 121+52.46 Bk. =  
Sta. 121+67.42 Ah.

(D) DRAINAGE

REF. NO.	STATION	FROM	TO	ITEM	QTY	UNIT
I-1	120+00	120+00	120+75	15" PIPE CLASS B-1	100	L.F.
I-1	120+00	120+00	120+75	8" PIPE CLASS F-1	20	L.F.
I-1	120+00	120+00	120+75	6" PIPE CLASS I-3	808	L.F.
I-1	120+00	120+00	120+75	6" INCR. BEND EASER	2	EA
I-1	120+00	120+00	120+75	6" X 8" WYE	1	EA
I-5	120+00	120+00	120+75	60° BEND	2	EA
I-8	120+00	120+00	120+75	STD. #6 CATCH BASIN	1	EA
I-8	120+00	120+00	120+75	STD. 2-A6 INLET	1	EA
I-10	120+00	120+00	120+75	DUMPED ROCK CHANNELSODDING PROTECTION	9	C.Y.
I-10	120+00	120+00	120+75	CHANNELSODDING MASONRY	235	S.Y.
I-10	120+00	120+00	120+75	CHANNELSODDING MASONRY	2	S.Y.
I-10	120+00	120+00	120+75	CHANNELSODDING MASONRY	33	S.Y.
I-10	120+00	120+00	120+75	CHANNELSODDING MASONRY	40	S.Y.
I-10	120+00	120+00	120+75	CHANNELSODDING MASONRY	310	S.Y.
I-10	120+00	120+00	120+75	CHANNELSODDING MASONRY	31	S.Y.
TOTAL					138	72

(P) PAVEMENT

REF. NO.	STATION	FROM	TO	ITEM	QTY	UNIT
I-12	120+00	120+00	120+75	CONC. CURB TYPE 2A	1850	S.Y.
I-12	120+00	120+00	120+75	CONC. CRUSHED AGGR.	242	S.Y.
I-12	120+00	120+00	120+75	PORT. CEM. MEDIAN TYPE I	78	S.Y.
I-21	120+00	120+00	120+75	PORT. CEM. CONC.	1325	S.Y.
I-21	120+00	120+00	120+75	PORT. CEM. CONC.	422	S.Y.
I-21	120+00	120+00	120+75	PORT. CEM. CONC.	13.5	S.Y.
I-21	120+00	120+00	120+75	PORT. CEM. CONC.	5909	S.Y.
I-21	120+00	120+00	120+75	PORT. CEM. CONC.	422	S.Y.
I-21	120+00	120+00	120+75	PORT. CEM. CONC.	13.5	S.Y.
I-21	120+00	120+00	120+75	PORT. CEM. CONC.	5909	S.Y.
TOTAL					141	1850

(R) ROADWAY

REF. NO.	STATION	FROM	TO	ITEM	QTY	UNIT
I-15	120+00	120+00	120+75	GUARD RAIL	800.0	L.F.
I-15	120+00	120+00	120+75	GUARD RAIL	500.0	L.F.
I-15	120+00	120+00	120+75	GUARD RAIL	1300.0	L.F.
TOTAL					1300.0	L.F.

EXCAVATION	8,877 C.Y.
PAVEMENT	26,497 C.Y.
ROADWAY	31,796 C.Y.