

**PAVEMENT MARKING PLAN**

\*Remove And Replace Item 620-Delineator, Type D, Flexible Post Mounted. Cost To Be Included In Unit Price Bid For Item 630-Removal Of Ground Mounted Sign And Re-erection.

**SIGNING QUANTITIES**

REF. NO.	ITEM	SIGN CODE NO.	SQ. FT. PER SIGN	QTY. EA.	TOTAL AREA SQ. FT. **	SIGN POST NO. 3		
						QTY. EA.	LIN. FT. PER SIGN	TOTAL LENGTH (LIN. FT.)
1	630	R-31A-36	7.50	4	30	4	13.0	52.0
2	630	(R/R)	—	5	—	3	13.0	39.0
3	630	(R/R)	—	7	—	3	15.7	47.1
4	630	(R/R)	—	9	—	2	18.2	36.4
5	630	(R/R)	—	3	—	1	15.0	15.0
<b>TOTALS</b>								<b>189.5</b>

**PAVEMENT MARKING QUANTITIES**

- Item 621-8" Channelizing Line**  
 Sta. 14+08 To Sta. 15+13 = 105 L.F. (Ramp No.1)
- Item 621-Lane Arrows (Turn)**  
 Sta. 15+02 \*\*\* = 1 Ea. (Ramp No.1)  
 Sta. 14+21.75 \*\*\* = 1 Ea. (Ramp No.1)  
 Total 2 Ea.
- Item 621-4" Double Solid Centerline**  
 Sta. 9+12 To Sta. 11+00 = 188 L.F. (Jackson St.)  
 Sta. 12+00 To Sta. 12+50 = 50 L.F. (Jackson St.)  
 Sta. 8+15 To Sta. 8+36 = 21 L.F. (Fern Dr.)  
 Total = 259 L.F. = 0.05 Miles
- Item 621-24" White Stop Lines**  
 Sta. 15+12 = 50 L.F. (Ramp No.1)  
 Sta. 9+12 = 14 L.F. (Jackson St.)  
 Sta. 8+36 = 13 L.F. (Fern Dr.)  
 Total = 85 L.F.
- Item 621-Lane Arrows (Through)**  
 Sta. 15+02 \*\*\* = 1 Ea. (Ramp No.1)  
 Sta. 14+21.75 \*\*\* = 1 Ea. (Ramp No.1)  
 Total 2 Ea.
- Item 621-Word "Only" On Pavement, 72 Inches**  
 Sta. 14+60.75 = 1 Ea. (Ramp No.1)
- Item 621-Crosswalk Lines**  
 Sta. 8+55 To Sta. 8+60 = 100 L.F. (Fern Drive)
- \*\*\* Station Indicated Is For South End Of Word On Arrow.

(R/R) Remove And Re-erection Existing Sign

\*\* Item 630, Sign Flat Sheet

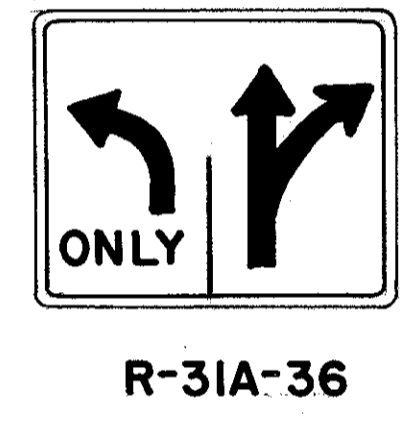

**Legend**

- L = Longitudinal Joints W/ Hook Bolts  
 E = Expansion Joint Without Tie Bars  
 --- Existing Joints
- Notes: 1. All Elevations Along Curb Line Are Bottom Of Curb.  
 2. All Existing Bottom Of Curb Elevations Are To Be Increased By Overlay Thickness, Unless Otherwise Indicated By Elevations Shown.  
 3. The Maximum Spacing Between Contraction Joints Shall Be In Accordance With The Standard Construction Drawings And The Specifications.

**CURVE DATA**

- ④ Δ = 43°-06'-21"  
 R = 50.00'  
 T = 19.75'  
 L = 37.62'  
 PC Sta. = 13+19.68  
 PT Sta. = 13+52.90
- ⑤ Δ = 47°-43'-31"  
 R = 5.00'  
 T = 2.21'  
 L = 4.16'  
 PC Sta. = 13+52.90  
 PT Sta. = 11+15.42
- ⑥ Δ = 72°-02'-14"  
 R = 60.00'  
 T = 43.62'  
 L = 75.44'  
 PC Sta. = 13+09.09  
 PT Sta. = 12+07.40

**INTERSECTION DETAILS**

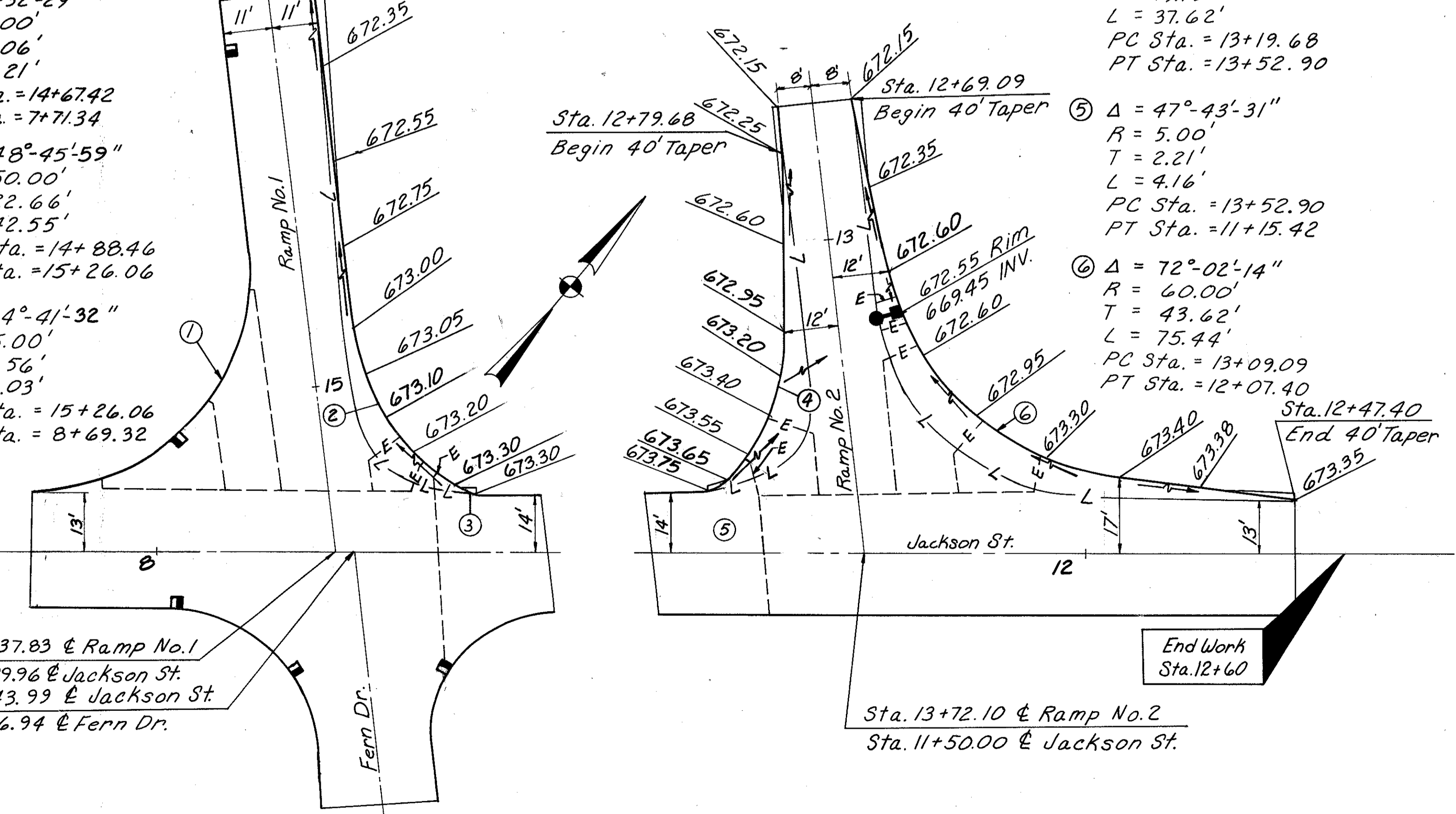

**CURVE DATA**

- ① Δ = 96°-32'-29"  
 R = 50.00'  
 T = 56.06'  
 L = 84.21'  
 PC Sta. = 14+67.42  
 PT Sta. = 7+71.34
- ② Δ = 48°-45'-59"  
 R = 50.00'  
 T = 22.66'  
 L = 42.55'  
 PC Sta. = 14+88.46  
 PT Sta. = 15+26.06
- ③ Δ = 34°-41'-32"  
 R = 5.00'  
 T = 1.56'  
 L = 3.03'  
 PC Sta. = 15+26.06  
 PT Sta. = 8+69.32

Begin Work Sta. 7+60

Sta. 15+37.83 @ Ramp No.1  
 Sta. 8+39.96 @ Jackson St.  
 Sta. 8+43.99 @ Jackson St.  
 Sta. 8+76.94 @ Fern Dr.

Sta. 13+72.10 @ Ramp No.2  
 Sta. 11+50.00 @ Jackson St.