

# SCHEMATIC PLAN

CALC BY T.J.H.  
DATE OCT. 1989  
CHKD BY W.A.C.  
DATE OCT. 1989

LAK-44-5.10

OHIO  
FHWA REGION 5

2  
24

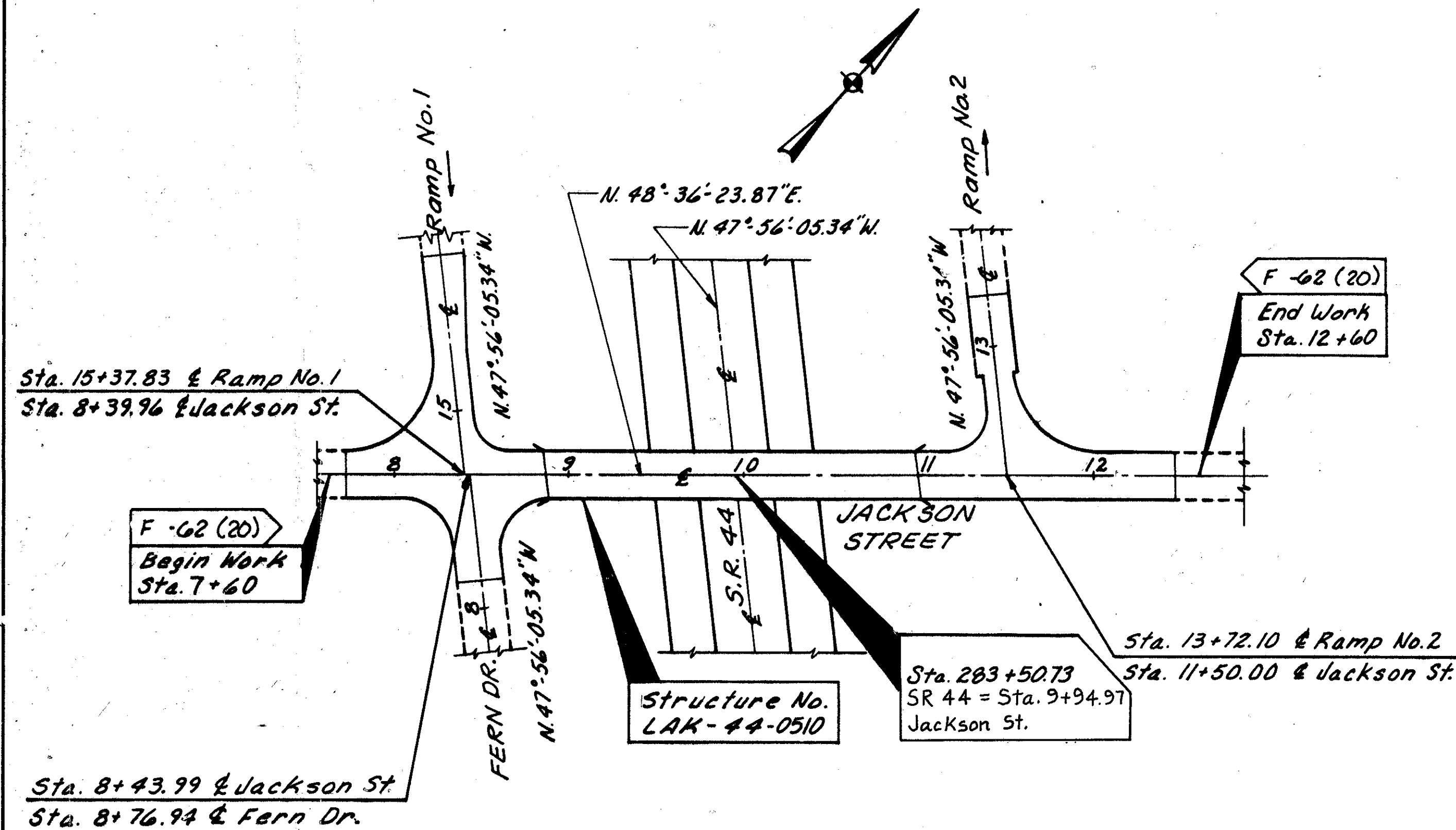
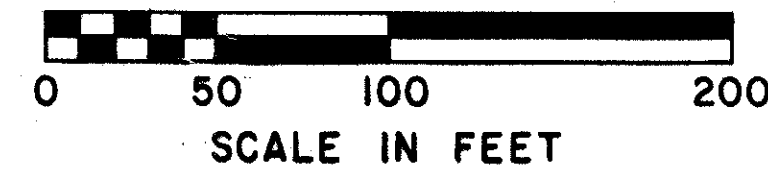

### ITEM 202 CURB REMOVED

- A. STA 14+04.00 RT.(RAMP NO. 1)  
TO STA 7+71.34 LT.(JACKSON ST.) = 147.8 FT.
  - B. STA 14+04.00 LT.(RAMP NO. 1)  
TO STA 8+69.32 LT.(JACKSON ST.) = 139.2 FT.
  - C. STA 13+09.00 RT.(RAMP NO. 2)  
TO STA 11+15.42 LT.(JACKSON ST.) = 61.2 FT.
  - D. STA 13+40.00 LT.(RAMP NO. 2)  
TO STA 12+01.16 LT.(JACKSON ST.) = 50.0 FT.
- SUBTOTAL = 398.2 LIN. FT.  
TOTAL ITEM 202 CURB REMOVED = 400.0 LIN. FT.

### ITEM 202 WEARING COURSE REMOVED

- A. RAMP NO. 1(STA 14+04.00 TO STA 14+16.50)  
(12.5 FT. X 11.0 FT.)/9 = 15.3 SQ. YDS.
  - B. JACKSON ST.(STA 7+69.00 TO STA 7+71.00)  
(2.0 FT. X 26.0 FT.)/9 = 5.8 SQ. YDS.
  - C. RAMP NO. 2(STA 12+69.09 TO STA 12+81.59)  
(12.5 FT. X 16.0 FT.)/9 = 22.3 SQ. YDS.
  - D. JACKSON ST.(STA 12+34.90 TO STA 12+47.40)  
(12.5 FT. X 26.0 FT.)/9 = 36.2 SQ. YDS.
- SUBTOTAL = 79.6 SQ. YDS.  
TOTAL ITEM 202 WEARING COURSE REMOVED = 81 SQ. YDS.

### ITEM 305 9" CONCRETE BASE

- A. RAMP NO. 1  
(584 SQ. FT.)/9 = 64.9 SQ. YDS.
  - B. RAMP NO. 2  
(1,236 SQ. FT.)/9 = 137.4 SQ. YDS.
- SUBTOTAL = 202.3 SQ. YDS.  
TOTAL ITEM 305 = 204 SQ. YDS.

### ITEM 310 SUBBASE, TYPE I, GRADING A, AS PER PLAN

- A. RAMP NO. 1  
(584 SQ.FT. X 0.5 FT.)/27 = 10.9 CU. YDS.
  - B. RAMP NO. 2  
(1,236 SQ.FT. X 0.5 FT.)/27 = 22.9 CU. YDS.
- SUBTOTAL = 33.8 CU. YDS.  
TOTAL ITEM 310 = 35 CU. YDS.

### ITEM 402 ASPHALT CONCRETE, AC-20

- A. RAMP NO. 1  
(3,540 SQ.FT. X 0.146 FT.)/27 = 19.2 CU. YDS.
  - B. JACKSON ST.(STA 7+69.00 TO 8+87.21)  
(3,182 SQ.FT. X 0.146 FT.)/27 = 17.3 CU. YDS.
  - C. FERN DR.  
(1,531 SQ.FT. X 0.146 FT.)/27 = 8.3 CU. YDS.
  - D. RAMP NO. 2  
(2,973 SQ.FT. X 0.146 FT.)/27 = 16.1 CU. YDS.
  - E. JACKSON ST.(STA 11+02.73 TO STA 12+47.40)  
(3,896 SQ.FT. X 0.146 FT.)/27 = 21.1 CU. YDS.
- SUBTOTAL = 82.0 CU. YDS.  
TOTAL ITEM 402 = 83 CU. YDS.

## CALCULATIONS

### ITEM 404 ASPHALT CONCRETE, AC-20

- A. RAMP NO. 1  
(3,540 SQ.FT. X 0.104 FT.)/27 = 13.7 CU. YDS.
  - B. JACKSON ST.(STA 7+69.00 TO STA 8+87.21)  
(3,182 SQ.FT. X 0.104 FT.)/27 = 12.3 CU. YDS.
  - C. FERN DR.  
(1,531 SQ.FT. X 0.104 FT.)/27 = 5.9 CU. YDS.
  - D. RAMP NO. 2  
(2,973 SQ.FT. X 0.104 FT.)/27 = 11.5 CU. YDS.
  - E. JACKSON ST.(STA 11+02.73 TO STA 12+47.40)  
(3,896 SQ.FT. X 0.104 FT.)/27 = 15.1 CU. YDS.
- SUBTOTAL = 58.5 CU. YDS.  
TOTAL ITEM 404 = 60 CU. YDS.

### ITEM 407 TACK COAT

- A. RAMP NO. 1  
(3,540 SQ.FT. / 9) X 0.10 GAL./SQ.YD. = 39.3 GAL.
  - B. JACKSON ST.(STA 7+69.00 TO STA 8+87.21)  
(3,182 SQ.FT. / 9) X 0.10 GAL./SQ.YD. = 35.4 GAL.
  - C. FERN DR.  
(1,531 SQ.FT. / 9) X 0.10 GAL./SQ.YD. = 17.1 GAL.
  - D. RAMP NO. 2  
(3,176 SQ.FT. / 9) X 0.10 GAL./SQ.YD. = 35.3 GAL.
  - E. JACKSON ST.(STA 11+02.73 TO STA 12+47.40)  
(3,896 SQ.FT. / 9) X 0.10 GAL./SQ.YD. = 43.3 GAL.
- SUBTOTAL = 170.4 GAL.  
TOTAL ITEM 407 = 172 GAL.

### ITEM 609 CURB, TYPE 2B

- A. STA 14+12.42 LT.(RAMP NO. 1)  
TO STA 8+69.32 LT.(JACKSON ST.) = 121.7 FT.
  - B. STA 12+79.68 RT.(RAMP NO. 2)  
TO STA 11+15.42 LT.(JACKSON ST.) = 82.0 FT.
  - C. STA 12+69.09 LT.(RAMP NO.2)  
TO STA 12+47.40 LT.(JACKSON ST.) = 155.9 FT.
- SUBTOTAL = 359.6 LIN. FT.  
TOTAL ITEM 609 CURB, TYPE 2B = 361 LIN. FT.

### ITEM 609 CURB, TYPE 6, AS PER PLAN

- A. STA 14+04.00 RT.(RAMP NO. 1)  
TO STA 7+71.34 LT.(JACKSON ST.) = 147.8 FT.
  - B. STA 14+04.00 LT  
TO STA 14+12.42 LT (RAMP NO. 1) = 8.5 FT.
  - C. STA 12+69.09 RT  
TO STA 12+79.68 RT. (RAMP NO. 2) = 10.6 FT.
- SUBTOTAL = 166.9 LIN. FT.  
TOTAL  
ITEM 609 CURB, TYPE 6, AS PER PLAN = 168 LIN. FT.

### ITEM 659 SEEDING AND MULCHING

- STA 283+00 TO STA 284+00 (S.R. 44)  
(152 FT. X 100 FT.)/9 = 1689 SQ. YDS.
- SUBTOTAL = 1689 SQ. YDS.  
TOTAL ITEM 659 SEEDING AND MULCHING = 1689 SQ. YDS.

### ITEM 659 COMMERCIAL FERTILIZER

- A. RAMP WIDENING AREAS (CROSS SECTION SHT. 9)  
(1347 SQ.YDS.) X (9 SQ.FT./SQ.YD.)  
X (20 POUNDS/1000 SQ.FT.)/2000 = 0.13 TONS
  - B. BRIDGE AREAS (CALCULATION, THIS SHT.)  
(1689 SQ.YDS.) X (9 SQ.FT./SQ.YD.)  
X (20 POUNDS/1000 SQ.FT.)/2000 = 0.16 TONS
- SUBTOTAL = 0.29 TONS  
TOTAL ITEM 659 COMMERCIAL FERTILIZER = 0.30 TONS

### ITEM 254 PAV'T. PLANING, PORTLAND CEMENT CONCRETE PAVEMENT

- A. JACKSON ST.(STA 7+71.00 TO STA 7+81.50)  
(10.5 FT. X 26.4 FT.)/9 = 30.8 SQ. YDS.
  - B. FERN DR.(STA 8+18.00 TO STA 8+30.50)  
(12.5 FT. X 26.0 FT.)/9 = 36.2 SQ. YDS.
- SUBTOTAL = 67.0 SQ. YDS.  
TOTAL ITEM 254 PAV'T. PLANING, PORTLAND CEMENT CONCRETE = 68 SQ. YDS.

### ITEM 301 2" BITUMINOUS AGGREGATE BASE, AC-20

- A. RAMP NO. 1  
(500 SQ. FT. X 0.167 FT.)/27 = 3.1 CU. YDS.
  - B. RAMP NO. 2  
(1033 SQ. FT. X 0.167 FT.)/27 = 6.4 CU. YDS.
- SUBTOTAL = 9.5 CU. YDS.  
TOTAL ITEM 301 = 10 CU. YDS.

### ITEM SPECIAL PRESSURE RELIEF JOINT, TYPE C

- A. JACKSON STREET  
STA. 7+82 = 29 LIN. FT.
  - B. JACKSON STREET  
STA. 12+21 = 30 LIN. FT.
- SUBTOTAL = 59 LIN. FT.  
TOTAL ITEM SPECIAL, PRESSURE RELIEF JOINT, TYPE C = 59 LIN. FT.