

LAKE COUNTY
Sec. LAK-44-379

NOTE: All Water Work Pertaining to Service Connections, Hydrants and Water Meters and Not Itemized in Estimated Quantities Shall be Performed By The City of Painesville Water Department.

ESTIMATED QUANTITIES (U-388 (12) MUNICIPAL)
10" WATER MAIN

I-124	122 LIN. FT.	10" CAST IRON WATER MAIN, CLASS 200.
I-124	220 LIN. FT.	10" CAST IRON WATER MAIN.
I-124	4 EACH	10" CAST IRON 1/8 BEND.
I-124	4 EACH	10" CAST IRON 1/16 BEND.
I-124	2 EACH	10" x 6" CAST IRON REDUCER.
I-124	1 EACH	10" x 6" CAST IRON WYE.
I-124	1 EACH	10" x 6" CAST IRON TEE.
I-124	2 EACH	10" GATE VALVE AND VALVE BOX.

6" WATER MAIN

I-124	10 LIN. FT.	6" CAST IRON WATER MAIN.
I-124	1 EACH	6" GATE VALVE AND VALVE BOX.

TEMPORARY WATER MAIN

6" TEMPORARY WATER MAIN, FITTINGS, VALVES AND VALVE BOXES SHALL BE FURNISHED BY THE CITY OF PAINESVILLE, AND THE CONTRACTOR SHALL INSTALL THEM.
AFTER THE WATER MAIN IS NO LONGER NEEDED THE CONTRACTOR SHALL REMOVE, AND CLEAN THE SALVAGED MATERIAL. MATERIALS FURNISHED BY THE CITY OF PAINESVILLE SHALL BE STORED AT THE CITY OF PAINESVILLE STOREYARDS, 459-469 STORES STREET, PAINESVILLE, OHIO.

CONTRACTOR SHALL BE RESPONSIBLE FOR TRANSPORTING THESE MATERIALS FROM THE STOREYARDS TO THE JOB SITE, AND TRANSPORTING ALL SALVAGED MATERIALS FROM THE JOB SITE TO THE STOREYARD.

ESTIMATED QUANTITIES
6" TEMPORARY WATER MAIN

	473 LIN. FT.	6" CAST IRON WATER MAIN.
	2 EACH	6" CAST IRON 1/4 BEND.
	3 EACH	6" CAST IRON 1/8 BEND.
	2 EACH	6" CAST IRON 1/16 BEND.
	2 EACH	6" GATE VALVE & VALVE BOX.

I-124	473 LIN. FT.	INSTALL 6" CAST IRON WATER MAIN AND FITTINGS.*
I-124	473 LIN. FT.	REMOVE, CLEAN AND STORE 6" CAST IRON WATER MAIN AND FITTINGS.**

* INCLUDES COST OF TRANSPORTING MATERIALS FROM THE STOREYARD TO THE JOB SITE.
** INCLUDES COST OF TRANSPORTING SALVAGED MATERIALS FROM THE JOB SITE TO THE STOREYARD.

NOTE: COST OF REMOVAL AND DISPOSAL OF EXISTING SANITARY SEWERS AND WATER MAINS TO BE INCLUDED IN THE UNIT PRICE BID FOR ITEM E-I EXCAVATION.

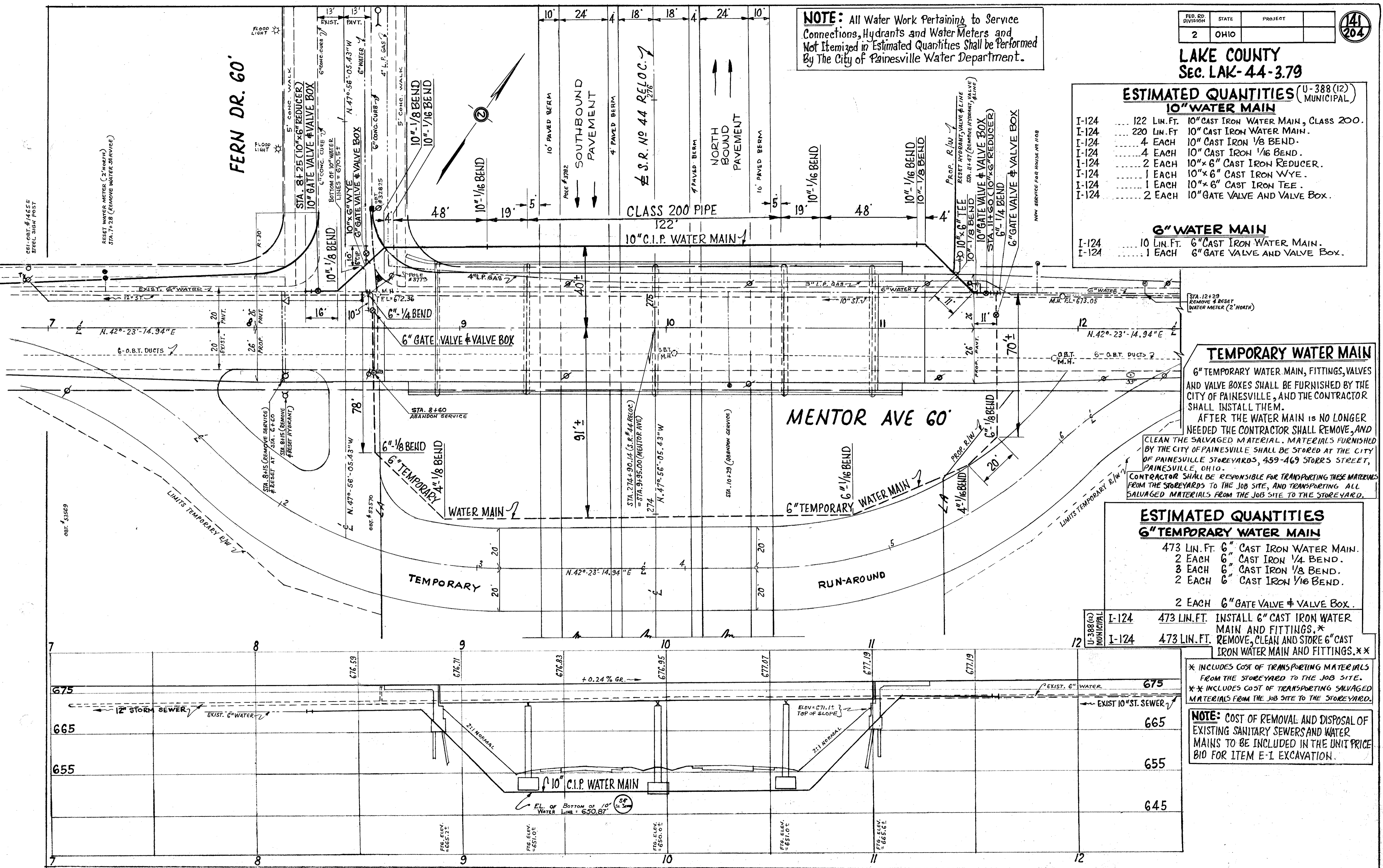

MENTOR AVE ... 6" TEMPORARY WATER MAIN & RELOC. of 10" WATER MAIN