

Remove and Dispose of Conc. Gutter Curb and Replace with Temporary Run-Around Pavt. For Item E-8, Conc. Gutter Curb Removal, See Calculation Sheet No 11.

TYPICAL SECTION RUN-AROUND

SCALE: HORIZONTAL: 1/8"=1'-0", VERTICAL: 1/4"=1'-0"

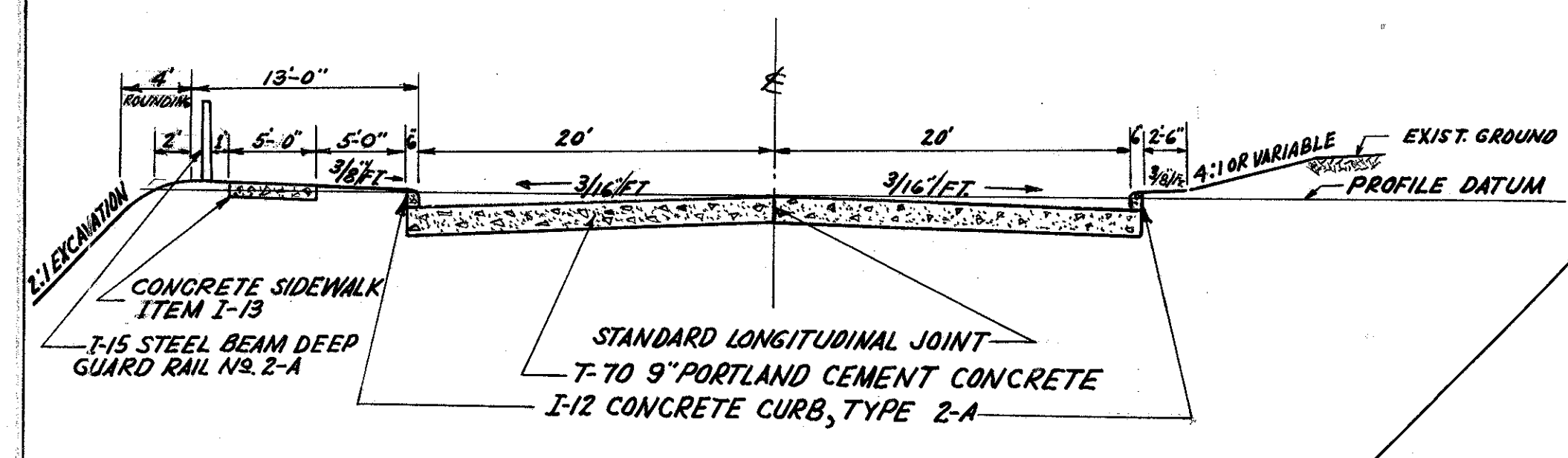

RUN-AROUND & CURVE DATA				CURVE DATA	
①	②	③	④	⑤	⑥
R = 200'	Δ = 44°33'41"	D = 28°38'52"	T = 81.95'	L = 155.55'	Ch = 151.66'
R = 40'	Δ = 80°29'02"	T = 33.85'	L = 56.19'	Ch = 51.68'	
R = 118'	Δ = 18°08'04"	D = 48°33'22"	T = 18.60'	L = 37.35'	Ch = 37.19'
R = 5'	Δ = 116°35'57"	L = 10.17'			

BULLNOSE CURVE DATA

R = 150'	Δ = 126°46'52"	L = 3.32'
----------	----------------	-----------

NOTE: FOR PLAN & PROFILE OF MENTOR AVE & UTILITY LOCATIONS, SEE SHEET NO. 130.

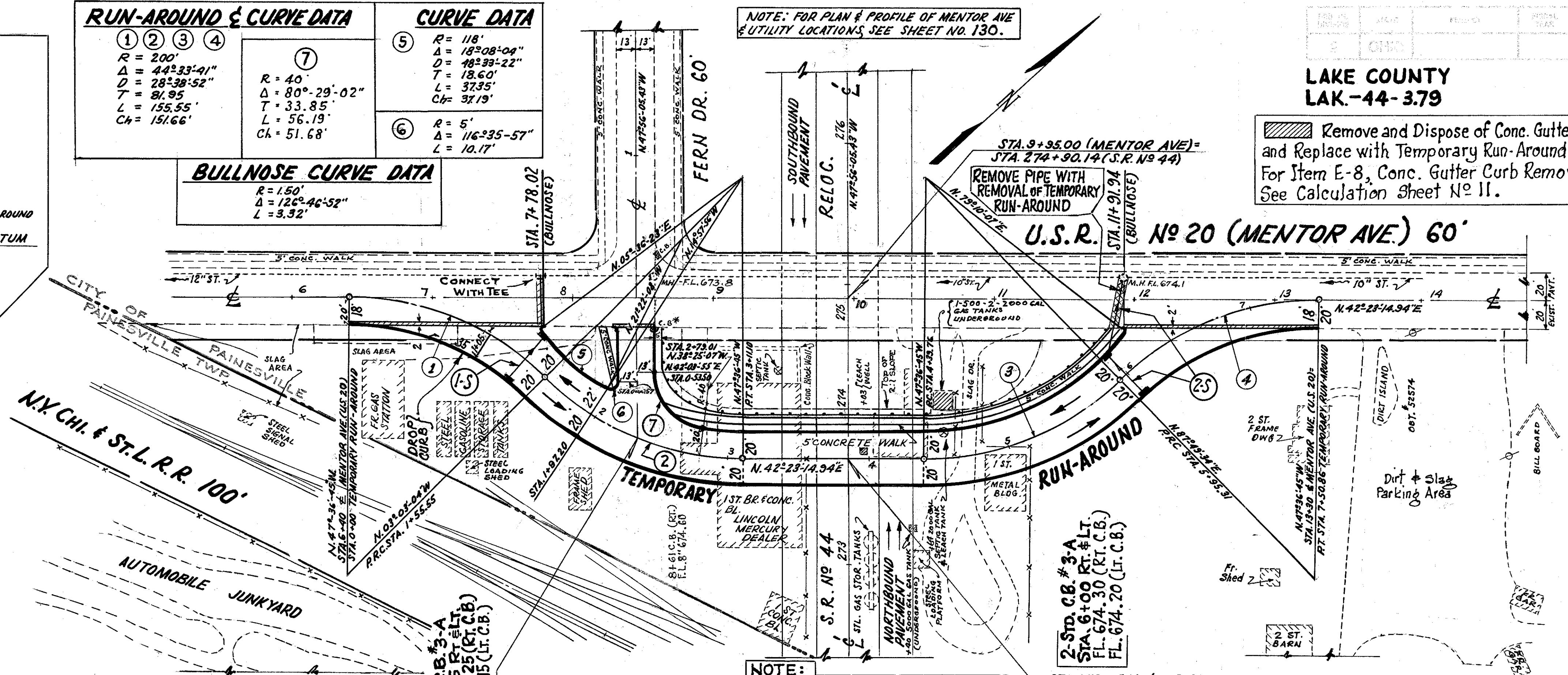

NOTE: For Details of Temporary 6" Water Main, See Sheet No 141.

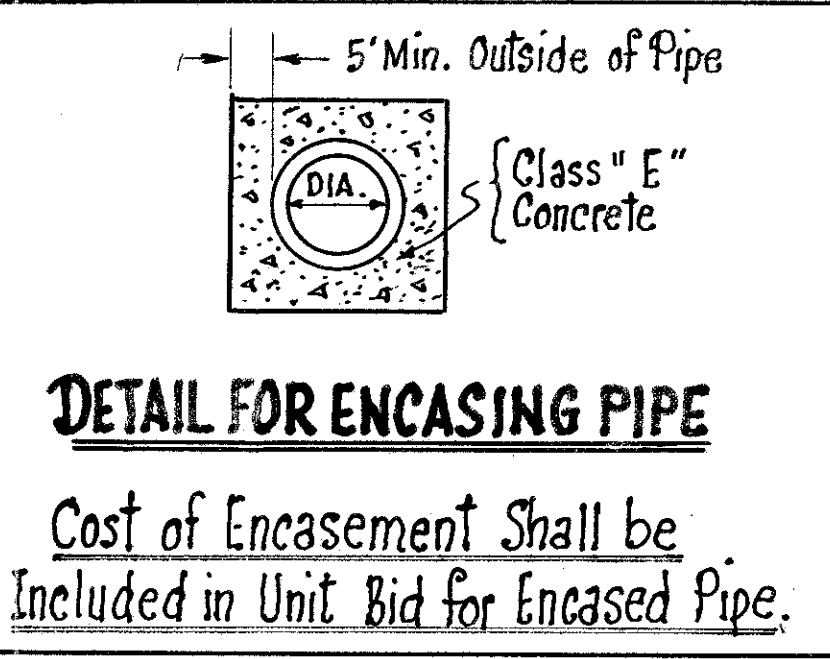

B.M. #5...R.R. SPIKE SET IN POLE (NO. NUMBER)
STA. 272+30 (S.R. 44) 145' W. OF E, ADJ. ELEV. = 680.443

ITEM S-15 INCLUDED WITH STRUCTURE QUANTITIES, SEE SHEET No 171.

ITEM S-15 RUN-AROUND QUANTITIES *			
I-70 #	I-15	I-13	I-12
9" PORTLAND CEMENT CONCRETE	GUARD RAIL STD. TYPE	4" CONCRETE WALK	STD. TYPE 2-A CONG. CURB
SQ. YDS.	LIN. FT.	SQ. FT.	LIN. FT.
2874	375	1920	1294

* NOTE: All Items Required to Construct, Maintain and Subsequently Remove the TEMPORARY RUN-AROUND Shall be Included in The LUMP SUM BID for Item S-15, with the Exception of the Items for Installing the STORM SEWER SHOWN IN THE DRAINAGE TABLE.

** CONSTRUCTION OF CONCRETE PAVEMENT SHALL BE IN ACCORDANCE WITH SECTION S-15.06 OF THE SPECIFICATIONS.

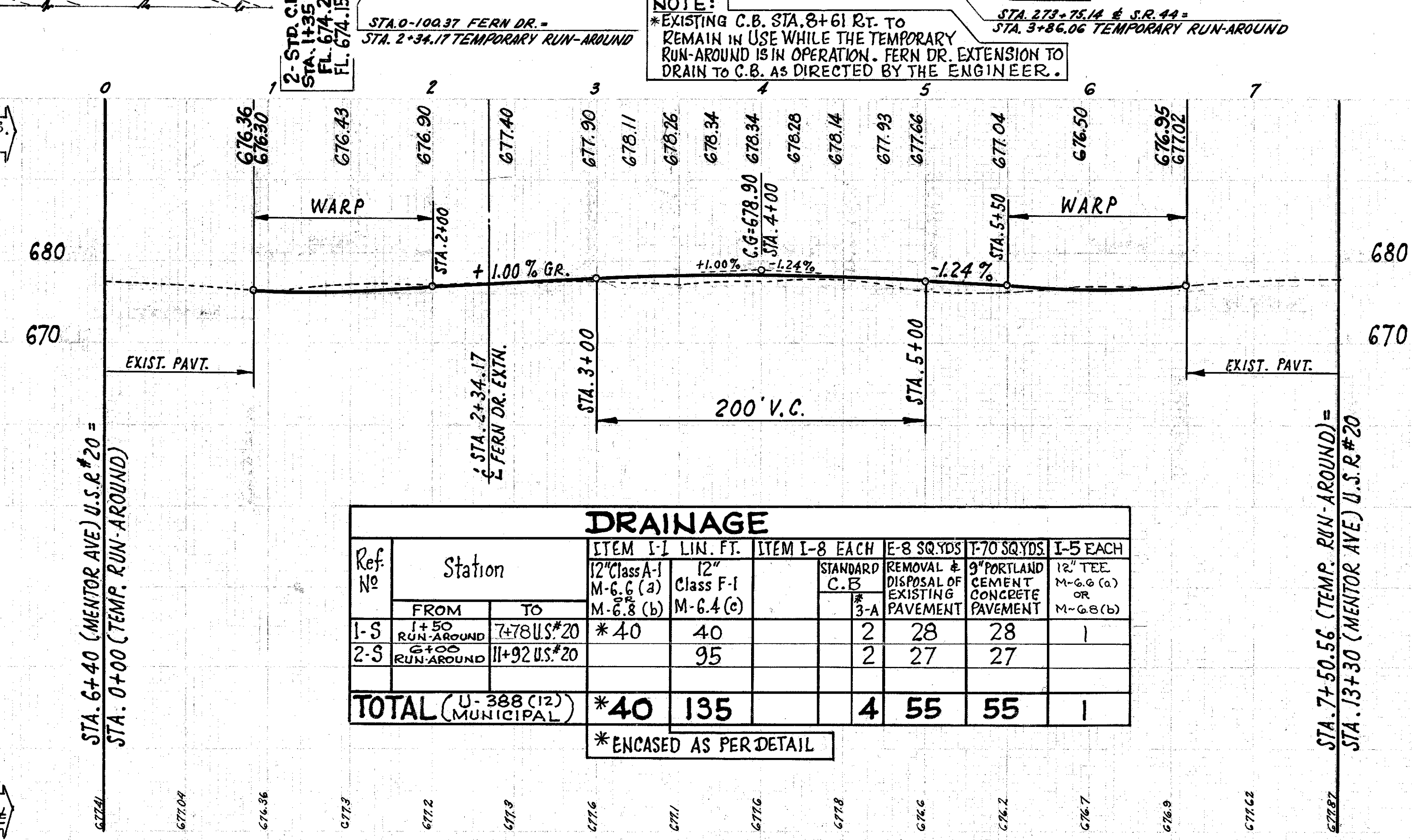

DRAINAGE

Ref. No	Station		ITEM I-1 LIN. FT.	ITEM I-8 EACH	E-8 SQ. YDS.	T-70 SQ. YDS.	I-5 EACH	
	FROM	TO	12" Class A-1 M-6.6 (a) M-6.8 (b)	12" Class F-1 M-6.4 (c)	STANDARD C.B. 3-A	REMOVAL & DISPOSAL OF EXISTING PAVEMENT	9" PORTLAND CEMENT CONCRETE PAVEMENT	12" TEE M-6.6 (a) OR M-6.8 (b)
I-5	1+50 RUN-AROUND	7+78 U.S.#20	*40	40	2	28	28	1
I-5	0+00 RUN-AROUND	11+92 U.S.#20		95	2	27	27	
TOTAL (U-388 (12) MUNICIPAL)			*40	135	4	55	55	1

* ENCASED AS PER DETAIL