

LAKE COUNTY
SEC. LAK - 44-3.79

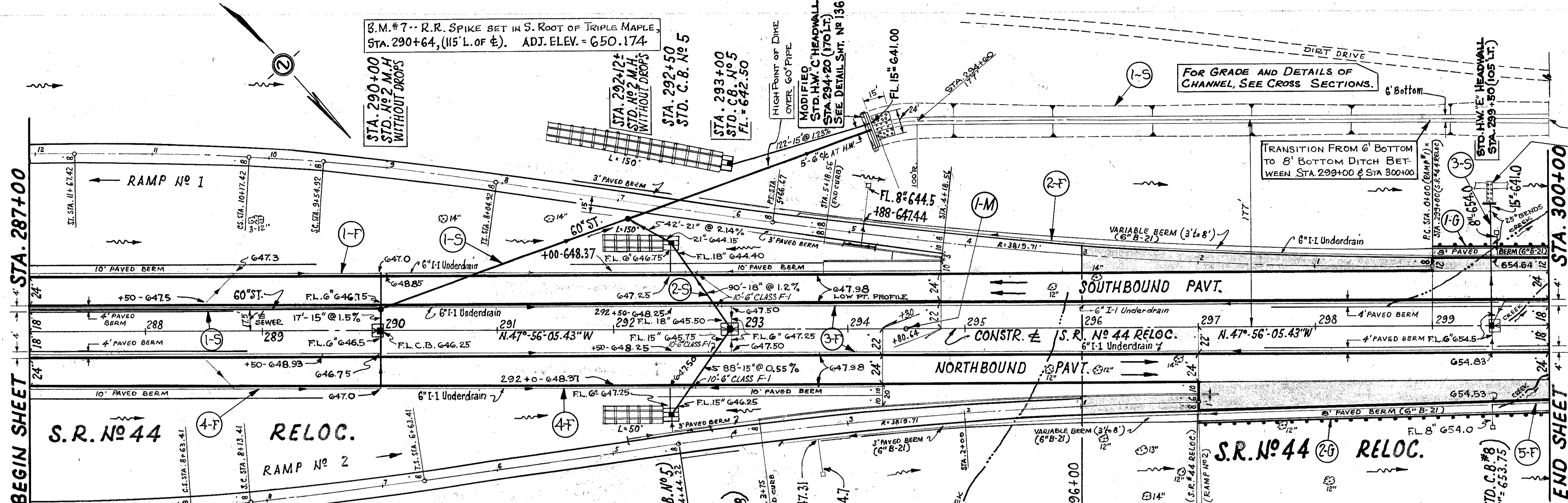

NOTE: FOR PLAN & PROFILE OF RAMP NO 1 & 2, SEE SHT. NO 125 & 126

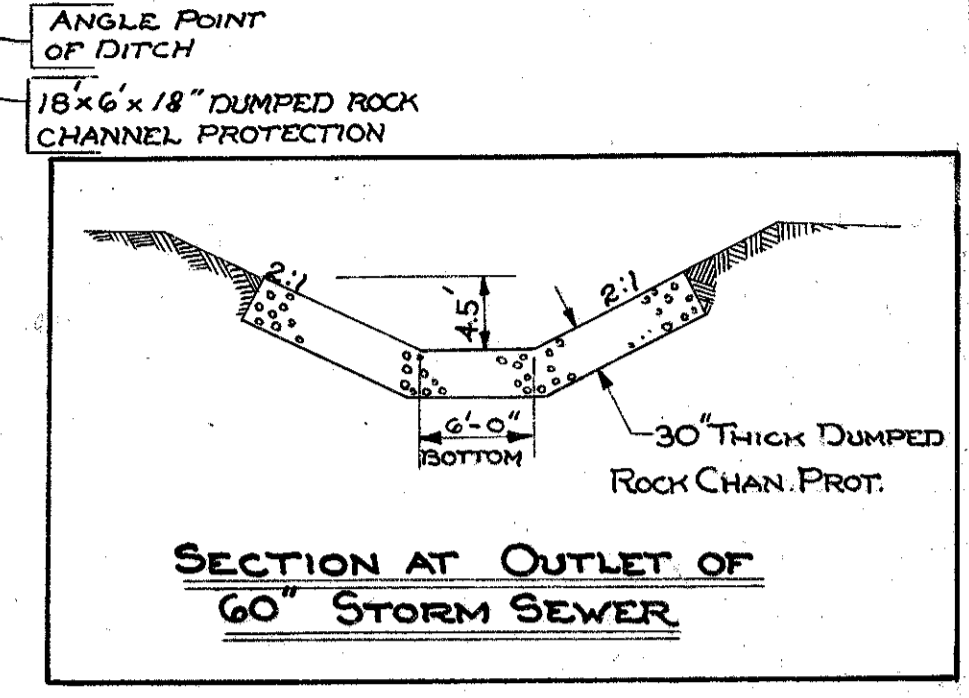
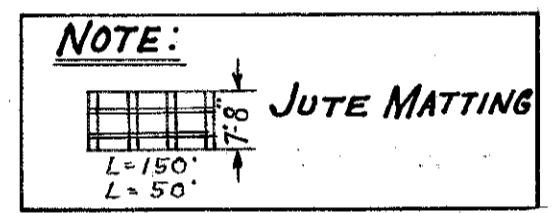

END U-388 (12) MUNICIPAL
RESUME UG-388 (12) MUNICIPAL

QUANTITIES INCLUDED WITH U-388 (12) MUNICIPAL.

DATUM ELEV. = INSIDE EDGE OF PAVT.

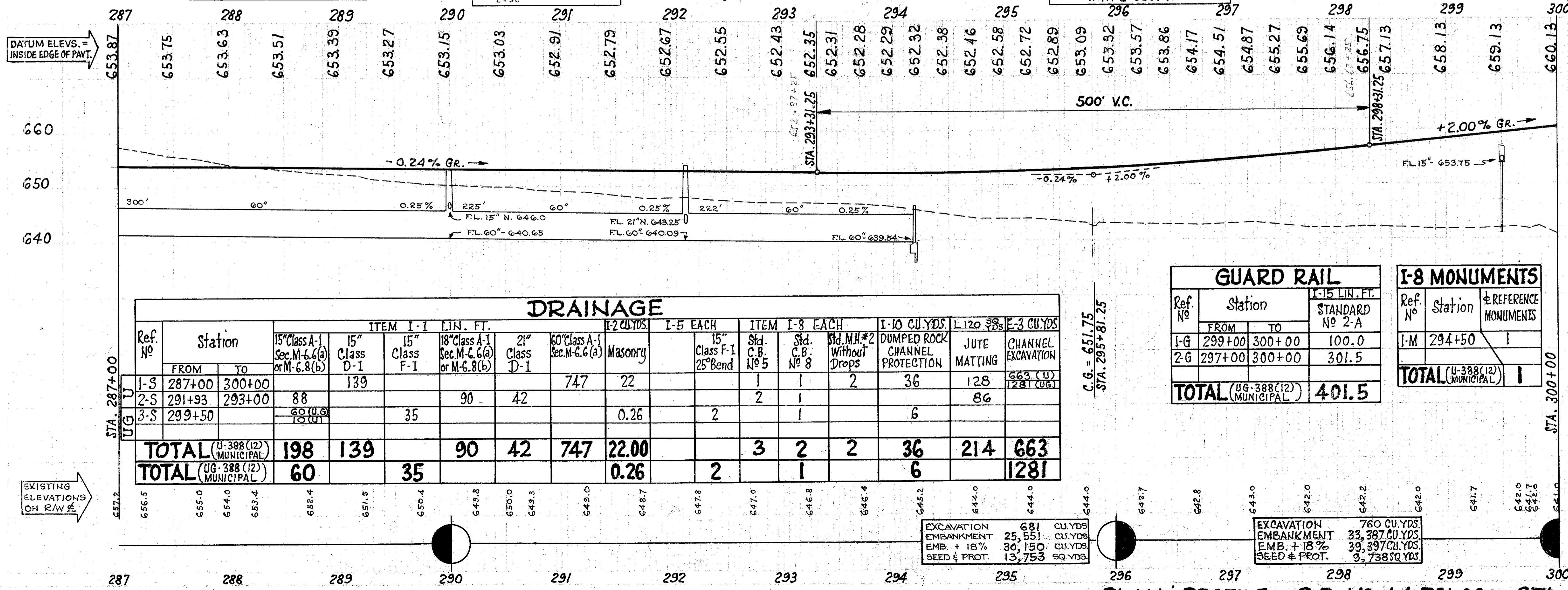

Ref. No	Station	ITEM I-1 LIN. FT.						ITEM I-5 EACH			ITEM I-8 EACH				
		15" Class A-1 Sec. M-6.6(a) or M-6.8(b)	15" Class D-1	15" Class F-1	18" Class A-1 Sec. M-6.6(a) or M-6.8(b)	21" Class D-1	60" Class A-1 Sec. M-6.6(a)	Masonry	15" Class F-1 25' Bend	Std. C.B. No 5	Std. C.B. No 8	Std. M.H. #2 Without Drops	DUMPED ROCK CHANNEL PROTECTION	JUTE MATTING	CHANNEL EXCAVATION
1-S	287+00	300+00													
2-S	291+93	293+00	88	139		90	42	747	22						
3-S	299+50		60 (U) (100)		35				0.26	2			6		
TOTAL (U-388 (12) MUNICIPAL)			198	139		90	42	747	22.00	3	2	2	36	214	663
TOTAL (UG-388 (12) MUNICIPAL)			60		35				0.26	2	1		6		1281

GUARD RAIL			
Ref. No	Station	I-15 LIN. FT. STANDARD No 2-A	
1-G	299+00	300+00	100.0
2-G	297+00	300+00	301.5
TOTAL (UG-388 (12) MUNICIPAL)			401.5

I-8 MONUMENTS		
Ref. No	Station	REFERENCE MONUMENTS
1-M	294+50	1
TOTAL (U-388 (12) MUNICIPAL)		1

Ref. No	Station	ITEM I-1 LIN. FT.			ITEM I-5 EACH			ITEM I-8 YDS.							
		8" OUTLET Class F-1 Sec. M-6.4 (a) or M-6.4 (b)	6" Class F-1 Sec. M-6.4 (c) or M-6.4 (d)	6" Class F-1 Sec. M-6.4 (e) or M-6.4 (f)	6" Tee	6" 90° Bend	6" 60° Bend	3-29 CU. YDS. EROSION PAD No 2	AGGREGATE	30" THICK DUMPED ROCK CHAN. PROT.					
U 1-F	287+00	294+90													
UG 2-F	4+88 RAMP	299+44	10												
UG 3-F	287+00	300+00			110	3 (U)									
U 4-F	287+00	294+30													
UG 5-F	297+00	300+00													
TOTAL (U-388 (12) MUNICIPAL)			679	2861	100	69	11	5	2	0.6					
TOTAL (UG-388 (12) MUNICIPAL)			1522	20	1	3									