

PLOTTED FROM: I:\PROJECTS\18391\dgn\18391.mdc.dgn

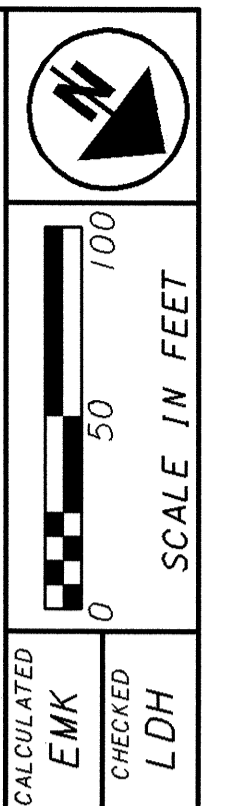

**TRAFFIC CONTROL DETAIL - S.R. 44
PHASE I**

**LAKE COUNTY
LAK-2/44-13.05/4.14**

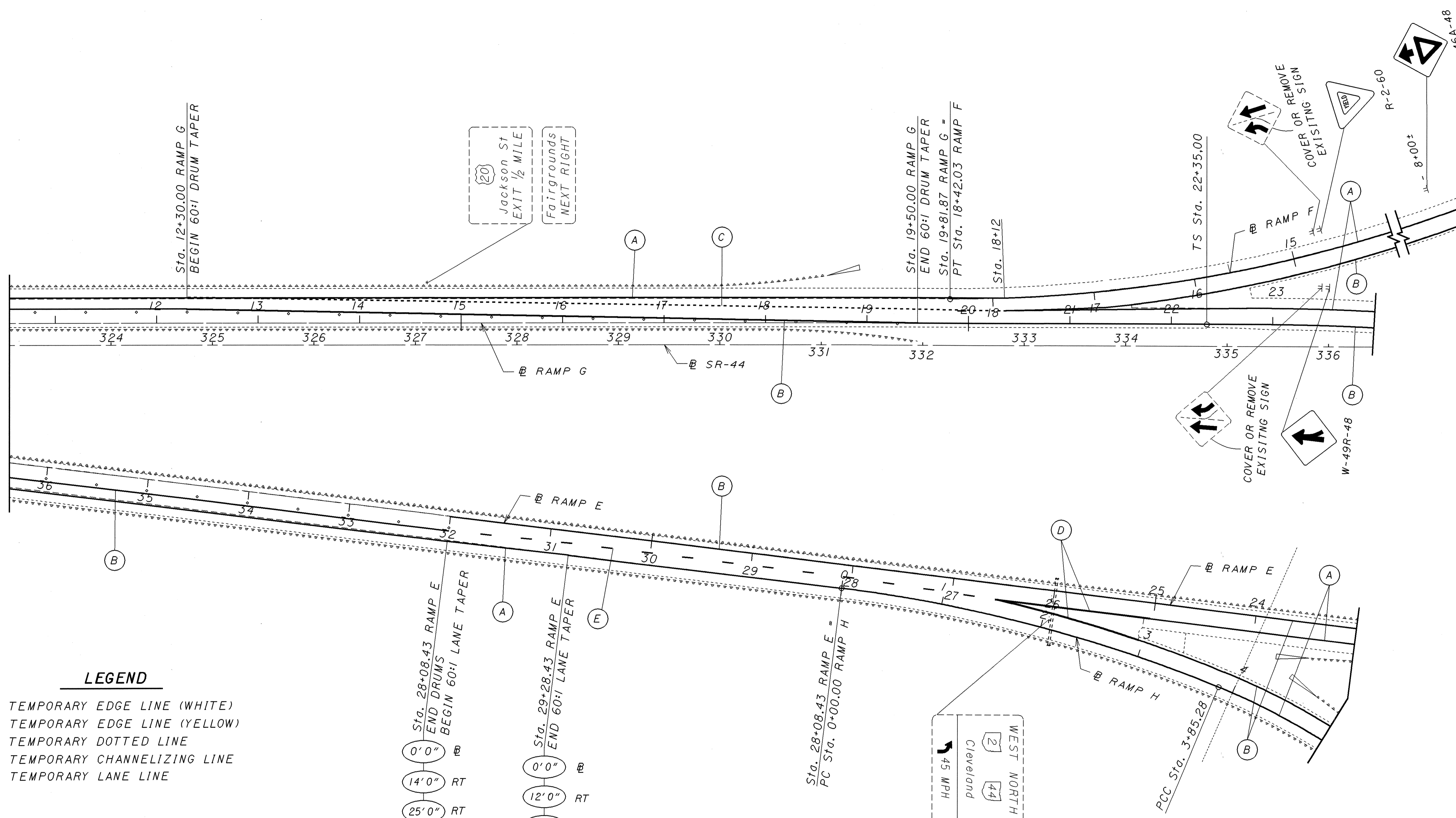

LEGEND

- (A) TEMPORARY EDGE LINE (WHITE)
- (B) TEMPORARY EDGE LINE (YELLOW)
- (C) TEMPORARY DOTTED LINE
- (D) TEMPORARY CHANNELIZING LINE
- (E) TEMPORARY LANE LINE

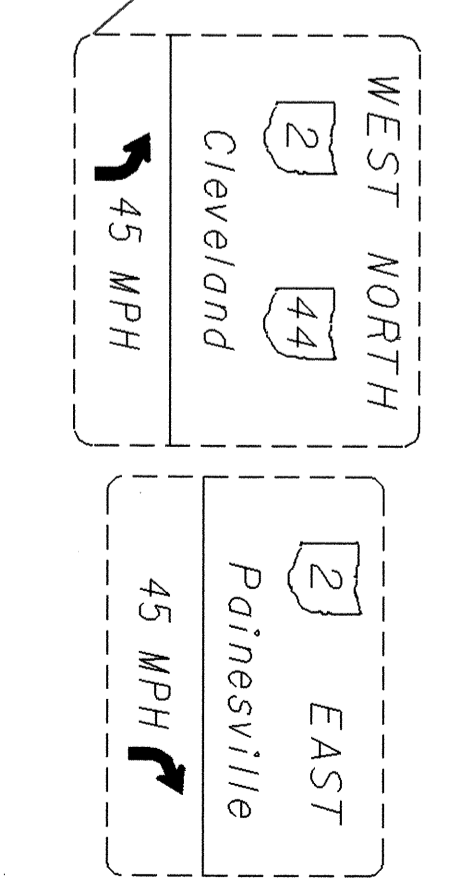
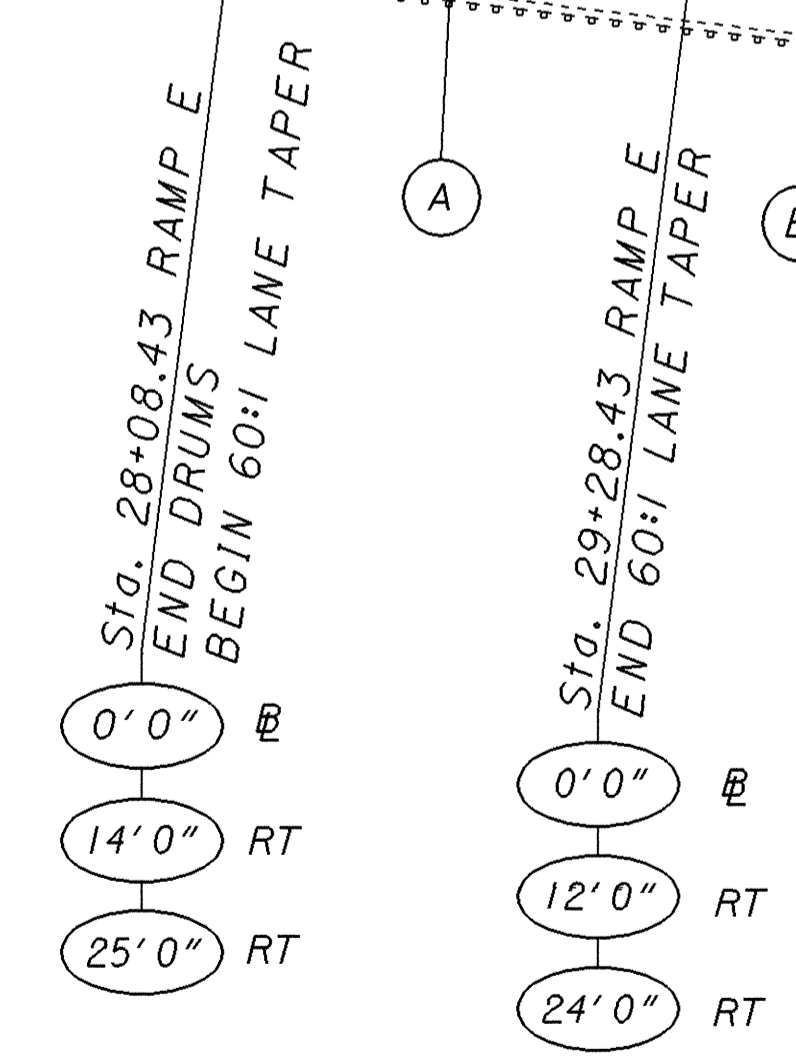
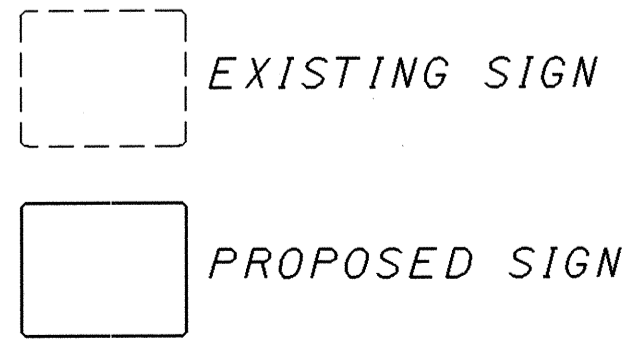

NOTE: ALL COSTS FOR PLACING R-2-60, W-46A-48 AND W-49R-48 SIGNS ALONG WITH POSTS SHALL BE INCLUDED IN ITEM 614, LUMP, MAINTAINING TRAFFIC.

NOTE: DUE TO MAINTENANCE OF TRAFFIC TAPERS AND LANE CLOSURES, THE CONTRACTOR MAY REVISE THE LENGTH OF THE PROPOSED UNDERDRAIN AND 4' SHOULDER REPLACEMENT, WITH THE APPROVAL OF THE PROJECT ENGINEER.