

LAKE COUNTY
LAK-44-170

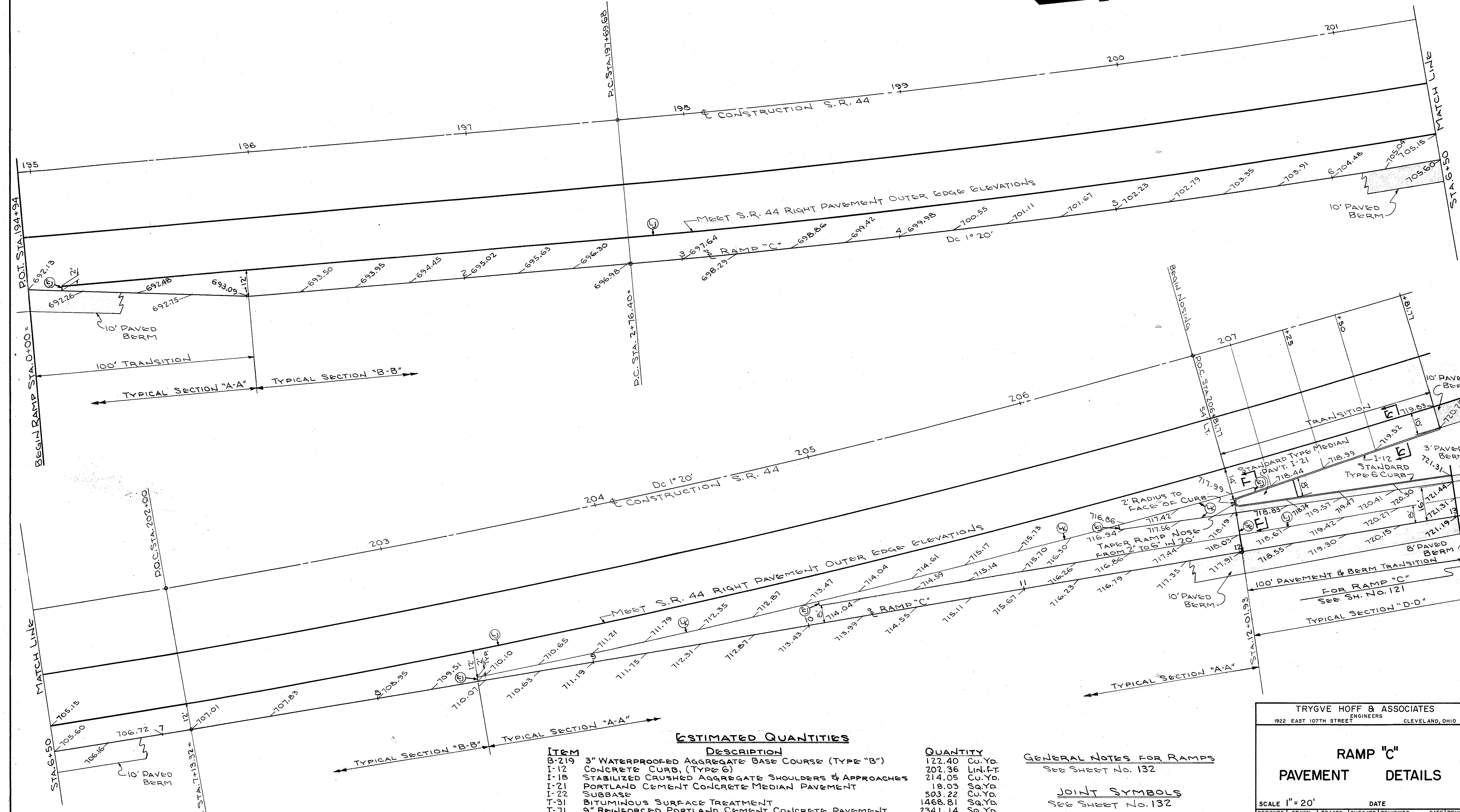
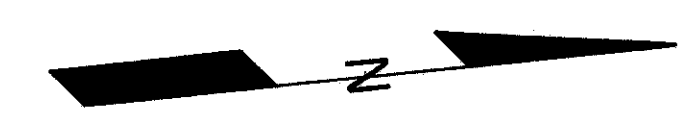

ESTIMATED QUANTITIES

ITEM	DESCRIPTION	QUANTITY
B-219	3" WATERPROOFED AGGREGATE BASE COURSE (TYPE "B")	122.40 Cu.Yd.
I-12	CONCRETE CURB, (TYPE G)	202.36 LIN.FT.
I-18	STABILIZED CRUSHED AGGREGATE SHOULDERS & APPROACHES	214.05 Cu.Yd.
I-21	PORTLAND CEMENT CONCRETE MEDIAN PAVEMENT	18.03 Sq.Yd.
I-22	SUBBASE	503.22 Cu.Yd.
T-31	BITUMINOUS SURFACE TREATMENT	1468.81 Sq.Yd.
T-71	9" REINFORCED PORTLAND CEMENT CONCRETE PAVEMENT	2341.14 Sq.Yd.

GENERAL NOTES FOR RAMPS
SEE SHEET NO. 132

JOINT SYMBOLS
SEE SHEET NO. 132

TRYGVE HOFF & ASSOCIATES
ENGINEERS
1922 EAST 107TH STREET CLEVELAND, OHIO

**RAMP "C"
PAVEMENT DETAILS**

SCALE 1" = 20'	DATE
DESIGNED	TRACED
DRAWN	CHECKED
GCH	D.M.J.
	T.L.L.
	T.L.L.
	10/11/58