

**CURVE DATA**  
 P.I. Sta. 21+81.97  
 $\Delta = 27^{\circ}-10'-44''$   $\Delta c = 9^{\circ}-10'-44''$   
 $L_c = 50.99'$   
 $R_c = 318.31'$   $T_s = 127.22'$   
 $L_s = 100'$   $E_s = 10.52'$   
 $O_s = 9^{\circ}-00'-00''$   $X_c = 99.75'$   
 $L.T. = 66.75'$   $Y_c = 5.23'$   
 $S.T. = 33.41'$   $K = 49.96'$   
 $L.C. = 99.89'$   $p = 1.31'$

**ROADWAY PAVEMENT QUANT.**

STATION	TO STATION	STRUCTURE N <sup>o</sup> OR REFERENCE N <sup>o</sup>	REFERENCE N <sup>o</sup> OR STRUCTURE N <sup>o</sup>	TYPE (DEPTH)	LIN. FT.
14+00 TO 18+50 <td>18+50</td> <td>1-R</td> <td>2-R</td> <td>GUARD RAIL</td> <td>450</td>	18+50	1-R	2-R	GUARD RAIL	450
18+50 TO 20+02.57	20+02.57	2-R	2-R	STEEL BEAM	650
<b>TOTAL</b>					<b>1100</b>

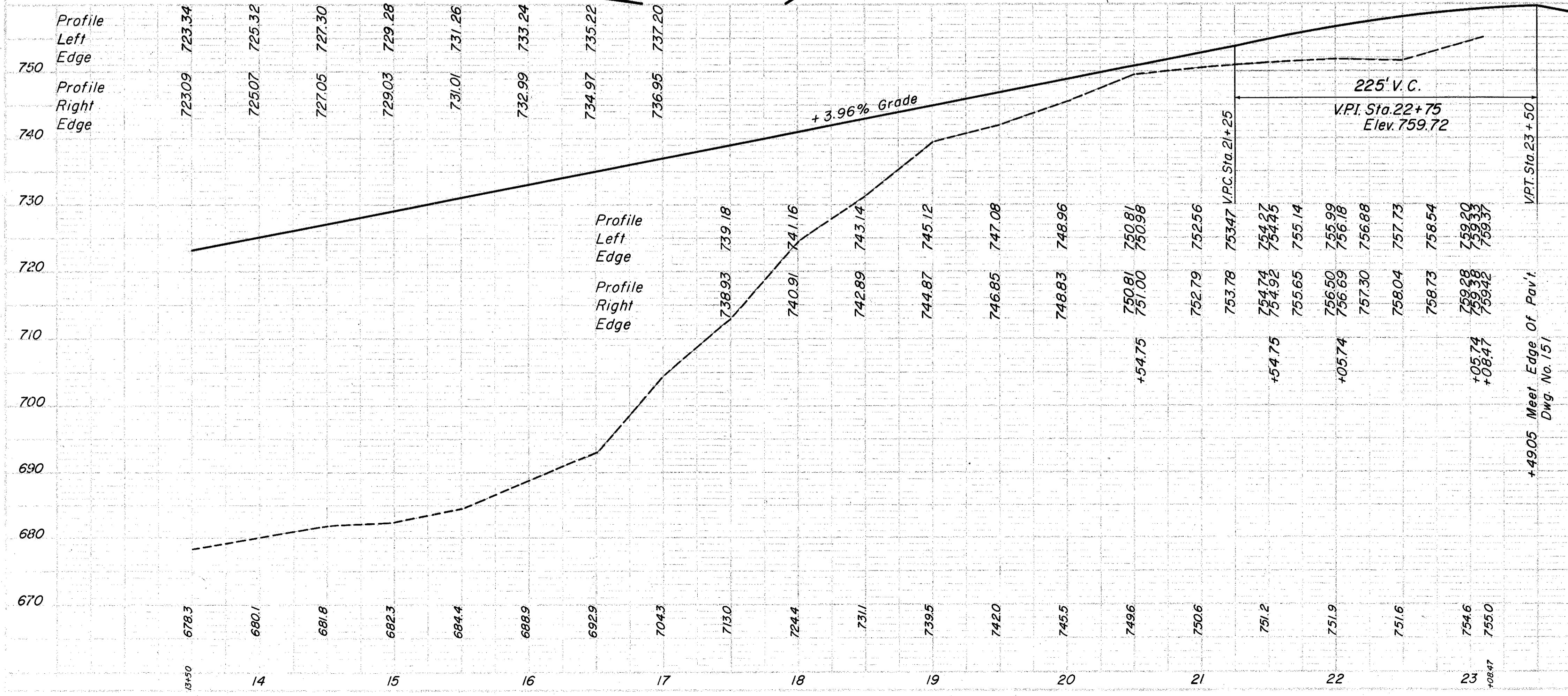

**DRAINAGE QUANTITIES**

STATION	TO STATION	STRUCTURE N <sup>o</sup> OR REFERENCE N <sup>o</sup>	REFERENCE N <sup>o</sup> OR STRUCTURE N <sup>o</sup>	SIDE	TYPE	LIN. FT.
16+00 TO 23+00	23+00	1-D	1-D	LEFT	6" PIPE SPECIAL	16.7
18+50 TO 15+50	15+50	2-D	2-D	RIGHT	6" PIPE SPECIAL	16.7
<b>TOTAL</b>						<b>33.4</b>

PLAN & PROFILE RAMP "C" STA. 13+50 TO STA. 23+08.47