

FOR TYPICAL SECTIONS SEE SHEET 12
 FOR CROSS SECTIONS SEE SHEETS 255-257
 FOR MAINLINE PLAN & PROFILE SEE SHEET 120
 FOR INTERSECTION DETAILS SEE SHEET 314
 FOR SIGNING PLANS SEE SHEET 363-365
 FOR PAVEMENT MARKING DETAILS SEE SHEET 352-353
 FOR DRIVEWAY PROFILES SEE SHEET 300-301
 FOR DRIVEWAY DETAILS SEE SHEET 333-334
 FOR UNDERDRAIN QUANTITIES SEE SHEET 52-55
 FOR SIGNAL PLANS SEE SHEET 346
 FOR CURB DETAILS SEE SHEET 332

ROADWAY				WALK REMOVED	CURB REMOVED	CURB, TYPE 7 AS PER PLAN
REF.	LOCATION	SQ. F.	LF.			
R-1	STA. 7+35.00 TO STA. 7+83.00 30.00' LT.			202	202	609
R-2	STA. 8+17.00 TO STA. 8+40.00 30.00' LT.					48
R-3	STA. 7+35.00 TO STA. 9+75.00 LT.	675				23
R-4	STA. 8+26.00 31.00' RT. TO STA. 8+40.00 40.00' RT.		25			
R-5	STA. 8+33.00 31.00' RT. TO STA. 8+40.00 40.00' RT.					20
R-6	STA. 6+70.00 TO STA. 9+30.00 RT.	1130				
R-7	STA. 6+71.00 33.00' RT. TO STA. 6+90.00 30.00' RT.					22
R-8	STA. 7+17.00 30.00' RT. TO STA. 7+69.00 30.00' RT.					52
TOTALS				1805	25	165

REF.	LOCATION	EA	LF	TOTALS
604	MANHOLE ADJUSTED TO GRADE AS PER PLAN		1	1
604	MANHOLE NO. 3		1	1
604	CATCH BASIN NO. 3A, AS PER PLAN		2	2
603	12" CONDUIT, TYPE B, 706.02 WITH JOINTS AS PER 706.11		117	117
TOTALS				121

DRAINAGE & SANITARY	
REF.	LOCATION
D-1	STA. 9+00.00, 20.00' RT. TO STA. 9+00.00, 0.00'
D-2	STA. 8+50.00, 20.00' RT. TO STA. 9+00.00, 0.00'
D-3	STA. 9+00.00, 0.00' TO STA. 9+43.00, 0.00'
S-1	STA. 6+41.50, 17.00' RT.
TOTALS	

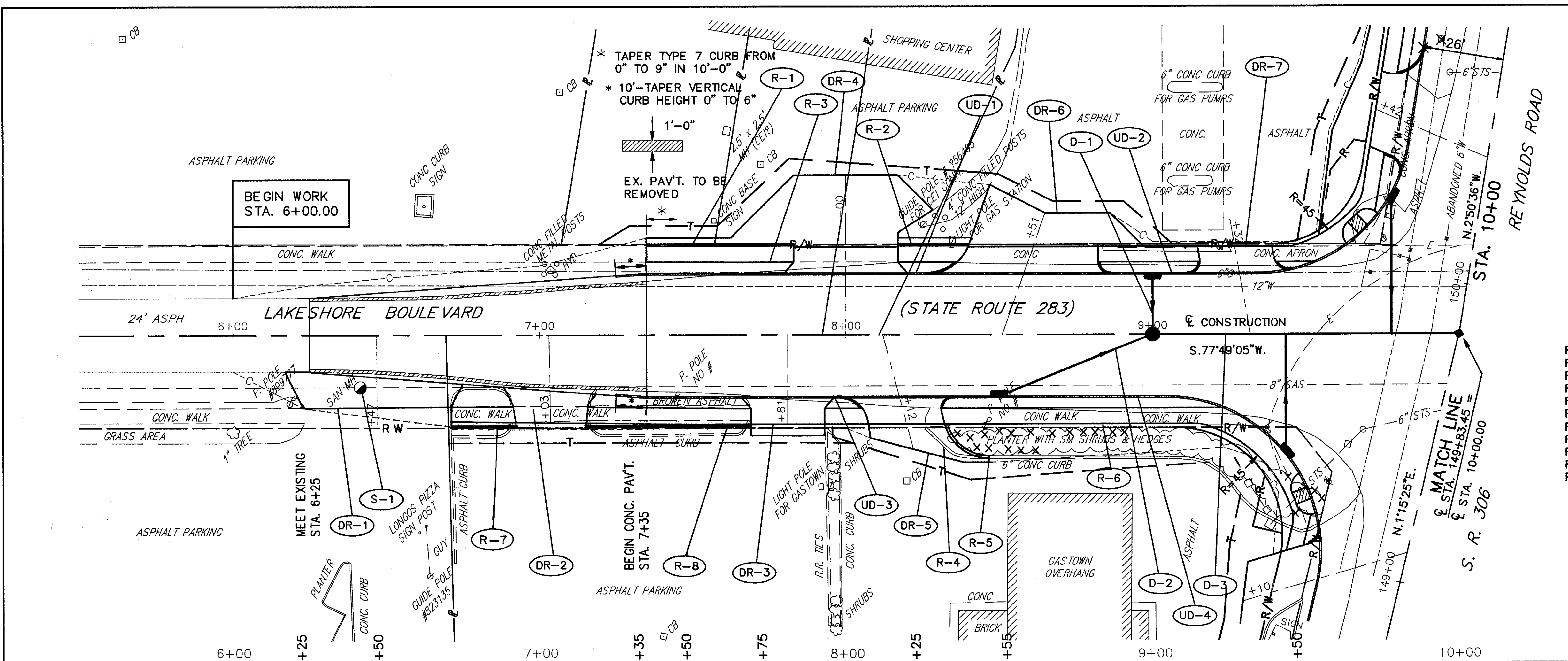

STATION	ELEVATION	GRADIENT	REMARKS
6+00	627.20		MEET EXIST. STA. 6+25
6+25	627.10		
7+00	627.00		
7+35	627.01		BEGIN CONC. PAVT. STA. 7+35
7+50	626.97	-0.24%	
7+75	626.90		
8+00	626.81		
8+25	626.71		
8+50	626.58		
9+00	626.36		
9+50	626.12		
10+00	625.88		MATCH LINE STA. 10+00.00

120' VERTICAL CURVE
 P.V.I. STA. 7+95
 ELEV. 626.86
 K=500
 DESIGN SPEED=40 MPH

EX. 12" WATER
 EX. 8" SAS
 EX. 8" S/S
 EX. 6" S/S
 EX. 6" S/S
 EX. 12" WATER
 EX. 12" CONDUIT TYPE B @ 1.00%
 EX. 12" CONDUIT TYPE B @ 1.00%
 EX. 12" TEE S
 EX. 12" TEE N

EX. S/S MH. STA. 6+41.5, 17.00' RT. INV. 8"E & W. 617.98 ADJUST TO GRADE COVER 626.84

CB NO. 3A STA. 8+50.00, 20.00' RT. GRATE 626.19 E 12" NE 622.69

MH NO. 3 STA. 9+00.00, CL COVER 626.26 E 12" N 622.43 E 12" SW 622.15 E 12" E 618.71