

FOR TYPICAL SECTIONS SEE SHEET 6  
 FOR CROSS SECTIONS SEE SHEET 160-162  
 FOR SIGNING PLAN SEE SHEET 363-365  
 FOR PAVEMENT MARKING DETAILS SEE SHEET 352-353  
 FOR UNDERDRAIN QUANTITIES SEE SHEET 52-53  
 FOR CATCH BASIN DETAILS SEE SHEET 323  
 FOR DRIVEWAY DETAILS SEE SHEET 333-334  
 FOR DRIVEWAY PROFILES SEE SHEET 268-269  
 FOR STORM SEWER CONNECTION SCHEDULE SEE SHEET 68-70  
 FOR SANITARY SEWER CONNECTION SCHEDULE SEE SHEET 71-73  
 FOR I-1 INLET QUANTITIES SEE SHEET 82

ROADWAY			PIPE REMOVED (24\"/>
REF.	LOCATION	LF.	
R-1	STA. 47+13.00 TO STA. 47+34.00, 23' LT.	21	
R-2	STA. 47+94.00 TO STA. 48+19.00, 23' LT.	25	
R-3	STA. 48+05.00 TO STA. 48+32.00, 31' RT.	27	
R-4	STA. 48+71.00 TO STA. 49+00.00, 31' RT.	29	
R-5	STA. 48+95.00 TO STA. 49+15.00, 23' LT.	20	
R-6	STA. 49+28.00 TO STA. 49+48.00, 23' LT.	20	
R-7	STA. 49+42.00 TO STA. 49+69.00, 31' RT.	27	
R-8	STA. 49+94.00 TO STA. 50+16.00, 23' LT.	22	
<b>TOTALS</b>			<b>191</b>

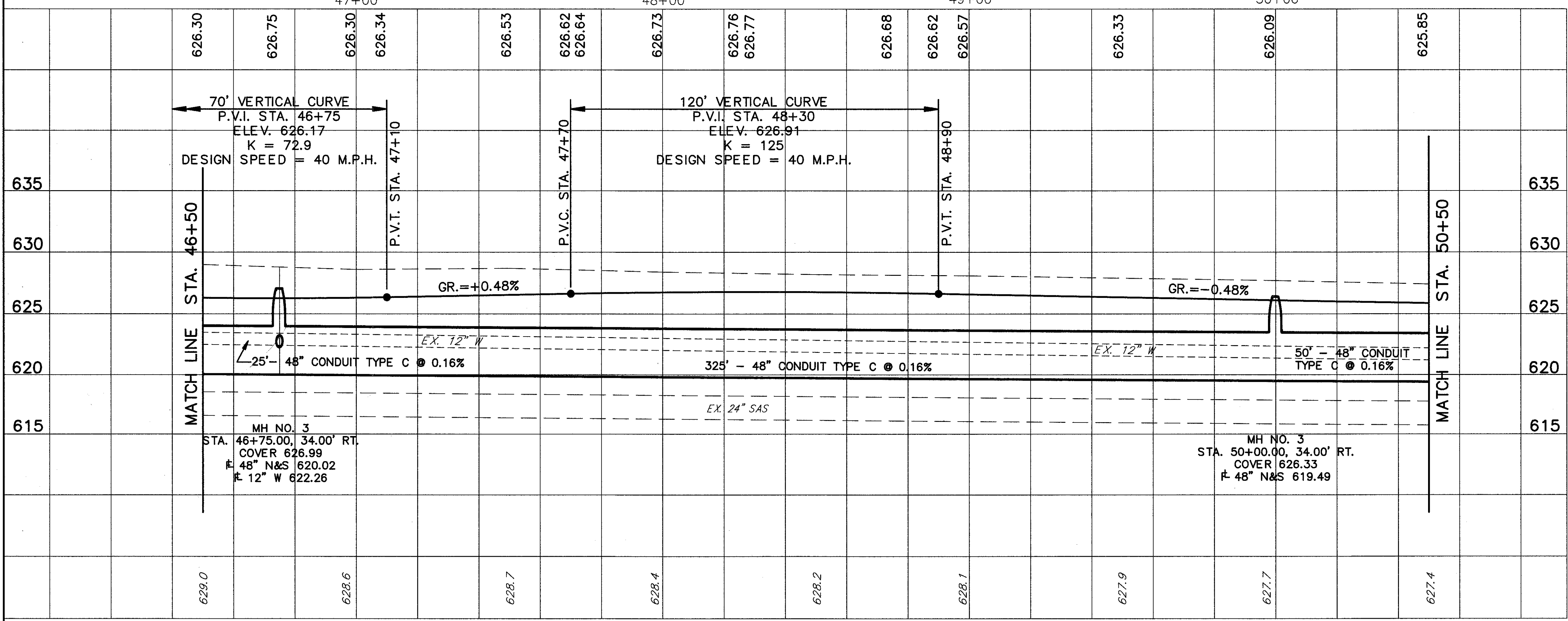

REF.	LOCATION	LF.	EA.	TOTALS
604	CATCH BASIN, NO. 3, AS PER PLAN		EA.	2
604	MANHOLE, NO. 3		EA.	2
603	48\"/>			
603	12\"/>			
603	12\"/>			
<b>TOTALS</b>				<b>400</b>

PLAN & PROFILE STA. 46+50 TO STA. 50+50