

SCALE: 1" = 40'

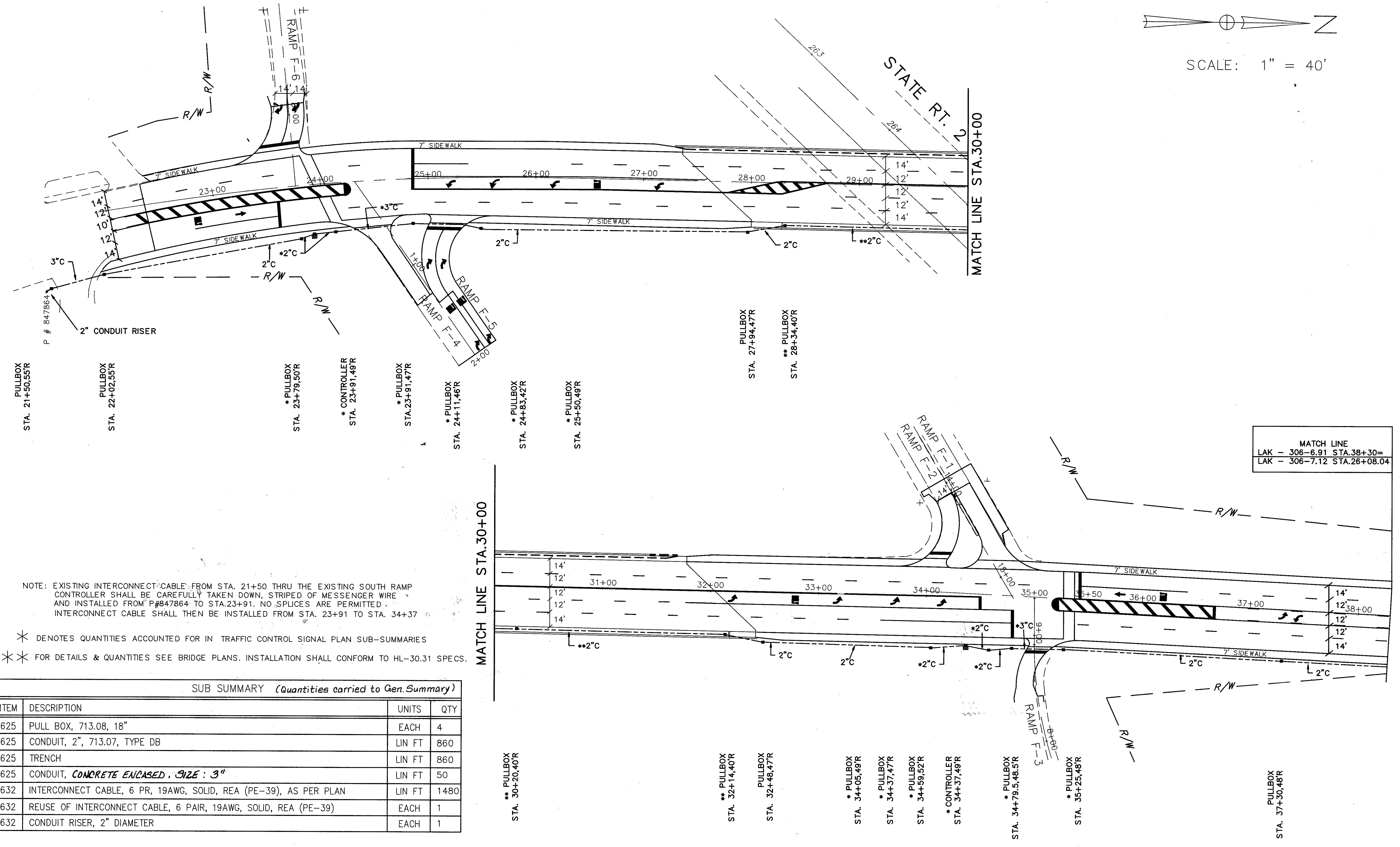

MATCH LINE  
LAK - 306-6.91 STA.38+30=  
LAK - 306-7.12 STA.26+08.04

NOTE: EXISTING INTERCONNECT CABLE FROM STA. 21+50 THRU THE EXISTING SOUTH RAMP CONTROLLER SHALL BE CAREFULLY TAKEN DOWN, STRIPED OF MESSENGER WIRE AND INSTALLED FROM P#847864 TO STA.23+91. NO SPLICES ARE PERMITTED. INTERCONNECT CABLE SHALL THEN BE INSTALLED FROM STA. 23+91 TO STA. 34+37.

- \* DENOTES QUANTITIES ACCOUNTED FOR IN TRAFFIC CONTROL SIGNAL PLAN SUB-SUMMARIES
- \*\* FOR DETAILS & QUANTITIES SEE BRIDGE PLANS. INSTALLATION SHALL CONFORM TO HL-30.31 SPECS.

SUB SUMMARY (Quantities carried to Gen. Summary)			
ITEM	DESCRIPTION	UNITS	QTY
625	PULL BOX, 713.08, 18"	EACH	4
625	CONDUIT, 2", 713.07, TYPE DB	LIN FT	860
625	TRENCH	LIN FT	860
625	CONDUIT, <b>CONCRETE ENCASED, SIZE: 3"</b>	LIN FT	50
632	INTERCONNECT CABLE, 6 PR, 19AWG, SOLID, REA (PE-39), AS PER PLAN	LIN FT	1480
632	REUSE OF INTERCONNECT CABLE, 6 PAIR, 19AWG, SOLID, REA (PE-39)	EACH	1
632	CONDUIT RISER, 2" DIAMETER	EACH	1