

MAINTENANCE OF TRAFFIC STATE ROUTE 306

BEGIN WORK
STA. 21+80.00

BEGIN PROJECT
STA. 22+35.88

BHM - 1A35(10)

LEGEND

- (1) - TEMPORARY CENTER LINES, CLASS I, 740.05, TYPE C
- (2) - TEMPORARY CHANNELIZING LINE, CLASS I, 740.05, TYPE C
- (3) - TEMPORARY EDGE LINE, CLASS I, 740.05, TYPE C, WHITE
- (5) - TEMPORARY STOP LINES, CLASS I, 740.05, TYPE C
- (6) - TEMPORARY LANE ARROWS, CLASS I, 740.05, TYPE C
- (7) - TEMPORARY WORD "ONLY", CLASS I, 740.05, TYPE C
- (8) - TEMPORARY TRANSVERSE LINES, CLASS I, 740.05, TYPE C, YELLOW
- (9) - TEMPORARY LANE LINES, CLASS I, 740.05, TYPE C
- (10) - TEMPORARY 4" DOTTED LINES, CLASS I, 740.05, TYPE C

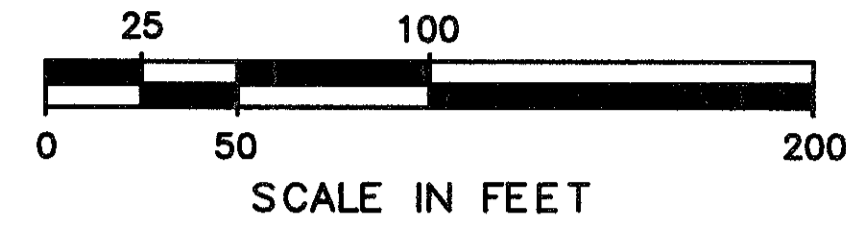

NOTE
* - 10' TAPER



END PROJECT
STA. 38+30.00

BHM - 1A35(10)

END WORK
STA. 36+87.00
LAK-306-7.12

PHASE 2

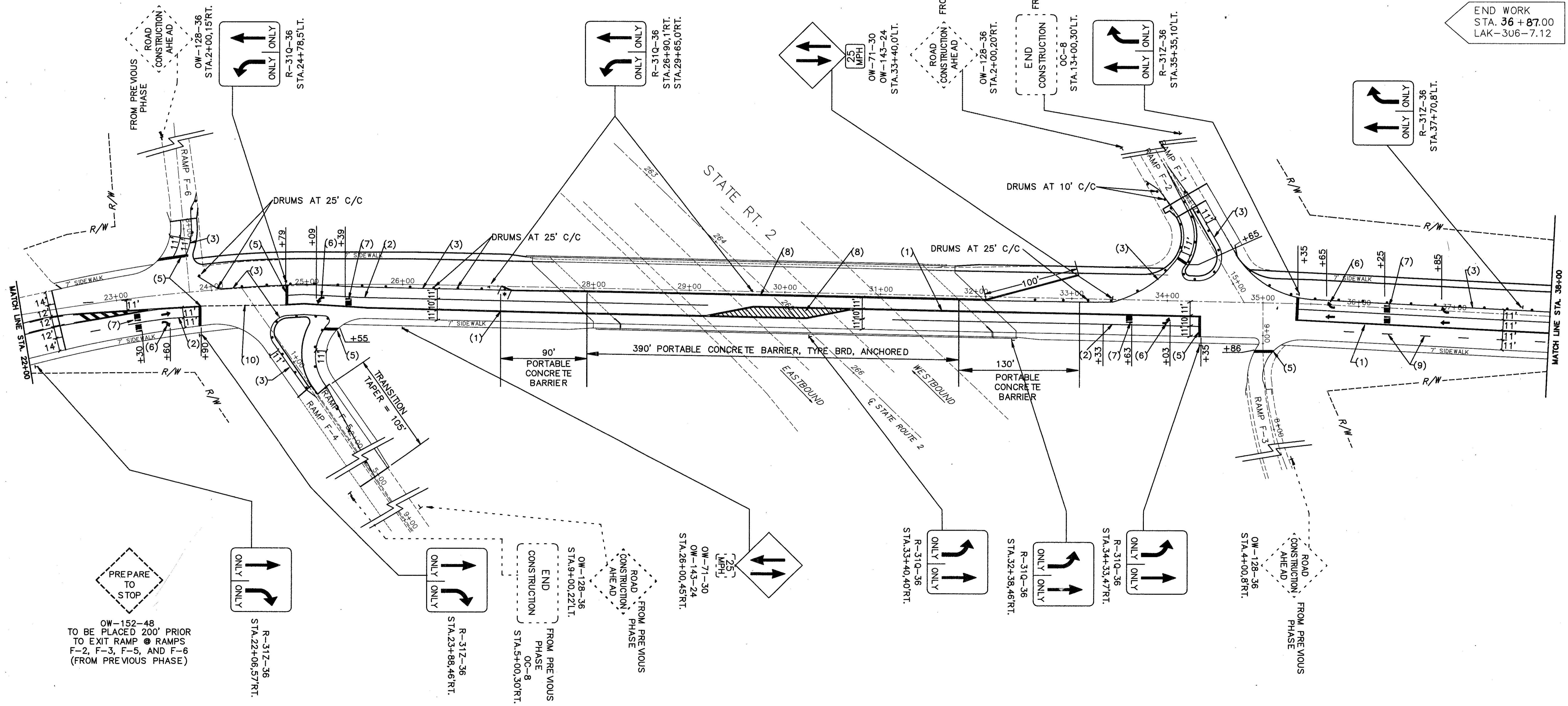

OW-152-48
TO BE PLACED 200' PRIOR
TO EXIT RAMP @ RAMP
F-2, F-3, F-5, AND F-6
(FROM PREVIOUS PHASE)